

Installation guide – Spare parts and accessories

Inspection kit | Code number 032F2326  
EVRA, size 25

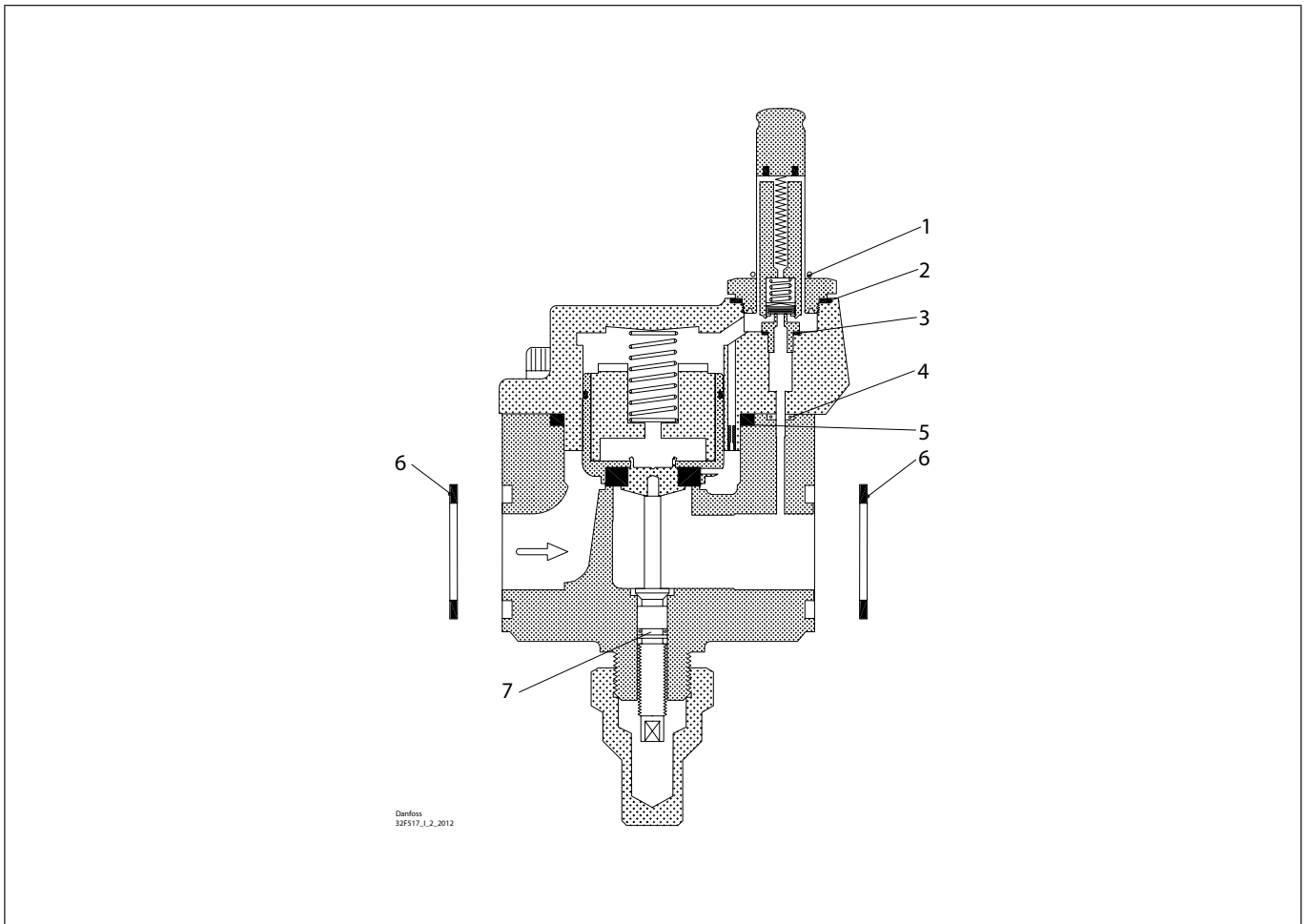

Danfoss  
32F517\_1.2\_2012

<p><b>1</b></p> <p>Total no. = 1</p>	<p><b>2</b></p> <p>Alu.</p> <p>Total no. = 1</p>	<p><b>3</b></p> <p>Alu.</p> <p>Total no. = 1</p>	<p><b>4</b></p> <p>Total no. = 1</p>	<p><b>5</b></p> <p>Rubber</p> <p>Total no. = 1</p>	<p><b>6</b></p> <p>Fibre</p> <p>Total no. = 2</p>
<p><b>7</b></p> <p>Total no. = 1</p>					