

# Instruction

## EVSI (EV220B)

### Normally Closed/ Normally open (NC/NO)

#### Types

Type EVSI (EV220B) 15, 20, 25, 32, 40, 50 B Normally Closed (NC)  
 Type EVSI (EV220B) 15, 20, 25, 32, 40, 50 B Normally Open (NO)  
 Type EVSI (EV220B) 15, 20, 25, 32, 40, 50 SS Normally Closed (NC)

#### Coils

Coils	Code no.	
	Junction Box	Conduit hub
24 V ac, 50 / 60 Hz	<b>018F7683</b>	<b>018F7693</b>
110 V ac, 50 / 60 Hz	<b>018F7682</b>	<b>018F7692</b>
120 V ac, 60 Hz		
208 - 240 V ac, 60 Hz	<b>018F7681</b>	<b>018F7691</b>
230 V ac, 50Hz		

Max. ambient temperature 122°F (50°C)

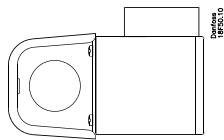

Junction box

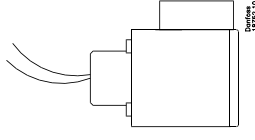

Conduit hub

#### Coil replacement

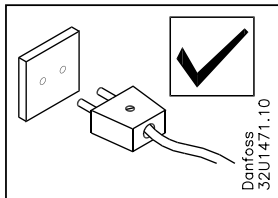

1. Before removing the coil, voltage must be disconnected, otherwise the coil will burn out

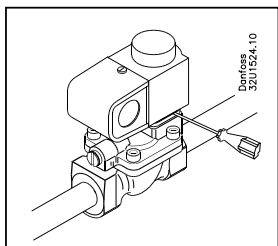

2. Use a screwdriver to lever the coil from the armature.

#### Media temperature

Gasket materials	Media	Temperature
EPDM	Water / Steam	-22°F → 248°F
FKM	Oil / inert gas incl air	32°F → 212°F

#### Mounting the valve

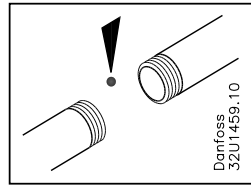

1. Clean the pipe system before mounting the valve

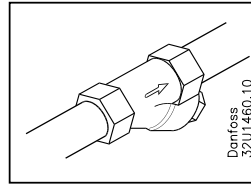

2. Mount filter in front of the valve if there are impurities in media

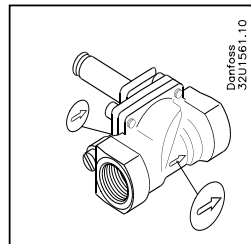

3. The arrow cast on the body and cover must point in the direction of the flow

4. Mount the valve as shown in the pictures. The valve can be mounted with a max. angle of 360° from upright position.

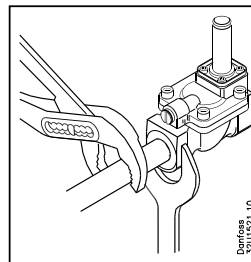
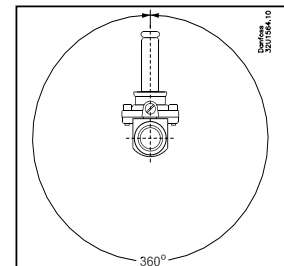
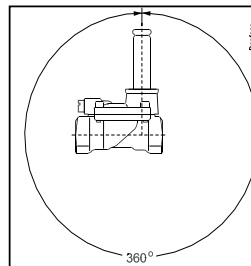

5. Use counterforce when tightening up pipe connections, i.e. use a spanner on both the valve body as well as on the pipe connector.

To be continued on page 2

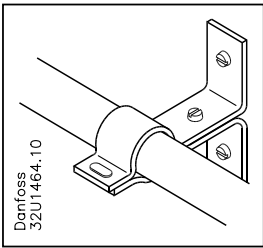

6. The pipes on both sides of the valve must be securely fastened.

**! Test pressure  
MAX. 290psi  
(20 bar)**

**Warning**

7. Test the system

### Mounting the coil

**Note 1. Warning**

Never switch on power to the coil when the coil is dismantled from the valve. Otherwise the coil may be damaged and there is risk of injuries and burns.

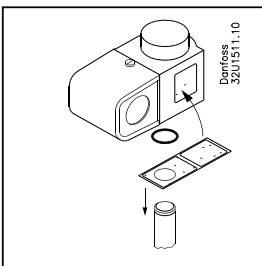

2. Mount the label on the coil and put the armature tube label over the tube.

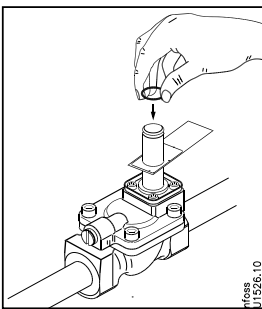

3. Mount the O-ring.

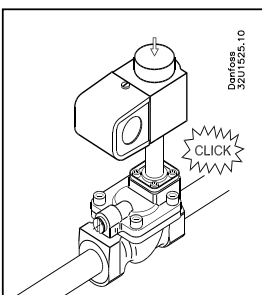

4. Mount the coil on the valve. The coil must **CLICK** in order to be positioned correctly.

### Safe working pressure

Types	Pressure
EVSI (EV220B) 15 and 20 (NC/NO)	232 psi (16 bar)
EVSI (EV220B) 25, 32, 40 and 50 (NC/NO)	181 psi (12.5 bar)

### Differential pressure

Min.	4 psi	0.3 bar
Max.	145psi	10 bar

### Spare parts kit

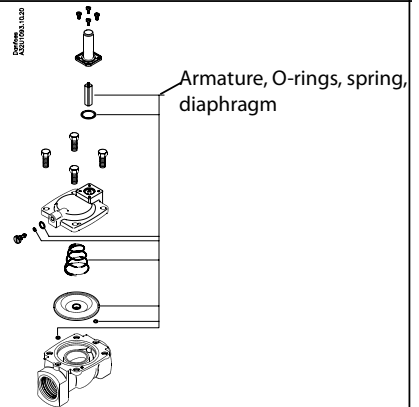

#### Brass versions

ValveType	Media	Code no.
EVSI (EV220B) 15	Water / Steam	<b>032U1071</b>
	Oil and inert gas incl. air	<b>032U1072</b>
EVSI (EV220B) 20	Water / Steam	<b>032U1073</b>
	Oil and inert gas incl. air	<b>032U1074</b>
EVSI (EV220B) 25	Water / Steam	<b>032U1075</b>
	Oil and inert gas incl. air	<b>032U1076</b>
EVSI (EV220B) 32	Water / Steam	<b>032U1077</b>
	Oil and inert gas incl. air	<b>032U1078</b>
EVSI (EV220B) 40	Water / Steam	<b>032U1079</b>
	Oil and inert gas incl. air	<b>032U1080</b>
EVSI (EV220B) 50	Water / Steam	<b>032U1081</b>
	Oil and inert gas incl. air	<b>032U1082</b>

#### Stainless Steel versions

ValveType	Media	Code no.
EVSI (EV220B) 15	Water / Steam	<b>032U6320</b>
	Oil and inert gas incl. air	<b>032U6326</b>
EVSI (EV220B) 20	Water / Steam	<b>032U6321</b>
	Oil and inert gas incl. air	<b>032U6327</b>
EVSI (EV220B) 25	Water / Steam	<b>032U6322</b>
	Oil and inert gas incl. air	<b>032U6328</b>
EVSI (EV220B) 32	Water / Steam	<b>032U6323</b>
	Oil and inert gas incl. air	<b>032U6329</b>
EVSI (EV220B) 40	Water / Steam	<b>032U6324</b>
	Oil and inert gas incl. air	<b>032U6330</b>
EVSI (EV220B) 50	Water / Steam	<b>032U6325</b>
	Oil and inert gas incl. air	<b>032U6331</b>

### Spare parts kit

Normally open valves (NO)

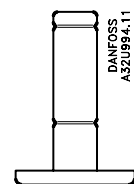

Media	Code no.
Water / Steam	<b>032U0296</b>
Oil and inert gas incl. air	<b>032U0295</b>