

## Contactors CI 6 - CI 30 Thermal overload relays TI 16C - TI 25C - TI 30C

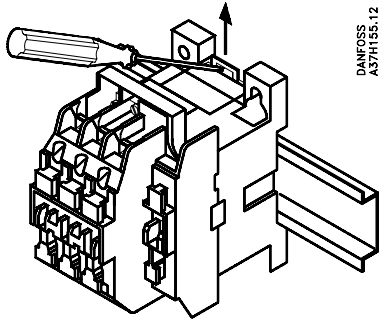

DANFOSS  
A37H15.12

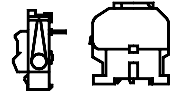
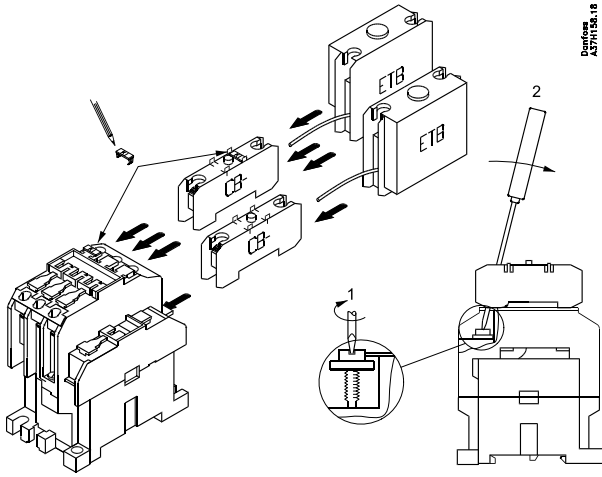

Danfoss  
A37H15.18

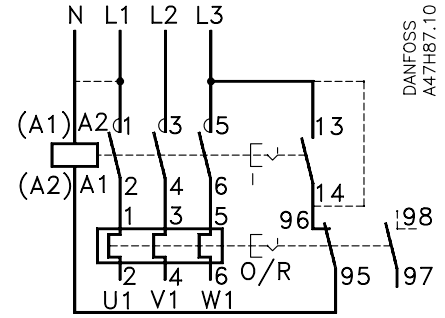
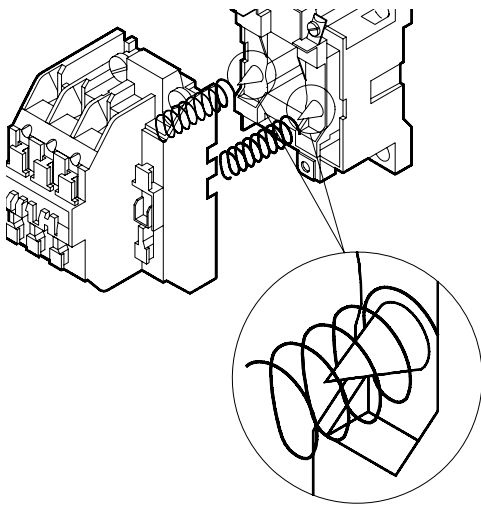

DANFOSS  
A47H01.10

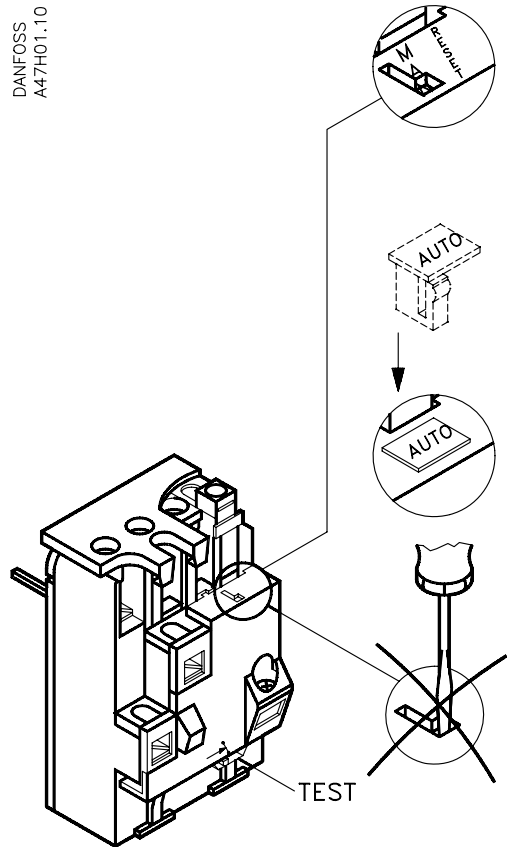

TI 16C/ TI 25C/ TI 30C



Conditional Short Circuit Rating - Suitable for use on circuits capable of delivering not more than 100 000 rms symmetrical amperes, 600 V maximum when protected by Class J fuses

## Contactors CI 32 - CI 50 Thermal overload relay TI 80

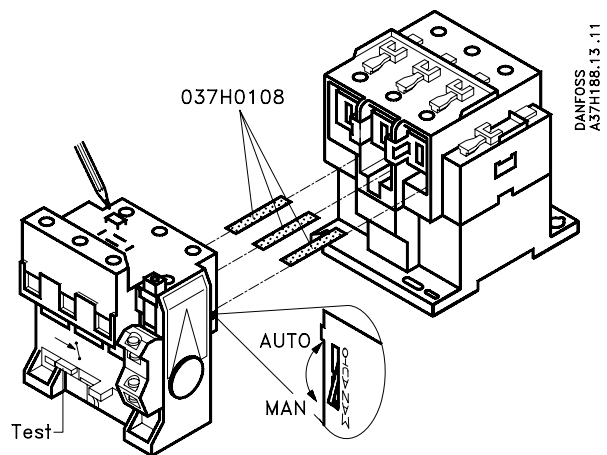
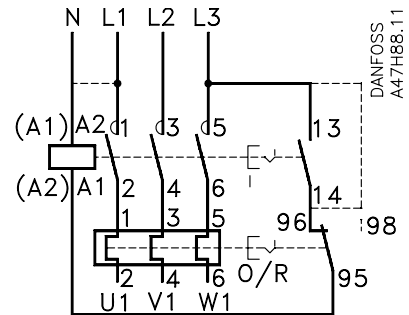
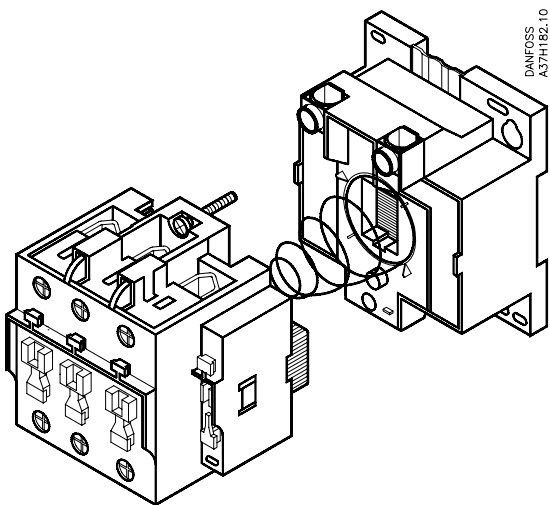
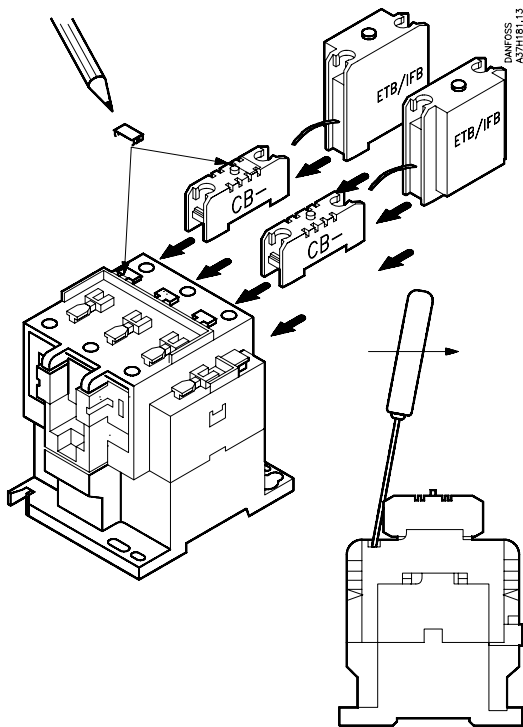
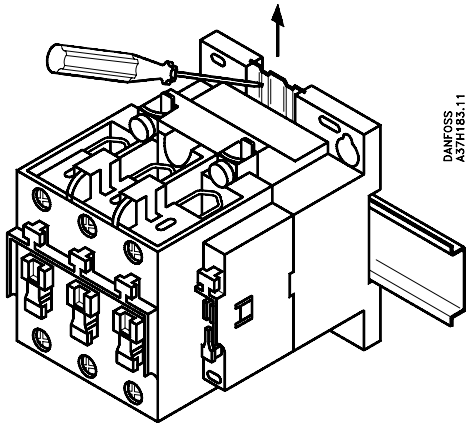
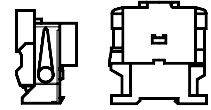

TI 80



Conditional Short Circuit Rating - Suitable for use on circuits capable of delivering not more than 100 000 rms symmetrical amperes, 600 V maximum when protected by Class J fuses