

ENGINEERING  
TOMORROW

*Danfoss*

XV Compressors - R600a

# 100mm high compressor **raises the bar for flexible cooling efficiency**

Secop's for Danfoss new XV compressors combine an very compact design with a very high COP while using natural refrigerant R600a. A cool combination for refrigerators.

**5-20L  
more  
storage volume  
in refrigerators**



## XV compressors

– tailored for light commercial refrigerators with R600a

Revolutionary X-Series compressor range is fundamentally new and relies on new compressor technology that Secop has developed in-house.

The new platform not only offers the highest system efficiency, but is also with its dimensions challenging the standards for compressor size in the future.

The innovative design from a production point of view is a pioneer which has all-welded parts that are assembled by the latest robotic automated systems, ensuring a trendsetting quality level.



### XV features

- eXtremely small
- eXtremely light
- eXtremely efficient
- eXtremely flexible

### Your benefits

- Additional storage volume for refrigerators
- Less weight, easier handling, lower transport costs
- Lower running costs
- Adaptable capacity for various applications

## Technical data

General (code numbers)		XV5.0KX	XV7.2KX	XV8.0KX		
Compressor		108H5012	108H7210	108H7710		
Electronic unit (attached) - XV-AEO/Freq. Inputs: Thermostat, frequency signal, Modbus		105N5020	105N5020	105N5020		
Electronic unit (detached) - XV-Frequency Input: Frequency signal		105N5050	105N5050	105N5050		
Approvals		EN 60335-2-34 with Annex AA (VDE), GB 4706.17 (CCC/CQC)				
Application						
Application and evaporating temperature		LBP -35 to 0 (-5/-10)°C				
Voltage / Frequency		V/Hz 160 - 264 / 50/60	160 - 264 / 50/60	160 - 264 / 50/60		
Speed range		rpm	1000 - 4000			
Performance data (ASHRAE • 220 V, 50/60 Hz • static cooling) @ 1600   4000 rpm						
Evaporating temperature		°C	-23.3	-23.3	-23.3	
Cooling capacity		W	40   98	68   158	73   166	
Power consumption		W	22   59	36   93	37   93	
COP		W/W	1.83   1.65	1.89   1.69	1.98   1.79	
Performance data (EN 12900 Household/CECOMAF • 220 V, 50/60 Hz • static cooling) @ 1600   4000 rpm						
Evaporating temperature		°C	-25	-25	-25	
Cooling capacity		W	29   72	51   118	54   123	
Power consumption		W	21   56	34   89	35   87	
COP		W/W	1.41   1.28	1.50   1.33	1.57   1.41	
Dimensions and technical characteristics						
Height		mm	A	97	97	97
			B	91	91	91
Weight				4.8	4.8	4.8
Displacement				5.0	7.2	7.7
Motor type				Permanent magnet		

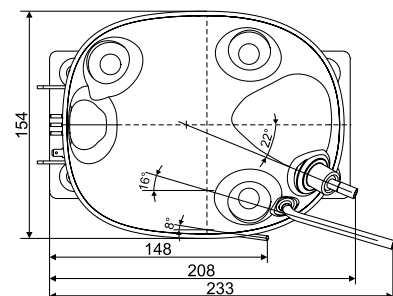
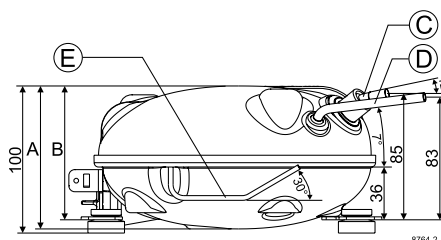
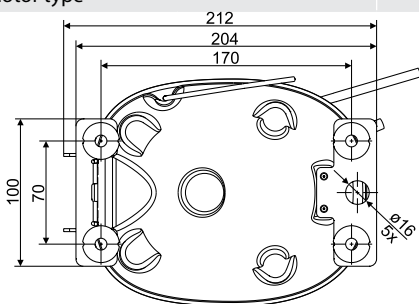

Contact your local Danfoss sales office today to learn more about how you can reach the best standards

Danfoss can accept no responsibility for possible errors in catalogues, brochures and other printed material. Danfoss reserves the right to alter its products without notice. This also applies to products already on order provided that such alterations can be made without consequential changes being necessary in specifications already agreed. All trademarks in this material are property of the respective companies. Danfoss and the Danfoss logotype are trademarks of Danfoss A/S. All rights reserved