

NF9.5FK

Standard Compressor

R134a

115-127V 60Hz

Data Sheet (Replaces CG.43.W2.22)

General

Compressor		NF9.5FK
Connector-material	Sealing	Code number
Copper-plated steel	Aluminium caps	105G5937
Copper-plated steel	Rubber plugs	105G5929
Copper	Rubber plugs	

Application

Application		LBP/MBP
Evaporating temperature range	°F (°C)	-31 to 45 (-35 to 7.2)
Voltage range	V/Hz	95 - 135 / 60
Motor type		RSIR/CSIR*
Max. ambient temperature	°F (°C)	110 (43)
Comp. cooling at max. ambient temperature	100°F (38°C) 110°F (43°C)	F ₂ F ₂

*In capillary tube systems where non-equalized pressures may occur at compressor start, or in areas with short power supply drop-outs, a starting capacitor can be used for ensuring a successful start (CSIR).

Design

Displacement	cu.in. (cm ³)	0.57 (9.40)
Oil quantity	fl.oz. (cm ³)	10.8 (320)
Maximum refrigerant charge	oz. (g)	14.0 (400)
Free gas vol. in compressor housing	fl.oz. (cm ³)	79.7 (2360)
Weight without electrical equipment	lbs. (kg)	23.0 (10.5)

Motor

Motor size	watt	360
LRA (rated after 4 sec.UL984) LST	A	35.5
Cut-in current LST	A	35.5
Resistance, main and start winding (77°F)	Ω	1.4/7.6
Approvals		UL984/CSA-C22.2

Dimensions

		105G5929	105G5937
Height	in. (mm)	A	8.00 (203)
		B	7.76 (197)
Suction connector	location/I.D. in. (mm)	C	0.320-0.327 (8.2±0.09) 0.242-0.249 (6.2±0.09)
Process connector	location/I.D. in. (mm)	D	0.252-0.259 (6.5±0.09) 0.242-0.249 (6.2±0.09)
Discharge connector	location/I.D. in. (mm)	E	0.252-0.259 (6.5±0.09) 0.202-0.205 (5.0±0.12/0.20)
Compressors on a pallet	pcs.	80	

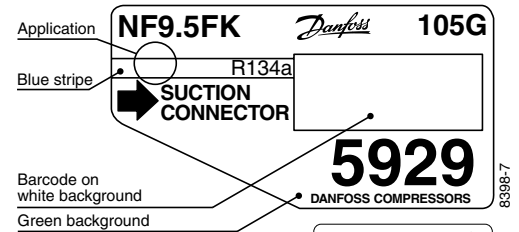

- S = Static cooling normally sufficient
- O = Oil cooling
- F₁ = Fan cooling 1.5 m/s (compressor compartment temp. equal to ambient temperature)
- F₂ = Fan cooling 3.0 m/s necessary

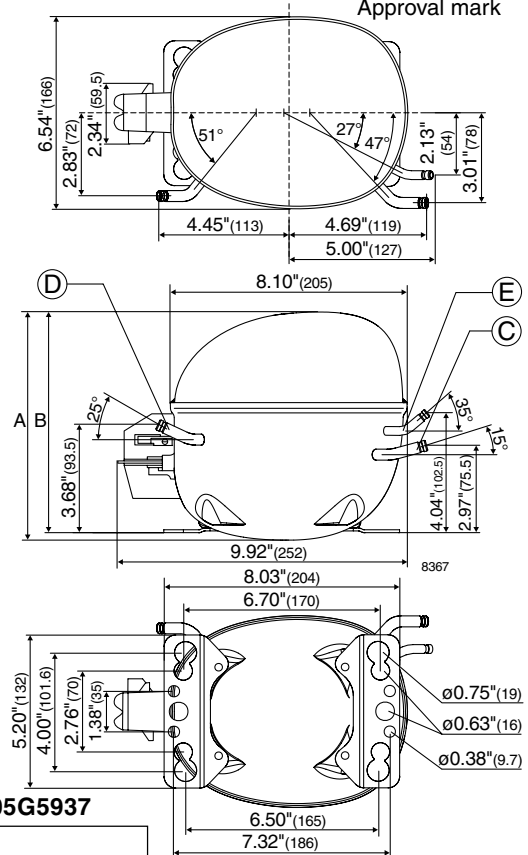

Capacity at LBP conditions (ASHRAE)

	-30	-20	-13	-10	0	10	20	30	40	45
Comp. °F	-30	-20	-13	-10	0	10	20	30	40	45
Comp. °C	-34.4	-28.9	-25	-23.3	-17.8	-12.2	-6.7	-1.1	4.4	7.2
NF9.5FK	533	750	935	1024	1366	1787	2298	2909	3633	4041

Capacity at MBP conditions (ASHRAE)

	-30	-20	-13	-10	0	10	20	30	40	45
Comp. °F	-30	-20	-13	-10	0	10	20	30	40	45
Comp. °C	-34.4	-28.9	-25	-23.3	-17.8	-12.2	-6.7	-1.1	4.4	7.2
NF9.5FK	474	667	831	910	1214	1587	2039	2580	3220	3580

Capacity (EN 12900/CECOMAF)

	-34.4	-28.9	-25	-23.3	-17.8	-12.2	-6.7	-1.1	4.4	7.2
Comp. °C	-34.4	-28.9	-25	-23.3	-17.8	-12.2	-6.7	-1.1	4.4	7.2
Comp. °F	-30	-20	-13	-10	0	10	20	30	40	45
NF9.5FK	126	178	222	243	324	424	544	689	859	955

Power consumption

	-30	-20	-13	-10	0	10	20	30	40	45
Comp. °F	-30	-20	-13	-10	0	10	20	30	40	45
Comp. °C	-34.4	-28.9	-25	-23.3	-17.8	-12.2	-6.7	-1.1	4.4	7.2
NF9.5FK	192	228	253	264	301	338	379	422	470	496

Current consumption

	-30	-20	-13	-10	0	10	20	30	40	45
Comp. °F	-30	-20	-13	-10	0	10	20	30	40	45
Comp. °C	-34.4	-28.9	-25	-23.3	-17.8	-12.2	-6.7	-1.1	4.4	7.2
NF9.5FK	3.45	3.59	3.70	3.76	3.95	4.16	4.40	4.67	4.96	5.11

EER at LBP conditions (ASHRAE)

	-30	-20	-13	-10	0	10	20	30	40	45
Comp. °F	-30	-20	-13	-10	0	10	20	30	40	45
Comp. °C	-34.4	-28.9	-25	-23.3	-17.8	-12.2	-6.7	-1.1	4.4	7.2
NF9.5FK	2.77	3.28	3.69	3.88	4.55	5.28	6.07	6.89	7.73	8.15

EER at MBP conditions (ASHRAE)

	-30	-20	-13	-10	0	10	20	30	40	45
Comp. °F	-30	-20	-13	-10	0	10	20	30	40	45
Comp. °C	-34.4	-28.9	-25	-23.3	-17.8	-12.2	-6.7	-1.1	4.4	7.2
NF9.5FK	2.47	2.92	3.28	3.45	4.04	4.69	5.39	6.11	6.85	7.22

COP (EN 12900/CECOMAF)

	-34.4	-28.9	-25	-23.3	-17.8	-12.2	-6.7	-1.1	4.4	7.2
Comp. °C	-34.4	-28.9	-25	-23.3	-17.8	-12.2	-6.7	-1.1	4.4	7.2
Comp. °F	-30	-20	-13	-10	0	10	20	30	40	45
NF9.5FK	0.66	0.78	0.88	0.92	1.08	1.25	1.43	1.63	1.82	1.92

Accessories

Devices	Fig.	NF9.5FK
Starting relay (protector incl.)	a2	117U4141
Protector 3/4" Texas Instruments	(pos.1)	MRT26AFZ-6
Starting relay (protector incl.)	a2	117U4142*
Starting capacitor 410 µF	c	117U5028*
Protector 3/4" Texas Instruments	(pos.2)	MRT26AFZ-6
Cover	b	117U1021
Cord relief	d	117U0317
Cord relief capacitor	dc	117U0349
Mounting accessories (105G5929)	Ø in. (mm)	
Bolt joint for one compressor	5/8 (16)	118-1946
Bolt joint for one compressor	3/4 (19)	118-1949
Snap-on for one compressor	5/8 (16)	118-1947
Mounting accessories (105G5937)	Ø in. (mm)	
Bolt joint for one compressor	5/8 (16)	118-1917
Bolt joint in quantities	5/8 (16)	118-1918
Snap-on in quantities	5/8 (16)	118-1919

Test conditions

1. Condensing temperature
 2. Ambient & suction gas temp.
 3. Liquid temperature
- Fan cooling F₂, 115V 60Hz

ASHRAE

1. LBP 130°F (54,4°C)
 2. 90°F (32°C)
 3. 90°F (32°C)
1. MBP 130°F (54,4 °C)
 2. 95°F (35°C)
 3. 115°F (46°C)

EN 12900/CECOMAF

1. 55°C (131°F)
2. 32°C (90°F)
3. 55°C (131°F)

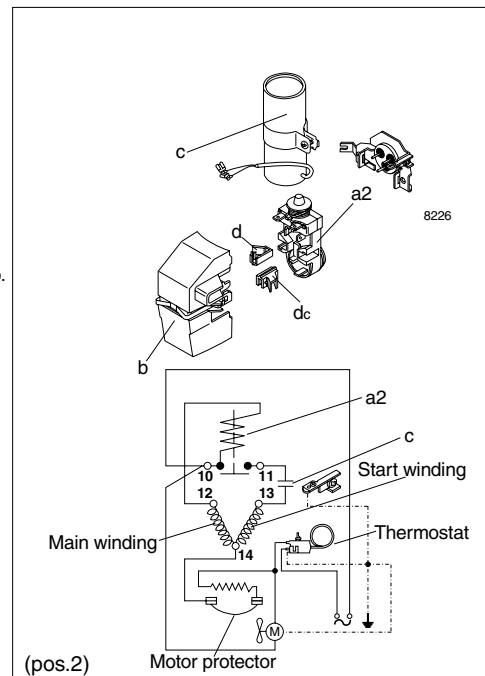
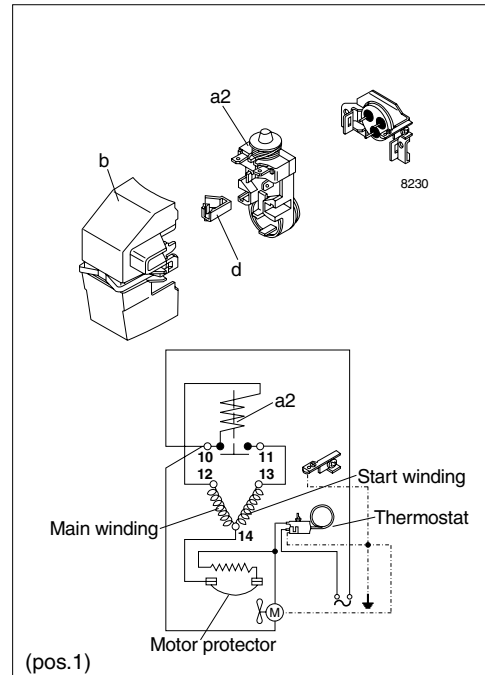

*In capillary tube systems where non-equalized pressures may occur at compressor start, or in areas with short power supply drop-outs, a starting capacitor can be used for ensuring a successful start (CSIR).