

NLX10KK

High Energy-optimized Compressor

R600a

220-240V 50Hz

Data Sheet (Replaces CG.53.F1.02)

General

Compressor	NLX10KK
Code number	105H6871

Application

Application		LBP
Evaporating temperature range	°C	-35 to -10
Voltage range	V/Hz	198 - 254 /50
Motor type		RSCR*
Max. ambient temperature	°C	43
Comp. cooling at ambient temp.	32°C	S
	38°C	S
	43°C	S

* run capacitor 4 µF compulsory

Design

Displacement	cm ³	10.09
Oil quantity	cm ³	270
Maximum refrigerant charge	g	150
Free gas vol. in compressor	cm ³	2310
Weight without electrical equipment	kg	10.7

Motor

Motor size	watt	118
LRA (rated after 4 sec. UL984) LST	A	3.4
Cut-in current LST	A	7.5
Resistance, main and start winding (25°C)	Ω	18.1/17.3
Approvals		EN 60335-2-34 with Annex AA

Dimensions

Height	mm	A	203
		B	197
Suction connector	location/I.D. mm	C	6.2 ±0.09
Process connector	location/I.D. mm	D	6.2 ±0.09
Discharge connector	location/I.D. mm	E	5.0 +0.12/+0.20
Compressors on a pallet	pcs.		80

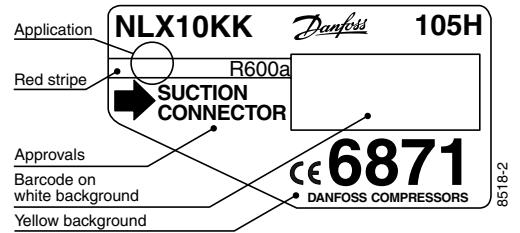

- S = Static cooling normally sufficient
- O = Oil cooling
- F₁ = Fan cooling 1.5 m/s
(compressor compartment temperature equal to ambient temperature)
- F₂ = Fan cooling 3.0 m/s necessary

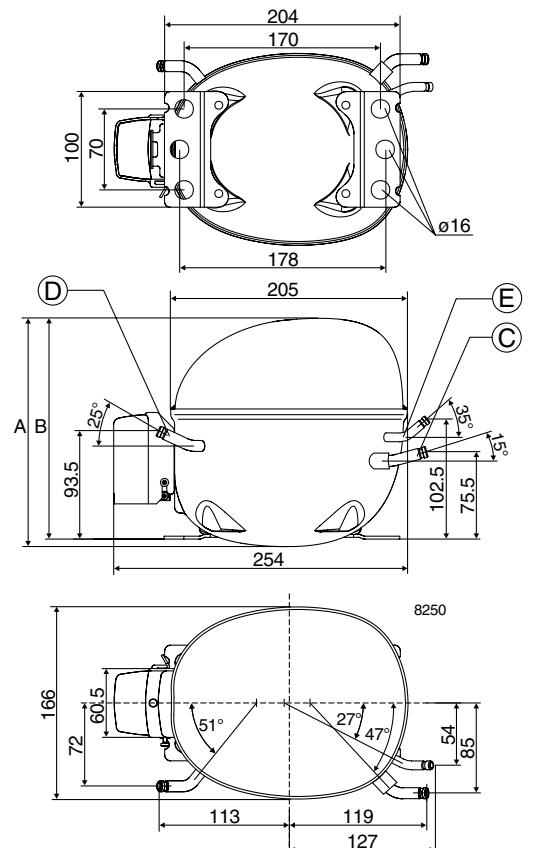

Capacity (EN 12900/CECOMAF)
watt

Comp.\°C	-35	-30	-25	-23.3	-20	-15	-10
NLX10KK	73.8	99.5	131	143	169	215	269

Capacity (ASHRAE)
watt

Comp.\°C	-35	-30	-25	-23.3	-20	-15	-10
NLX10KK	89.7	121	159	174	206	261	327

Power consumption
watt

Comp.\°C	-35	-30	-25	-23.3	-20	-15	-10
NLX10KK	71.0	83.4	96.5	101	110	124	138

Current consumption
A

Comp.\°C	-35	-30	-25	-23.3	-20	-15	-10
NLX10KK	0.32	0.38	0.45	0.47	0.51	0.57	0.64

COP (EN 12900/CECOMAF)
W/W

Comp.\°C	-35	-30	-25	-23.3	-20	-15	-10
NLX10KK	1.04	1.19	1.36	1.42	1.54	1.73	1.94

COP (ASHRAE)
W/W

Comp.\°C	-35	-30	-25	-23.3	-20	-15	-10
NLX10KK	1.26	1.45	1.65	1.72	1.87	2.11	2.37

Test conditions EN 12900/CECOMAF ASHRAE
 Condensing temperature 55°C 55°C
 Ambient and suction gas temp. 32°C 32°C
 Liquid temperature 55°C 32°C
 Static cooling, with RC 4 µF, 220V 50Hz,
 PTC consumption included (two watt power consumption to be subtracted,
 when ePTC is used; this is also affecting the COP)

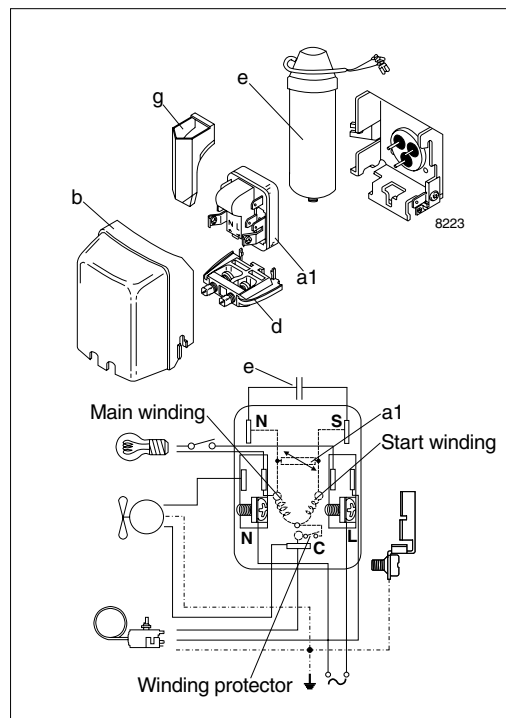
Accessories

Devices	Fig.	NLX10KK
PTC starting device 6.3 mm spades 4.8 mm spades	a1	103N0016
		103N0021
ePTC starting device 4.8 mm spades		103N0050
Cover	b	103N2010
Cord relief	d	103N1010
Run capacitor 4 µF (compulsory) 6.3 mm spades 4.8 mm spades	e	117-7117
		117-7119
Protection screen for PTC	g	103N0476
Mounting accessories		
Bolt joint for one compressor		118-1917
Bolt joint in quantities		118-1918
Snap-on in quantities		118-1919