

Capacity (EN 12900/CECOMAF)

watt

Comp.\°C	-35	-30	-25	-23.3	-20	-15	-10
NLX11KK	84.0	112	147	161	189	240	300

Capacity (ASHRAE)

watt

Comp.\°C	-35	-30	-25	-23.3	-20	-15	-10
NLX11KK	102	137	179	195	230	292	365

Power consumption

watt

Comp.\°C	-35	-30	-25	-23.3	-20	-15	-10
NLX11KK	80.6	94.2	108	113	123	138	156

Current consumption

A

Comp.\°C	-35	-30	-25	-23.3	-20	-15	-10
NLX11KK	0.38	0.44	0.51	0.53	0.58	0.66	0.74

COP (EN 12900/CECOMAF)

W/W

Comp.\°C	-35	-30	-25	-23.3	-20	-15	-10
NLX11KK	1.04	1.19	1.36	1.42	1.55	1.73	1.92

COP (ASHRAE)

W/W

Comp.\°C	-35	-30	-25	-23.3	-20	-15	-10
NLX11KK	1.27	1.45	1.66	1.73	1.88	2.11	2.34

Test conditions EN 12900/CECOMAF ASHRAE
 Condensing temperature 55°C 55°C
 Ambient and suction gas temp. 32°C 32°C
 Liquid temperature 55°C 32°C
 Static cooling, with RC 4 µF, 220V 50Hz,
 PTC consumption included (two watt power consumption to be subtracted,
 when ePTC is used; this is also affecting the COP)

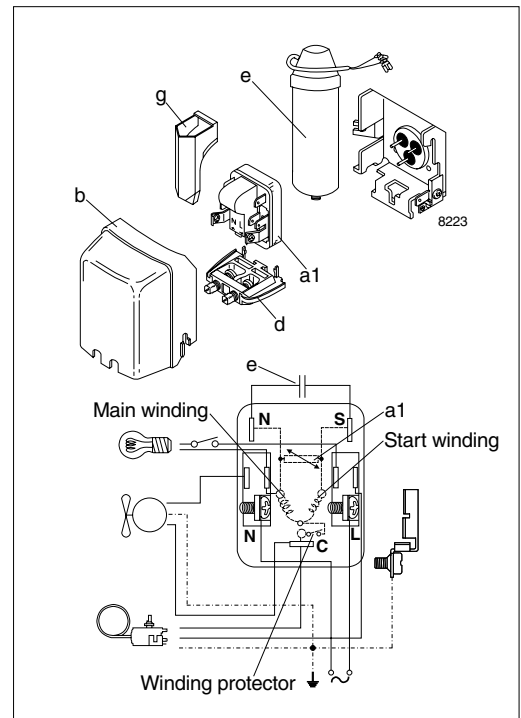

Accessories

Devices	Fig.	NLX11KK
PTC starting device 6.3 mm spades 4.8 mm spades	a1	103N0016
		103N0021
ePTC starting device 4.8 mm spades		103N0050
Cover	b	103N2010
Cord relief	d	103N1010
Run capacitor 4 µF (compulsory) 6.3 mm spades 4.8 mm spades	e	117-7117
		117-7119
Protection screen for PTC	g	103N0476
Mounting accessories		
Bolt joint for one compressor		118-1917
Bolt joint in quantities		118-1918
Snap-on in quantities		118-1919