

NLX13KK

High Energy-optimized Compressor

R600a

220-240V 50Hz

Data Sheet (Replaces CG.53.H1.02)

General

Compressor	NLX13KK
Code number	105H6983
Code number	105H6978*)

*) Performance data established on 8.2 mm suction line. Restrictions due to 6.2 mm suction line can affect system performance.

Application

Application	LBP	
Evaporating temperature range	°C	-35 to -10
Voltage range	V/Hz	198 - 254 /50
Motor type	RSCR*	
Max. ambient temperature	°C	43
Comp. cooling at ambient temp.	32°C	S
	38°C	S
	43°C	S

* run capacitor 4 µF compulsory

Design

Displacement	cm ³	13.25
Oil quantity	cm ³	270
Maximum refrigerant charge	g	150
Free gas vol. in compressor	cm ³	2310
Weight without electrical equipment	kg	10.8

Motor

Motor size	watt	143
LRA (rated after 4 sec. UL984) LST	A	4.4
Cut-in current LST	A	8.3
Resistance, main and start winding (25°C)	Ω	14.6/19.3
Approvals	EN 60335-2-34 with Annex AA	

Dimensions

		105H6983		105H6978	
Height	mm	A	203		
		B	197		
Suction connector	location/I.D. mm	C	8.2 ±0.09	6.2 ±0.09	
Process connector	location/I.D. mm	D	6.2 ±0.09	6.2 ±0.09	
Discharge connector	location/I.D. mm	E	6.2 ±0.09	5.0 +0.12/+0.20	
Compressors on a pallet	pcs.	80			

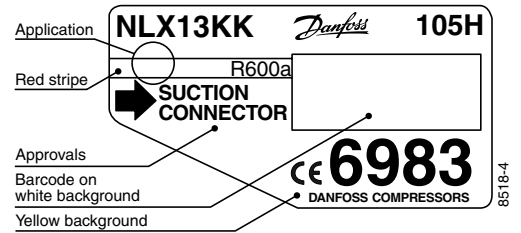

- S = Static cooling normally sufficient
- O = Oil cooling
- F₁ = Fan cooling 1.5 m/s (compressor compartment temperature equal to ambient temperature)
- F₂ = Fan cooling 3.0 m/s necessary

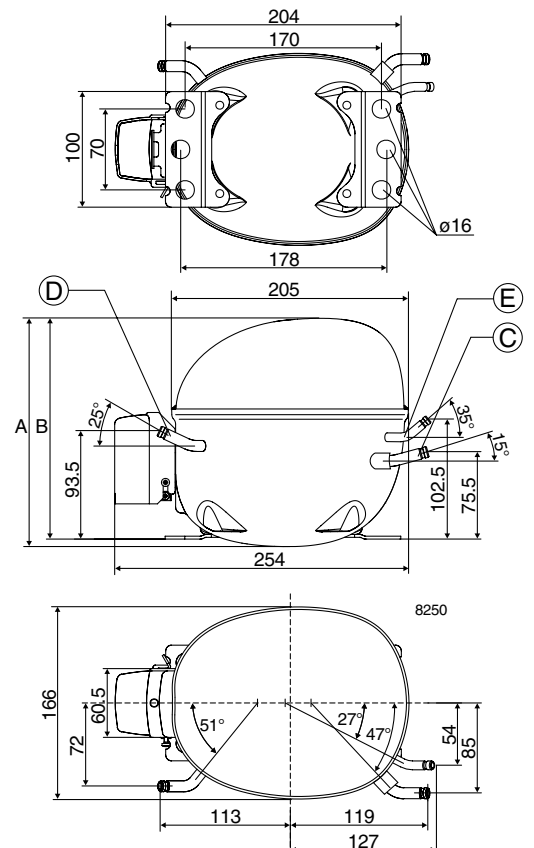

Capacity (EN 12900/CECOMAF)
watt

Comp.\°C	-35	-30	-25	-23.3	-20	-15	-10
NLX13KK	97.8	133	174	190	223	282	350

Capacity (ASHRAE)
watt

Comp.\°C	-35	-30	-25	-23.3	-20	-15	-10
NLX13KK	119	161	212	231	272	343	427

Power consumption
watt

Comp.\°C	-35	-30	-25	-23.3	-20	-15	-10
NLX13KK	91.6	110	128	134	146	166	187

Current consumption
A

Comp.\°C	-35	-30	-25	-23.3	-20	-15	-10
NLX13KK	0.48	0.54	0.61	0.63	0.69	0.78	0.89

COP (EN 12900/CECOMAF)
W/W

Comp.\°C	-35	-30	-25	-23.3	-20	-15	-10
NLX13KK	1.07	1.21	1.36	1.41	1.53	1.70	1.87

COP (ASHRAE)
W/W

Comp.\°C	-35	-30	-25	-23.3	-20	-15	-10
NLX13KK	1.30	1.47	1.65	1.72	1.86	2.07	2.28

Test conditions EN 12900/CECOMAF ASHRAE
 Condensing temperature 55°C 55°C
 Ambient and suction gas temp. 32°C 32°C
 Liquid temperature 55°C 32°C
 Static cooling, with RC 4 µF, 220V 50Hz,
 PTC consumption included (two watt power consumption to be subtracted,
 when ePTC is used; this is also affecting the COP)

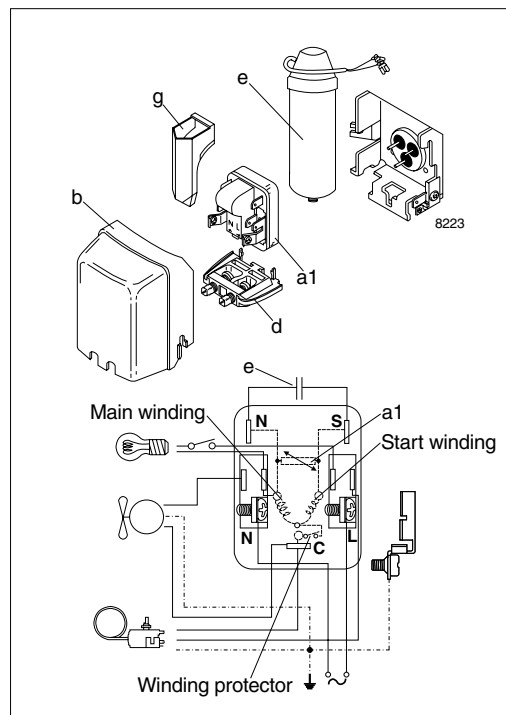
Accessories

Devices	Fig.	NLX13KK
PTC starting device 6.3 mm spades 4.8 mm spades	a1	103N0016
		103N0021
ePTC starting device 4.8 mm spades		103N0050
Cover	b	103N2010
Cord relief	d	103N1010
Run capacitor 4 µF (compulsory) 6.3 mm spades 4.8 mm spades	e	117-7117
		117-7119
Protection screen for PTC	g	103N0476
Mounting accessories		
Bolt joint for one compressor		118-1917
Bolt joint in quantities		118-1918
Snap-on in quantities		118-1919