

# NLX8.8KK

## High Energy-optimized Compressor

### R600a

### 220-240V 50Hz

Data Sheet (Replaces CG.53.E1.02)

#### General

Compressor	<b>NLX8.8KK</b>
Code number	105H6874

#### Application

Application		LBP
Evaporating temperature range	°C	-35 to -10
Voltage range	V/Hz	198 - 254 /50
Motor type		RSCR*
Max. ambient temperature	°C	43
Comp. cooling at ambient temp.	32°C	S
	38°C	S
	43°C	S

\* run capacitor 4 µF compulsory

#### Design

Displacement	cm <sup>3</sup>	8.76
Oil quantity	cm <sup>3</sup>	270
Maximum refrigerant charge	g	150
Free gas vol. in compressor	cm <sup>3</sup>	2360
Weight without electrical equipment	kg	10.7

#### Motor

Motor size	watt	100
LRA (rated after 4 sec. UL984) LST	A	2.8
Cut-in current LST	A	6.5
Resistance, main and start winding (25°C)	Ω	21.6/21.2
Approvals		EN 60335-2-34 with Annex AA

#### Dimensions

Height	mm	A	203
		B	197
Suction connector	location/I.D. mm	C	6.2 ±0.09
Process connector	location/I.D. mm	D	6.2 ±0.09
Discharge connector	location/I.D. mm	E	5.0 +0.12/+0.20
Compressors on a pallet	pcs.		80

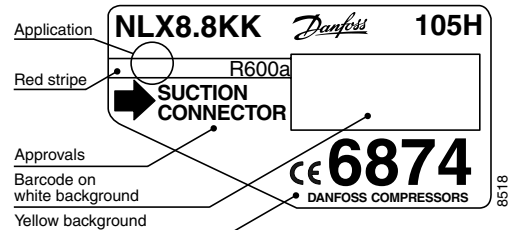

- S = Static cooling normally sufficient
- O = Oil cooling
- F<sub>1</sub> = Fan cooling 1.5 m/s  
(compressor compartment temperature equal to ambient temperature)
- F<sub>2</sub> = Fan cooling 3.0 m/s necessary

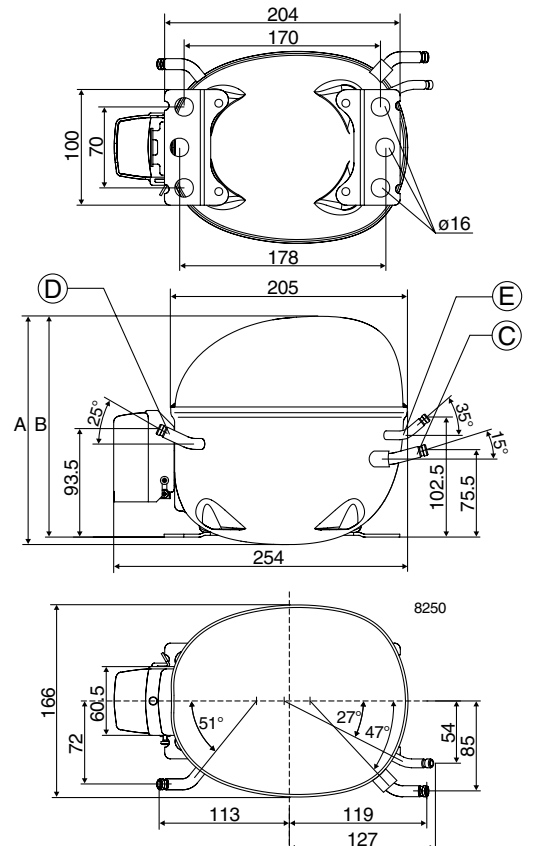
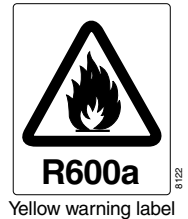

**Capacity (EN 12900/CECOMAF)**
**watt**

Comp.\°C	-35	-30	-25	-23.3	-20	-15	-10
NLX8.8KK	59.9	83.4	111	121	144	182	227

**Capacity (ASHRAE)**
**watt**

Comp.\°C	-35	-30	-25	-23.3	-20	-15	-10
NLX8.8KK	72.8	101	135	148	175	221	276

**Power consumption**
**watt**

Comp.\°C	-35	-30	-25	-23.3	-20	-15	-10
NLX8.8KK	59.2	71.3	82.5	86.1	93.2	104	115

**Current consumption**
**A**

Comp.\°C	-35	-30	-25	-23.3	-20	-15	-10
NLX8.8KK	0.28	0.33	0.38	0.40	0.44	0.49	0.55

**COP (EN 12900/CECOMAF)**
**W/W**

Comp.\°C	-35	-30	-25	-23.3	-20	-15	-10
NLX8.8KK	1.01	1.17	1.35	1.41	1.54	1.75	1.97

**COP (ASHRAE)**
**W/W**

Comp.\°C	-35	-30	-25	-23.3	-20	-15	-10
NLX8.8KK	1.23	1.42	1.64	1.72	1.87	2.13	2.40

Test conditions EN 12900/CECOMAF ASHRAE  
 Condensing temperature 55°C 55°C  
 Ambient and suction gas temp. 32°C 32°C  
 Liquid temperature 55°C 32°C  
 Static cooling, with RC 4 µF, 220V 50Hz,  
 PTC consumption included (two watt power consumption to be subtracted,  
 when ePTC is used; this is also affecting the COP)

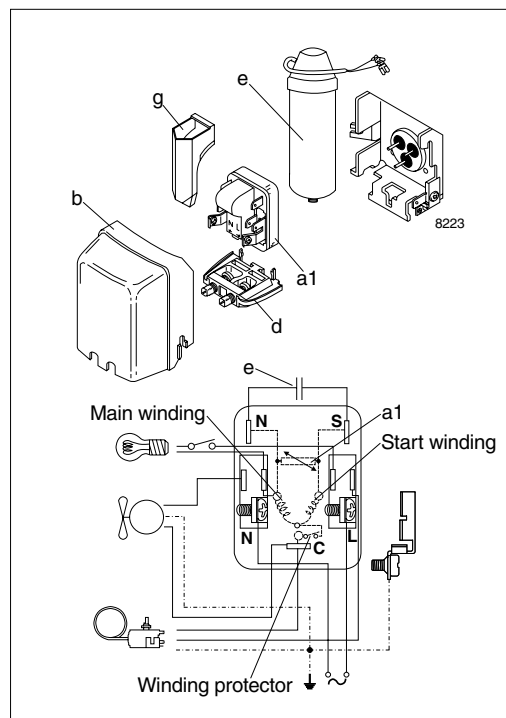
**Accessories**

Devices	Fig.	NLX8.8KK
PTC starting device 6.3 mm spades 4.8 mm spades	a1	103N0016
		103N0021
ePTC starting device 4.8 mm spades		103N0050
Cover	b	103N2010
Cord relief	d	103N1010
Run capacitor 4 µF (compulsory) 6.3 mm spades 4.8 mm spades	e	117-7117
		117-7119
Protection screen for PTC	g	103N0476
Mounting accessories		
Bolt joint for one compressor		118-1917
Bolt joint in quantities		118-1918
Snap-on in quantities		118-1919