

NLY13K

High Energy-optimized Compressor

R600a

220-240V 50Hz

Data Sheet (Replaces CD.53.L1.02)

General

Compressor	NLY13K
Code number	105H6964

Application

Application	LBP
Evaporating temperature range	°C -35 to -10
Voltage range	V/Hz 198 - 254 /50
Motor type	RSCR*
Max. ambient temperature	°C 38
Comp. cooling at ambient temp.	32°C S
	38°C S

* run capacitor 4 µF compulsory

Design

Displacement	cm ³	13.25
Oil quantity	cm ³	270
Maximum refrigerant charge	g	150
Free gas vol. in compressor	cm ³	2310
Weight without electrical equipment	kg	10.8

Motor

Motor size	watt	190
LRA (rated after 4 sec. UL984) LST	A	6.1
Cut-in current LST	A	11.3
Resistance, main and start winding (25°C)	Ω	11.0/9.0
Approvals	EN 60335-2-34 with Annex AA	

Dimensions

Height	mm	A	203
		B	197
Suction connector	location/I.D. mm	C	6.2 ±0.09
Process connector	location/I.D. mm	D	6.2 ±0.09
Discharge connector	location/I.D. mm	E	5.0 +0.12/+0.20
Compressors on a pallet	pcs.		80

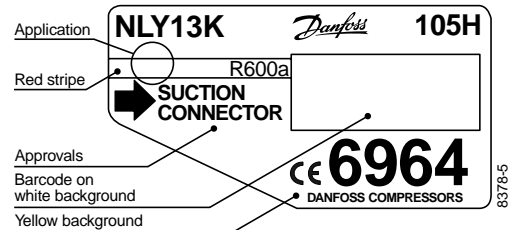

- S = Static cooling normally sufficient
- O = Oil cooling
- F₁ = Fan cooling 1.5 m/s
(compressor compartment temperature equal to ambient temperature)
- F₂ = Fan cooling 3.0 m/s necessary

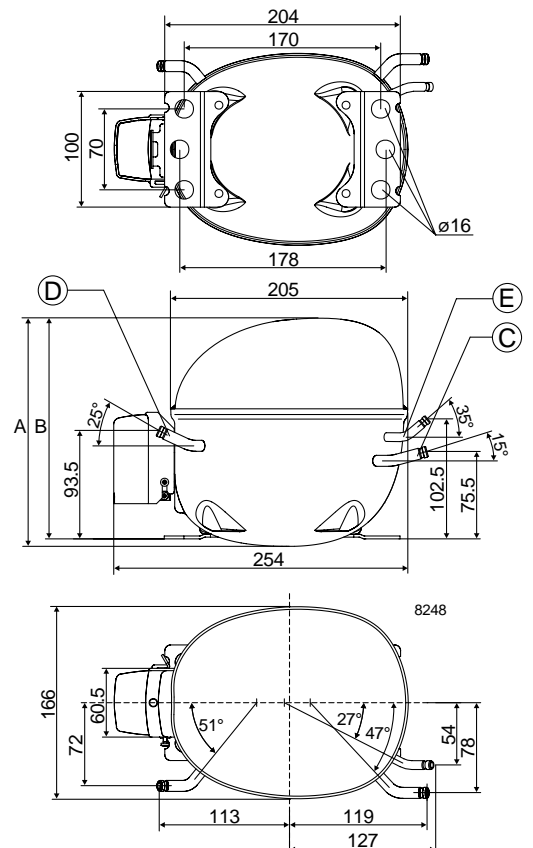

Capacity (EN 12900/CECOMAF)

watt

Comp. °C	-35	-30	-25	-23.3	-20	-15	-10
NLY13K	88	118	154	168	198	250	313

Capacity (ASHRAE)

watt

Comp. °C	-35	-30	-25	-23.3	-20	-15	-10
NLY13K	107	143	187	204	241	305	381

Power consumption

watt

Comp. °C	-35	-30	-25	-23.3	-20	-15	-10
NLY13K	91	111	131	137	150	169	189

Current consumption

A

Comp. °C	-35	-30	-25	-23.3	-20	-15	-10
NLY13K	0.57	0.63	0.70	0.73	0.79	0.88	0.99

COP (EN 12900/CECOMAF)

W/W

Comp. °C	-35	-30	-25	-23.3	-20	-15	-10
NLY13K	0.97	1.06	1.18	1.22	1.32	1.48	1.65

COP (ASHRAE)

W/W

Comp. °C	-35	-30	-25	-23.3	-20	-15	-10
NLY13K	1.18	1.29	1.43	1.49	1.61	1.80	2.01

Test conditions	EN 12900/CECOMAF	ASHRAE
Condensing temperature	55°C	55°C
Ambient and suction gas temp.	32°C	32°C
Liquid temperature	55°C	32°C
Static cooling, with RC 4 µF, 220V 50Hz, PTC consumption incl.		

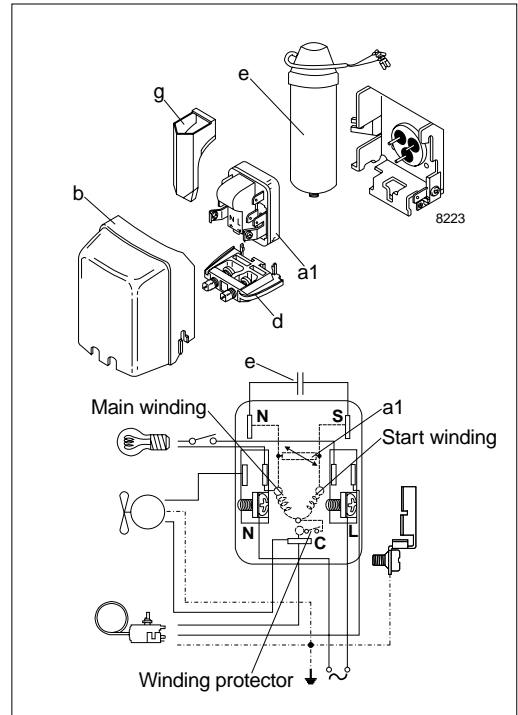

Accessories

Devices	Fig.	NLY13K
PTC starting device 6.3 mm spades 4.8 mm spades	a1	103N0016 103N0021
Cover	b	103N2010
Cord relief	d	103N1010
Run capacitor 4 µF (compulsory) 6.3 mm spades 4.8 mm spades	e	117-7117 117-7119
Protection screen for PTC	g	103N0476
Mounting accessories Bolt joint for one compressor Bolt joint in quantities Snap-on in quantities		118-1917 118-1918 118-1919