

# NLY15KK

## High Energy-optimized Compressor

### R600a

### 220-240V 50Hz

Data Sheet (Replaces CD.53.M1.02)

#### General

Compressor	NLY15KK
Code number	105H6982

#### Application

Application	LBP	
Evaporating temperature range	°C	-35 to -10
Voltage range	V/Hz	198 - 254 /50
Motor type	RSCR*	
Max. ambient temperature	°C	38
Comp. cooling at ambient temp.	32°C	S
	38°C	S

\* run capacitor 4 µF compulsory

#### Design

Displacement	cm <sup>3</sup>	14.65
Oil quantity	cm <sup>3</sup>	270
Maximum refrigerant charge	g	150
Free gas vol. in compressor	cm <sup>3</sup>	2310
Weight without electrical equipment	kg	10.8

#### Motor

Motor size	watt	260
LRA (rated after 4 sec. UL984) LST	A	6.9
Cut-in current LST	A	12.4
Resistance, main and start winding (25°C)	Ω	9.7/7.8
Approvals	EN 60335-2-34 with Annex AA	

#### Dimensions

Height	mm	A	203
		B	197
Suction connector	location/I.D. mm	C	6.2 ±0.09
Process connector	location/I.D. mm	D	6.2 ±0.09
Discharge connector	location/I.D. mm	E	5.0 +0.12/+0.20
Compressors on a pallet	pcs.	80	

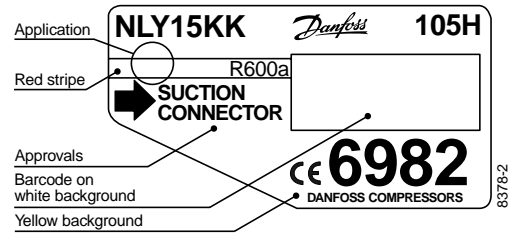

- S = Static cooling normally sufficient
- O = Oil cooling
- F<sub>1</sub> = Fan cooling 1.5 m/s  
(compressor compartment temperature equal to ambient temperature)
- F<sub>2</sub> = Fan cooling 3.0 m/s necessary

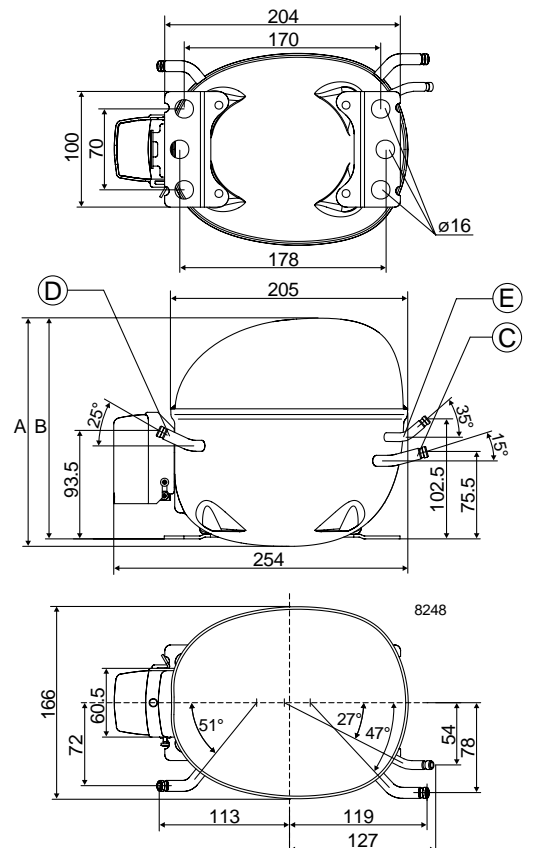

**Capacity (EN 12900/CECOMAF)**

**watt**

Comp. °C	-35	-30	-25	-23.3	-20	-15	-10
NLY15KK	95	130	172	188	223	284	357

**Capacity (ASHRAE)**

**watt**

Comp. °C	-35	-30	-25	-23.3	-20	-15	-10
NLY15KK	116	158	209	229	271	346	435

**Power consumption**

**watt**

Comp. °C	-35	-30	-25	-23.3	-20	-15	-10
NLY15KK	101	124	145	153	166	187	209

**Current consumption**

**A**

Comp. °C	-35	-30	-25	-23.3	-20	-15	-10
NLY15KK	0.66	0.73	0.81	0.84	0.91	1.01	1.14

**COP (EN 12900/CECOMAF)**

**W/W**

Comp. °C	-35	-30	-25	-23.3	-20	-15	-10
NLY15KK	0.94	1.04	1.19	1.24	1.34	1.52	1.71

**COP (ASHRAE)**

**W/W**

Comp. °C	-35	-30	-25	-23.3	-20	-15	-10
NLY15KK	1.14	1.27	1.45	1.51	1.63	1.84	2.07

Test conditions                      EN 12900/CECOMAF                      ASHRAE  
 Condensing temperature              55°C    55°C  
 Ambient and suction gas temp.        32°C    32°C  
 Liquid temperature                      55°C    32°C  
 Static cooling, with RC 4 µF, 220V 50Hz,  
 PTC consumption incl.

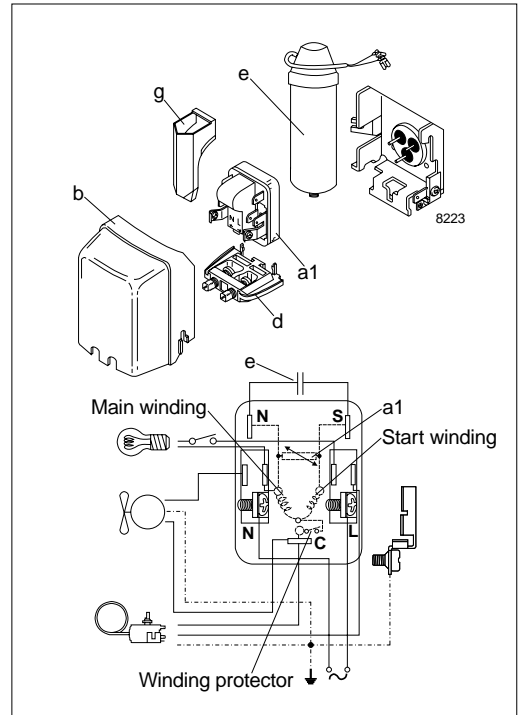

**Accessories**

Devices	Fig.	NLY15KK
PTC starting device    6.3 mm spades 4.8 mm spades	a1	103N0016 103N0021
Cover	b	103N2010
Cord relief	d	103N1010
Run capacitor 4 µF (compulsory) 6.3 mm spades 4.8 mm spades	e	117-7117 117-7119
Protection screen for PTC	g	103N0476
Mounting accessories Bolt joint for one compressor Bolt joint in quantities Snap-on in quantities		118-1917 118-1918 118-1919