

# PLE50F

## Energy-optimized Compressor

### R134a

### 220-240V 50Hz

Data Sheet (Replaces CD.41.H3.02)

#### General

Compressor	<b>PLE50F</b>
Code number	101G0221

#### Application

Application		MBP
Evaporating temperature range	°C	-25 to 0
Voltage range	V/Hz	198 - 254 /50
Motor type		RSCR*
Max. ambient temperature	°C	38
Comp. cooling at ambient temp.	32°C	S
	38°C	S

\* run capacitor 4 µF compulsory

#### Design

Displacement	cm <sup>3</sup>	2.50
Oil quantity	cm <sup>3</sup>	150
Maximum refrigerant charge	g	300
Free gas vol. in compressor	cm <sup>3</sup>	870
Weight without electrical equipment	kg	4.8

#### Motor

Motor size	watt	44
LRA (rated after 4 sec. UL984) LST	A	1.4
Cut-in current LST	A	5.1
Resistance, main and start winding (25°C)	Ω	47.0/24.0
Approvals		EN 60335-2-34 with Annex AA

#### Dimensions

Height	mm	A	140
		B	138
		B1	131
		B2	73
Suction connector	location/I.D. mm	C	6.2 ±0.09
Process connector	location/I.D. mm	D	6.2 ±0.09
Discharge connector	location/I.D. mm	E	5.0 +0.12/+0.20
Compressors on a pallet	pcs.		150

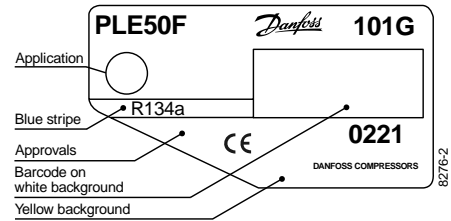

- S = Static cooling normally sufficient
- O = Oil cooling
- F<sub>1</sub> = Fan cooling 1.5 m/s  
(compressor compartment temperature equal to ambient temperature)
- F<sub>2</sub> = Fan cooling 3.0 m/s necessary

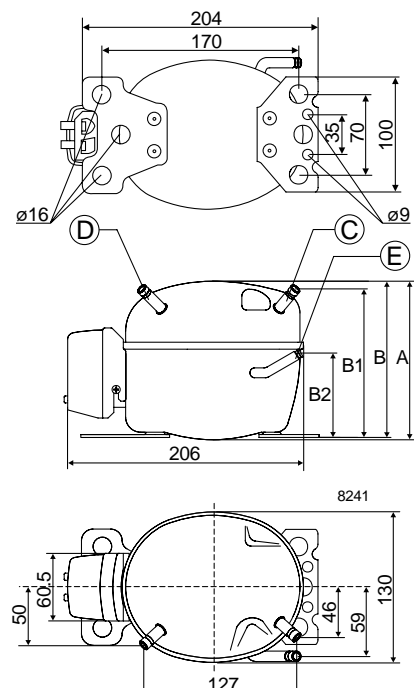

**Capacity (EN 12900/CECOMAF)**

watt

Comp. \ °C	-25	-23.3	-20	-15	-10	-5	0
PLE50F	42.0	47.2	57.9	76.2	97.4	122	150

**Capacity (ASHRAE)**

watt

Comp. \ °C	-25	-23.3	-20	-15	-10	-5	0
PLE50F	51.9	58.2	71.5	94.1	120	151	186

**Power consumption**

watt

Comp. \ °C	-25	-23.3	-20	-15	-10	-5	0
PLE50F	52.0	54.4	59.0	66.3	74.2	82.8	92.6

**Current consumption**

A

Comp. \ °C	-25	-23.3	-20	-15	-10	-5	0
PLE50F	0.29	0.30	0.31	0.34	0.37	0.40	0.44

**COP (EN 12900/CECOMAF)**

W/W

Comp. \ °C	-25	-23.3	-20	-15	-10	-5	0
PLE50F	0.81	0.87	0.98	1.15	1.31	1.47	1.62

**COP (ASHRAE)**

W/W

Comp. \ °C	-25	-23.3	-20	-15	-10	-5	0
PLE50F	1.00	1.07	1.21	1.42	1.62	1.82	2.01

Test conditions EN 12900/CECOMAF ASHRAE  
 Condensing temperature 55°C 55°C  
 Ambient and suction gas temp. 32°C 32°C  
 Liquid temperature 55°C 32°C  
 Static cooling, with RC 4 µF, 220V 50Hz,  
 PTC consumption incl.

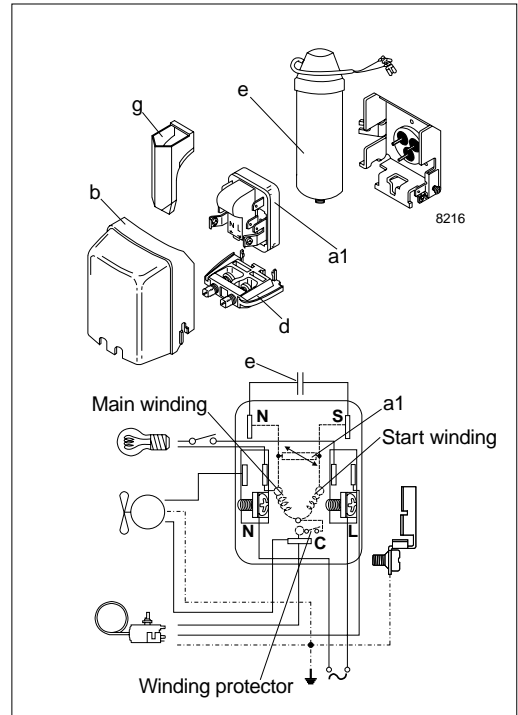

**Accessories**

Devices	Fig.	PLE50F
PTC starting device 6.3 mm spades 4.8 mm spades	a1	103N0016 103N0021
Cover	b	103N0491
Cord relief	d	103N1010
Run capacitor 4 µF (compulsory) 6.3 mm spades 4.8 mm spades	e	117-7117 117-7119
Protection screen for PTC	g	103N0476
Mounting accessories Bolt joint for one compressor Bolt joint in quantities Snap-on in quantities		118-1917 118-1918 118-1919