

# SC10DL MBP/HBP Compressor R407C 220-240V 50Hz

Data Sheet (Replaces CF.54.V1.02)

## General

Compressor	<b>SC10DL</b>
Code number	104L2525

## Application

Application	MBP/HBP	
Evaporating temperature range	°C	-15 to 15
Voltage range	V/Hz	198 - 254 /50
Motor type	CSIR	
Max. ambient temperature	°C	38
Comp. cooling at ambient temp.	32°C	F <sub>2</sub>
	38°C	F <sub>2</sub>

## Design

Displacement	cm <sup>3</sup>	10.29
Oil quantity	cm <sup>3</sup>	600
Maximum refrigerant charge	g	1300
Free gas vol. in compressor	cm <sup>3</sup>	1410
Weight without electrical equipment	kg	13.1

## Motor

Motor size	watt	385
LRA (rated after 4 sec. UL984) HST	A	14.8
Cut-in current HST	A	14.8
Resistance, main and start winding (25°C)	Ω	5.0/13.7
Approvals	EN 60 335-2-34	

## Dimensions

Height	mm	A	209
		B	203
		B1	183
		B2	100
Suction connector	location/I.D. mm	C	8.2 ±0.09
Process connector	location/I.D. mm	D	6.2 ±0.09
Discharge connector	location/I.D. mm	E	6.2 ±0.09
Compressors on a pallet	pcs.	80	

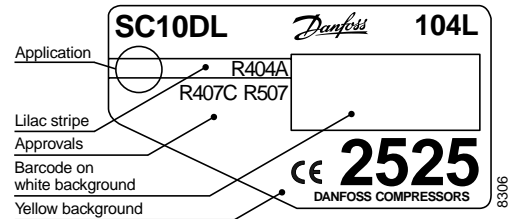

- S = Static cooling normally sufficient
- O = Oil cooling
- F<sub>1</sub> = Fan cooling 1.5 m/s  
(compressor compartment temperature equal to ambient temperature)
- F<sub>2</sub> = Fan cooling 3.0 m/s necessary

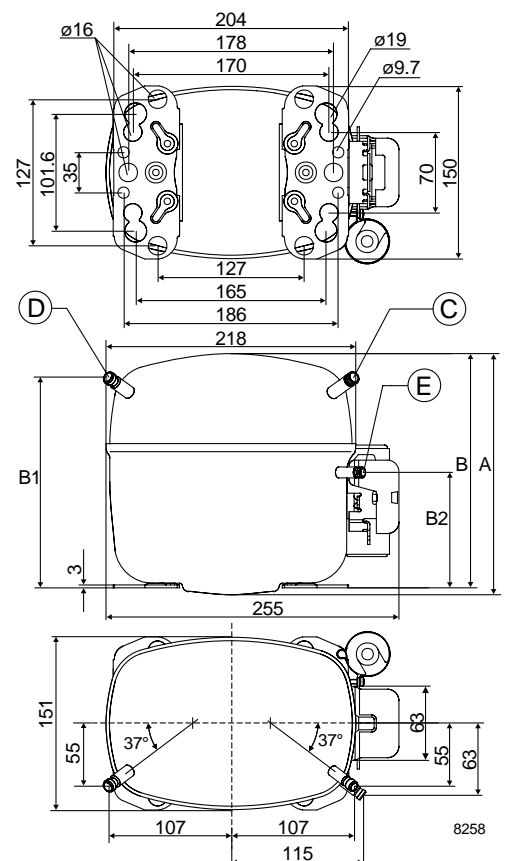

**Capacity (EN 12900/CECOMAF)**

**watt**

Comp.°C	-15	-10	-5	0	5	7.2	10	15
SC10DL	480	636	821	1039	1293	1417	1588	1927

**Capacity (ASHRAE)**

**watt**

Comp.°C	-15	-10	-5	0	5	7.2	10	15
SC10DL	515	682	881	1114	1388	1522	1706	2073

**Power consumption**

**watt**

Comp.°C	-15	-10	-5	0	5	7.2	10	15
SC10DL	346	394	437	476	510	524	540	568

**Current consumption**

**A**

Comp.°C	-15	-10	-5	0	5	7.2	10	15
SC10DL	2.50	2.66	2.81	2.95	3.08	3.14	3.20	3.31

**COP (EN 12900/CECOMAF)**

**W/W**

Comp.°C	-15	-10	-5	0	5	7.2	10	15
SC10DL	1.39	1.61	1.88	2.18	2.54	2.71	2.94	3.40

**COP (ASHRAE)**

**W/W**

Comp.°C	-15	-10	-5	0	5	7.2	10	15
SC10DL	1.49	1.73	2.01	2.34	2.72	2.91	3.16	3.65

Test conditions

Condensing temperature

Ambient and suction gas temp.

Liquid temperature

Fan cooling F<sub>2</sub>, 220V 50Hz

EN 12900/CECOMAF

45°C

32°C

no subcooling

ASHRAE

45°C

32°C

32°C

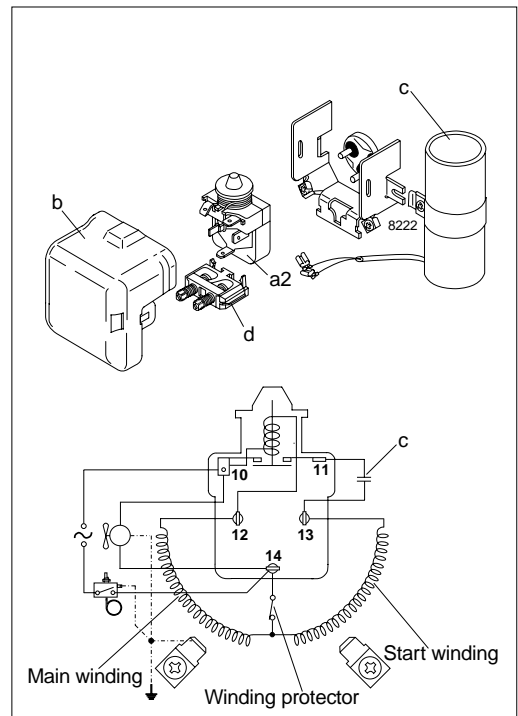

**Accessories**

Devices	Fig.	SC10DL
Starting relay	a2	117U6005
Cover	b	103N2009
Starting capacitor 80 µF	c	117U5017
Cord relief	d	103N1004
Mounting accessories		
Bolt joint for one compressor		118-1917
Bolt joint in quantities		118-1918
Snap-on in quantities		118-1919