

SC12DL MBP/HBP Compressor R407C 220-240V 50Hz

Data Sheet (Replaces CF.54.W1.02)

General

Compressor	SC12DL
Code number	104L2625

Application

Application	MBP/HBP	
Evaporating temperature range	°C	-15 to 15
Voltage range	V/Hz	198 - 254 /50
Motor type	CSIR	
Max. ambient temperature	°C	38
Comp. cooling at ambient temp.	32°C	F ₂
	38°C	F ₂

Design

Displacement	cm ³	12.87
Oil quantity	cm ³	600
Maximum refrigerant charge	g	1300
Free gas vol. in compressor	cm ³	1460
Weight without electrical equipment	kg	13.6

Motor

Motor size	watt	495
LRA (rated after 4 sec. UL984) HST	A	18.6
Cut-in current HST	A	18.6
Resistance, main and start winding (25°C)	Ω	3.7/14.1
Approvals	EN 60335-2-34	

Dimensions

Height	mm	A	219
		B	213
		B1	193
		B2	110
Suction connector	location/I.D. mm	C	10.2 ±0.09
Process connector	location/I.D. mm	D	6.2 ±0.09
Discharge connector	location/I.D. mm	E	6.2 ±0.09
Compressors on a pallet	pcs.	80	

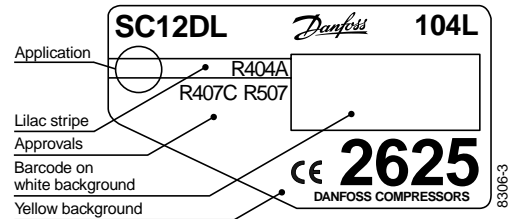

- S = Static cooling normally sufficient
- O = Oil cooling
- F₁ = Fan cooling 1.5 m/s
(compressor compartment temperature equal to ambient temperature)
- F₂ = Fan cooling 3.0 m/s necessary

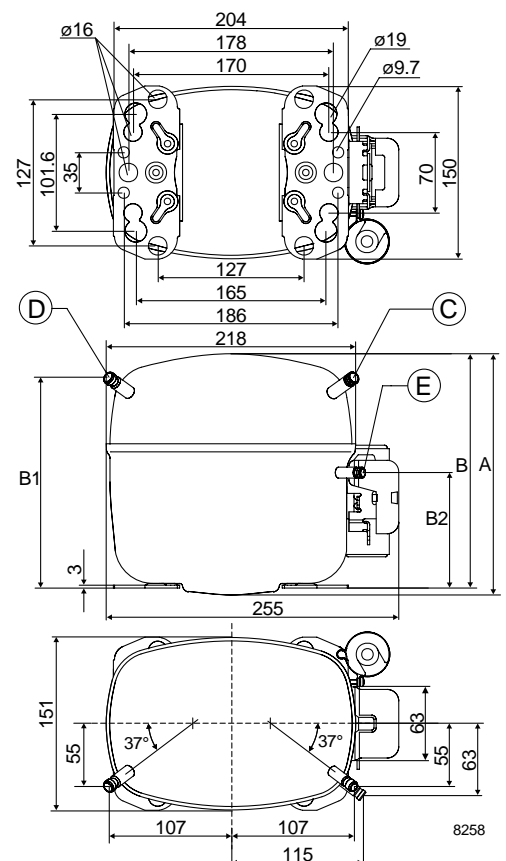

Capacity (EN 12900/CECOMAF)
watt

Comp.°C	-15	-10	-5	0	5	7.2	10	15
SC12DL	632	831	1065	1340	1660	1817	2031	2456

Capacity (ASHRAE)
watt

Comp.°C	-15	-10	-5	0	5	7.2	10	15
SC12DL	677	891	1143	1438	1783	1951	2182	2642

Power consumption
watt

Comp.°C	-15	-10	-5	0	5	7.2	10	15
SC12DL	456	512	562	606	643	658	675	700

Current consumption
A

Comp.°C	-15	-10	-5	0	5	7.2	10	15
SC12DL	3.11	3.31	3.49	3.65	3.79	3.85	3.91	4.01

COP (EN 12900/CECOMAF)
W/W

Comp.°C	-15	-10	-5	0	5	7.2	10	15
SC12DL	1.39	1.62	1.89	2.21	2.58	2.76	3.01	3.51

COP (ASHRAE)
W/W

Comp.°C	-15	-10	-5	0	5	7.2	10	15
SC12DL	1.48	1.74	2.03	2.37	2.77	2.97	3.23	3.77

Test conditions

Condensing temperature

Ambient and suction gas temp.

Liquid temperature

 Fan cooling F₂, 220V 50Hz

EN 12900/CECOMAF

45°C

32°C

no subcooling

ASHRAE

45°C

32°C

32°C

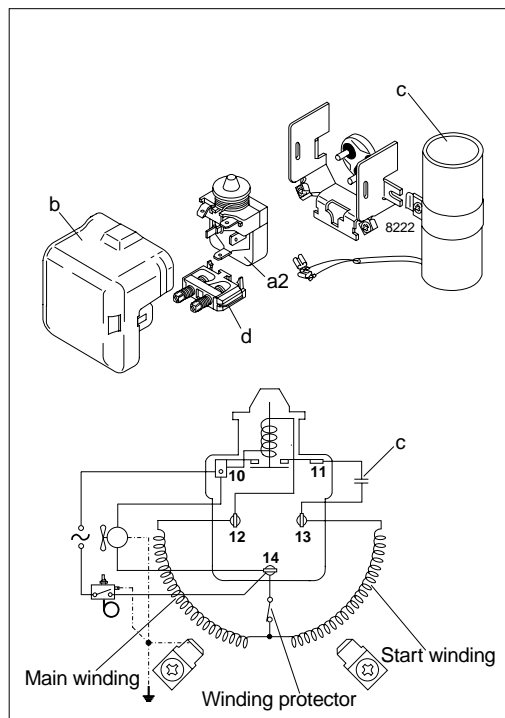
Accessories

Devices	Fig.	SC12DL
Starting relay	a2	117U6019
Cover	b	103N2009
Starting capacitor 80 µF	c	117U5017
Cord relief	d	103N1004
Mounting accessories		
Bolt joint for one compressor		118-1917
Bolt joint in quantities		118-1918
Snap-on in quantities		118-1919