

# SC12MLX MBP Compressor R404A/R507 115V 60Hz

Data Sheet (Replaces CJ.54.J1.22)

## General

Compressor (CU-plated steel connectors)	<b>SC12MLX</b>
Codenumber	104L1606

## Application

Application		MBP
Evaporating temperature range	°F (°C)	-10 to 45 (-23.3 to 7.2)
Voltage range	V/Hz	95 - 135 /60
Motor type		CSIR
Max. ambient temperature	°F (°C)	110 (43)
Comp. cooling at max. ambient temperature	110°F (43°C)	F <sub>2</sub>

## Design

Displacement	cu.in. (cm <sup>3</sup> )	0.78 (12.86)
Oil quantity	fl.oz. (cm <sup>3</sup> )	20.3 (600)
Maximum refrigerant charge	oz. (g)	45.5 (1300)
Free gas vol. in compressor housing	fl.oz. (cm <sup>3</sup> )	49.4 (1460)
Weight without electrical equipment	lbs. (kg)	30.2 (13.7)

## Motor

Motor size	watt	755
LRA (rated after 4 sec.UL984) HST	A	53
Cut-in current HST	A	53
Resistance, main and start winding (77°F) Ω		0.7/2.9
Approvals		UL984/CSA-C22.2

## Dimensions

Height	in. (mm)	A	8.62 (219)
		B	8.39 (213)
		B1	7.60 (193)
		B2	4.33 (110)
Suction connector	location/I.D. in. (mm)	C	0.320-0.327 (8.2±0.09)
Process connector	location/I.D. in. (mm)	D	0.252-0.259 (6.5±0.09)
Discharge connector	location/I.D. in. (mm)	E	0.252-0.259 (6.5±0.09)
Compressors on a pallet	pcs.		60

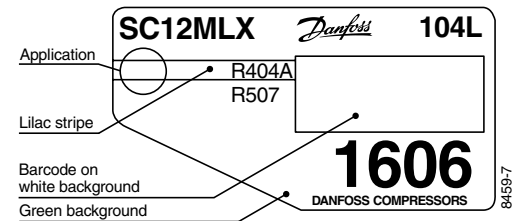

- S = Static cooling normally sufficient
- O = Oil cooling
- F<sub>1</sub> = Fan cooling 1.5 m/s (compressor compartment temp. equal to ambient temperature)
- F<sub>2</sub> = Fan cooling 3.0 m/s necessary

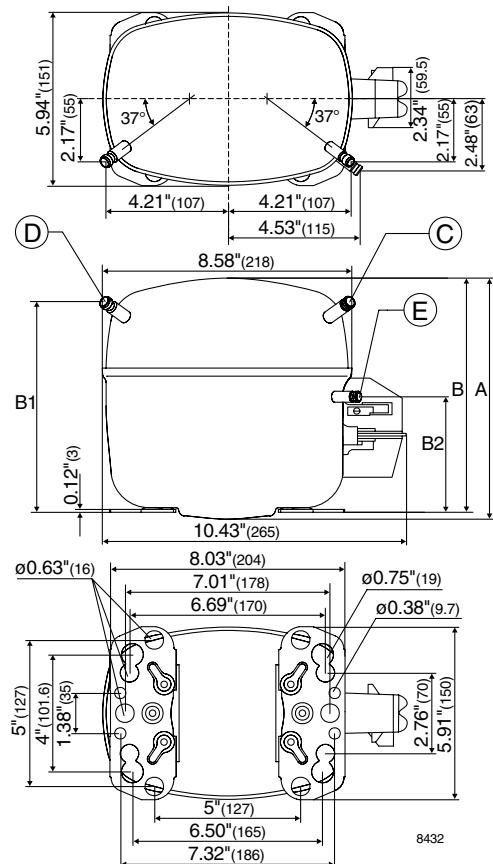

**Capacity ASHRAE in Btu/h - EN 12900/CECOMAF in watt**

Evap. temp in °F	-10	0	10	20	30	40	41	45
Evap. temp in °C	-23.3	-17.8	-12.2	-6.7	-1.1	4.4	5	7.2
ASHRAE MBP	1987	2640	3435	4391	5527	6865	7011	7616
EN 12900	667	864	1103	1388	1725	2118	2160	2337

**Power consumption (ASHRAE, EN 12900/CECOMAF) watt**

Evap. temp in °F	-10	0	10	20	30	40	41	45
Evap. temp in °C	-23.3	-17.8	-12.2	-6.7	-1.1	4.4	5	7.2
ASHRAE MBP	581	676	770	865	960	1058	1067	1107
EN 12900	589	662	735	811	890	973	982	1017

**Current consumption (ASHRAE, EN 12900/CECOMAF) A**

Evap. temp in °F	-10	0	10	20	30	40	41	45
Evap. temp in °C	-23.3	-17.8	-12.2	-6.7	-1.1	4.4	5	7.2
ASHRAE MBP	7.93	8.50	9.13	9.83	10.58	11.39	11.48	11.82
EN 12900	7.94	8.38	8.88	9.44	10.06	10.74	10.81	11.10

**EER / COP ASHRAE in Btu/Wh - EN 12900/CECOMAF in W/W**

Evap. temp in °F	-10	0	10	20	30	40	41	45
Evap. temp in °C	-23.3	-17.8	-12.2	-6.7	-1.1	4.4	5	7.2
ASHRAE MBP	3.42	3.90	4.46	5.08	5.76	6.49	6.57	6.88
EN 12900	1.13	1.31	1.50	1.71	1.94	2.18	2.20	2.30

Test conditions	ASHRAE MBP	EN 12900
Condensing temperature	130°F (54.4°C)	45°C (113°F)
Suction gas temperature	95°F (35°C)	32°C (90°F)
Ambient temperature	90°F (32°C)	32°C (90°F)
Liquid temperature	115°F (46°C)	45°C (113°F)
Cooling	Fan F2	Fan F2
V/Hz	115/60	115/60

**Design limits:**

Max. cond. temp. °F (°C) stable	120 (49)
Max. cond. temp. °F (°C) peak	135 (58)

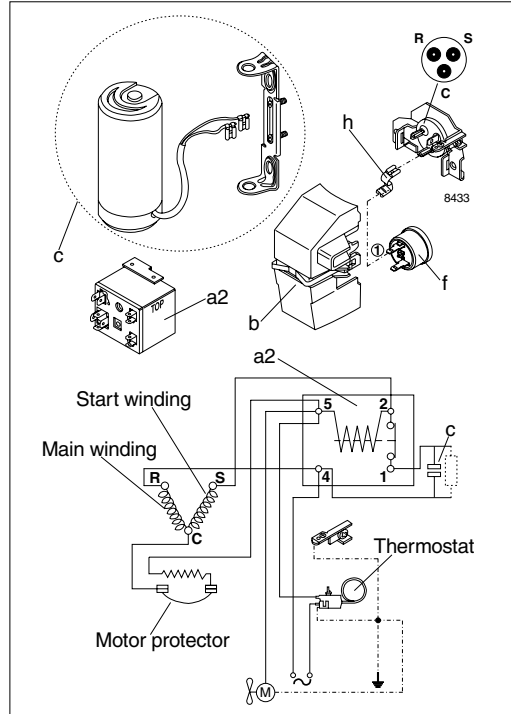

**Accessories**

Devices	Fig.	SC12MLX	
Starting relay	a2	117-7441	
Starting capacitor 410 µF	c	117U5042	
Cover	b	parts of compressor	(117U1021)
Protector	f		(117U3212)
Protector holder	h		(117U0438)
Mounting accessories	Ø in. (mm)		
Bolt joint for one compressor	5/8 (16)	118-1917	
Bolt joint in quantities	5/8 (16)	118-1918	
Snap-on in quantities	5/8 (16)	118-1919	