

# SC15DL MBP/HBP Compressor R407C 220-240V 50Hz

Data Sheet (Replaces CF.54.X1.02)

## General

Compressor	<b>SC15DL</b>
Code number	104L2856

## Application

Application	MBP/HBP	
Evaporating temperature range	°C	-15 to 15
Voltage range	V/Hz	198 - 254 /50
Motor type	CSR	
Max. ambient temperature	°C	38
Comp. cooling at ambient temp.	32°C	F <sub>2</sub>
	38°C	F <sub>2</sub>

## Design

Displacement	cm <sup>3</sup>	15.28
Oil quantity	cm <sup>3</sup>	600
Maximum refrigerant charge	g	1300
Free gas vol. in compressor	cm <sup>3</sup>	1460
Weight without electrical equipment	kg	13.5

## Motor

Motor size	watt	550
LRA (rated after 4 sec. UL984) HST	A	21.8
Cut-in current HST	A	21.8
Resistance, main and start winding (25°C)	Ω	3.5/12.2
Approvals	EN 60 335-2-34	

## Dimensions

Height	mm	A	219
		B	213
		B1	193
		B2	110
Suction connector	location/I.D. mm	C	10.2 ±0.09
Process connector	location/I.D. mm	D	6.2 ±0.09
Discharge connector	location/I.D. mm	E	6.2 ±0.09
Compressors on a pallet	pcs.	80	

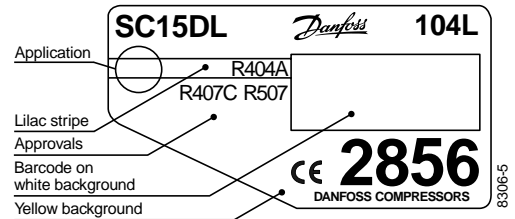

- S = Static cooling normally sufficient
- O = Oil cooling
- F<sub>1</sub> = Fan cooling 1.5 m/s  
(compressor compartment temperature equal to ambient temperature)
- F<sub>2</sub> = Fan cooling 3.0 m/s necessary

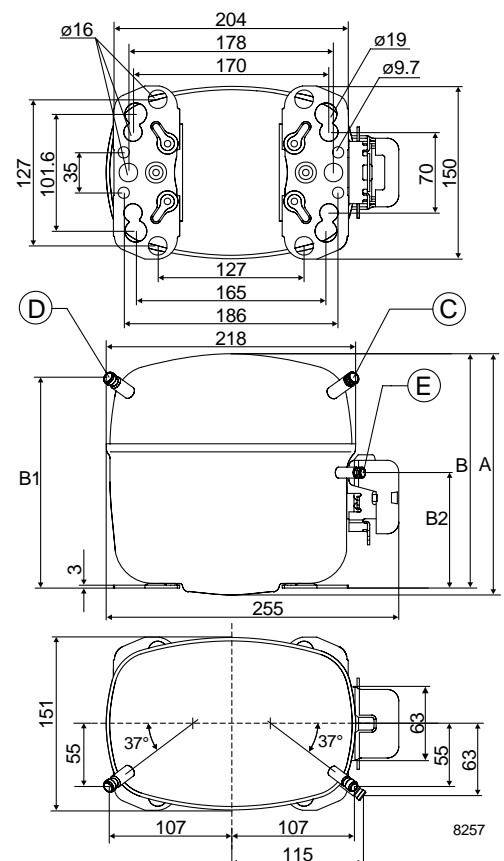

**Capacity (EN 12900/CECOMAF)**
**watt**

Comp. \ °C	-15	-10	-5	0	5	7.2	10	15
SC15DL	777	1011	1293	1629	2023	2217	2483	3014

**Capacity (ASHRAE)**
**watt**

Comp. \ °C	-15	-10	-5	0	5	7.2	10	15
SC15DL	833	1084	1387	1748	2173	2381	2668	3241

**Power consumption**
**watt**

Comp. \ °C	-15	-10	-5	0	5	7.2	10	15
SC15DL	534	590	640	686	726	742	761	790

**Current consumption**
**A**

Comp. \ °C	-15	-10	-5	0	5	7.2	10	15
SC15DL	2.84	3.08	3.30	3.50	3.67	3.74	3.82	3.94

**COP (EN 12900/CECOMAF)**
**W/W**

Comp. \ °C	-15	-10	-5	0	5	7.2	10	15
SC15DL	1.45	1.71	2.02	2.37	2.79	2.99	3.26	3.82

**COP (ASHRAE)**
**W/W**

Comp. \ °C	-15	-10	-5	0	5	7.2	10	15
SC15DL	1.56	1.84	2.17	2.55	2.99	3.21	3.51	4.10

Test conditions

EN 12900/CECOMAF

ASHRAE

Condensing temperature

45°C

45°C

Ambient and suction gas temp.

32°C

32°C

Liquid temperature

no subcooling

32°C

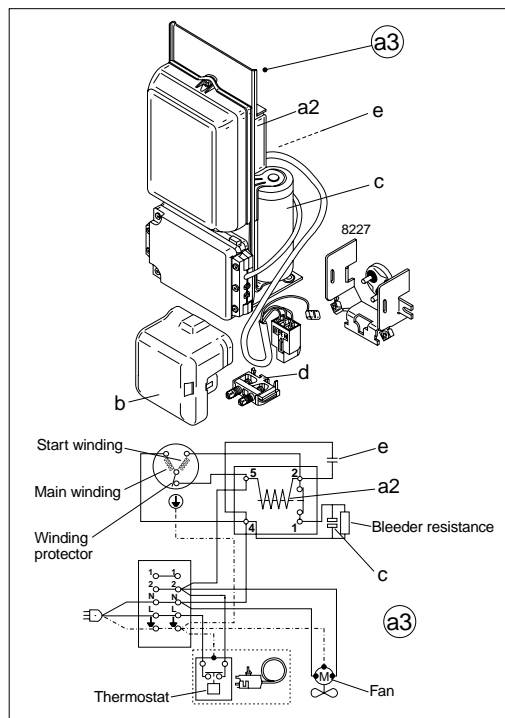
 Fan cooling F<sub>2</sub>, 220V 50Hz

**Accessories**

Devices	Fig.	SC15DL
Starting device	a3	117-7028 (470 mm cable length) 117-7029 (550 mm cable length) 117-7032 (650 mm cable length)
Cover	b	103N2009
Starting relay	a2	Components of starting device
Starting capacitor 80 µF	c	
Run capacitor	e	
Cord relief	d	103N1004
Mounting accessories		
Bolt joint for one compressor		118-1917
Bolt joint in quantities		118-1918
Snap-on in quantities		118-1919