

# TLES6F

## Energy-optimized Compressor

### R134a

### 220-240V 50Hz

Data Sheet (Replaces CD.42.T4.02)

#### General

Compressor	TLES6F
Code number	102G4610

#### Application

Application	LBP	
Evaporating temperature range	°C	-35 to -10
Voltage range	V/Hz	198 - 254 /50
Motor type	RSIR/RSCR	
Max. ambient temperature	°C	43*
Comp. cooling at ambient temp.	32°C	S
	38°C	S
	43°C	S

\* run capacitor 4 µF compulsory in 38°C and higher ambient temperature

#### Design

Displacement	cm <sup>3</sup>	5.70
Oil quantity	cm <sup>3</sup>	180
Maximum refrigerant charge	g	400
Free gas vol. in compressor	cm <sup>3</sup>	1790
Weight without electrical equipment	kg	7.6

#### Motor

Motor size	watt	120
LRA (rated after 4 sec. UL984) LST	A	4.5
Cut-in current LST	A	8.8
Resistance, main and start winding (25°C)	Ω	16.5/16.9
Approvals	EN 60335-2-34 with Annex AA	

#### Dimensions

Height	mm	A	173
		B	169
Suction connector	location/I.D. mm	C	6.2 ±0.09
Process connector	location/I.D. mm	D	6.2 ±0.09
Discharge connector	location/I.D. mm	E	5.0 +0.12/+0.20
Compressors on a pallet	pcs.	125	

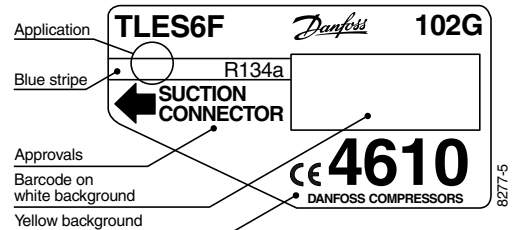

- S = Static cooling normally sufficient
- O = Oil cooling
- F<sub>1</sub> = Fan cooling 1.5 m/s  
(compressor compartment temperature equal to ambient temperature)
- F<sub>2</sub> = Fan cooling 3.0 m/s necessary

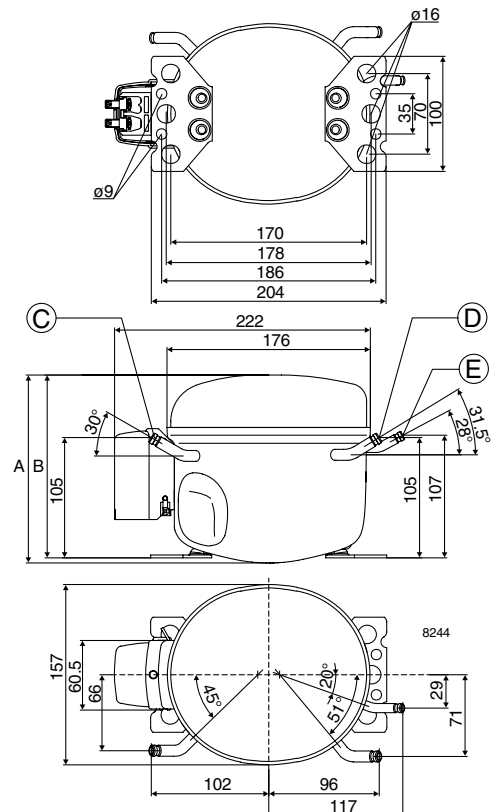

**Capacity (EN 12900/CECOMAF)**

**watt**

Comp.\°C	-35	-30	-25	-23.3	-20	-15	-10
TLES6F	58	77	104	115	139	183	235

**Capacity (ASHRAE)**

**watt**

Comp.\°C	-35	-30	-25	-23.3	-20	-15	-10
TLES6F	71	95	128	142	172	226	290

**Power consumption**

**watt**

Comp.\°C	-35	-30	-25	-23.3	-20	-15	-10
TLES6F	76	93	112	118	131	151	172

**Current consumption**

**A**

Comp.\°C	-35	-30	-25	-23.3	-20	-15	-10
TLES6F	0.63	0.69	0.75	0.77	0.82	0.89	0.97

**COP (EN 12900/CECOMAF)**

**W/W**

Comp.\°C	-35	-30	-25	-23.3	-20	-15	-10
TLES6F	0.76	0.82	0.93	0.97	1.06	1.21	1.37

**COP (ASHRAE)**

**W/W**

Comp.\°C	-35	-30	-25	-23.3	-20	-15	-10
TLES6F	0.94	1.01	1.14	1.20	1.31	1.49	1.69

Test conditions	EN 12900/CECOMAF	ASHRAE
Condensing temperature	55°C	55°C
Ambient and suction gas temp.	32°C	32°C
Liquid temperature	55°C	32°C
Static cooling, 220V 50Hz, PTC consumption incl.		

**Accessories**

Devices	Fig.	TLES6F
PTC starting device	6.3 mm spades	a1 103N0011
	4.8 mm spades	(pos.1) 103N0018
PTC starting device	6.3 mm spades	a1 103N0016*
	4.8 mm spades	(pos.2) 103N0021*
Cover	b	103N2010
Cord relief	d	103N1010
Run capacitor 4 µF	6.3 mm spades	e 117-7117*
	4.8 mm spades	117-7119*
Protection screen for PTC	g	103N0476
Mounting accessories		
Bolt joint for one compressor		118-1917
Bolt joint in quantities		118-1918
Snap-on in quantities		118-1919

\* run capacitor 4 µF compulsory in 38°C and higher ambient temp.

