

TLES9KK.2

Energy-optimized Compressor

R600a

220-240V 50Hz

Data Sheet (Replaces CD.52.L1.02)

General

Compressor	TLES9KK.2
Code number	102H4935

Application

Application		LBP
Evaporating temperature range	°C	-35 to -10
Voltage range	V/Hz	198 - 254 /50
Motor type		RSIR/RSCR
Max. ambient temperature	°C	38
Comp. cooling at ambient temp.	32°C	S
	38°C	S

Design

Displacement	cm ³	8.83
Oil quantity	cm ³	180
Maximum refrigerant charge	g	150
Free gas vol. in compressor	cm ³	1790
Weight without electrical equipment	kg	7.6

Motor

Motor size	watt	120
LRA (rated after 4 sec. UL984) LST	A	4.5
Cut-in current LST	A	8.8
Resistance, main and start winding (25°C)	Ω	16.5/16.9
Approvals		EN 60335-2-34 with Annex AA

Dimensions

Height	mm	A	173
		B	169
Suction connector	location/I.D. mm	C	6.2 ±0.09
Process connector	location/I.D. mm	D	6.2 ±0.09
Discharge connector	location/I.D. mm	E	5.0 +0.12/+0.20
Compressors on a pallet	pcs.		125

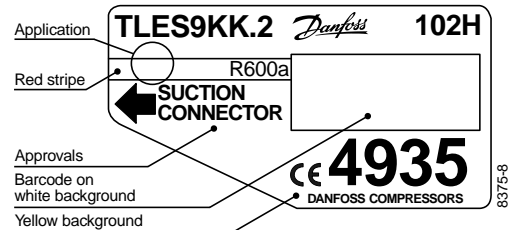

- S = Static cooling normally sufficient
- O = Oil cooling
- F₁ = Fan cooling 1.5 m/s
(compressor compartment temperature equal to ambient temperature)
- F₂ = Fan cooling 3.0 m/s necessary

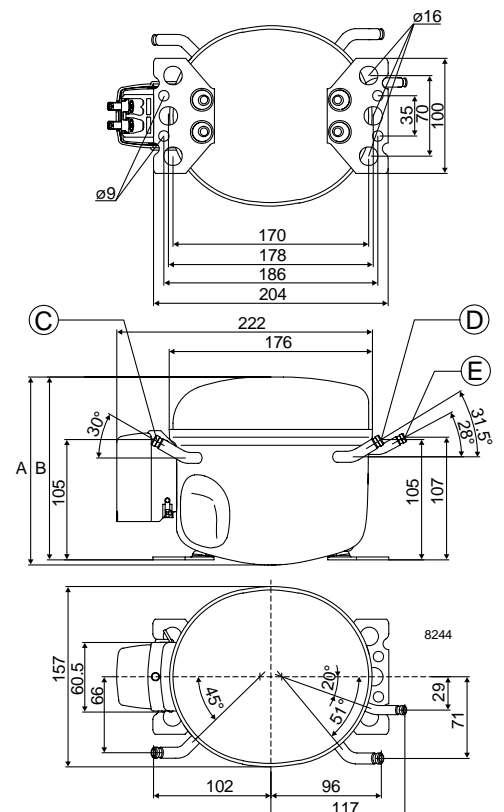
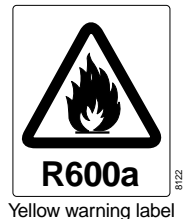

Capacity (EN 12900/CECOMAF)

watt

Comp.°C	-35	-30	-25	-23.3	-20	-15	-10
TLES9KK.2	57	77	101	110	130	164	205

Capacity (ASHRAE)

watt

Comp.°C	-35	-30	-25	-23.3	-20	-15	-10
TLES9KK.2	70	94	123	134	158	200	249

Power consumption

watt

Comp.°C	-35	-30	-25	-23.3	-20	-15	-10
TLES9KK.2	76	86	98	102	111	124	139

Current consumption

A

Comp.°C	-35	-30	-25	-23.3	-20	-15	-10
TLES9KK.2	0.69	0.73	0.78	0.80	0.83	0.89	0.95

COP (EN 12900/CECOMAF)

W/W

Comp.°C	-35	-30	-25	-23.3	-20	-15	-10
TLES9KK.2	0.76	0.89	1.03	1.09	1.17	1.32	1.48

COP (ASHRAE)

W/W

Comp.°C	-35	-30	-25	-23.3	-20	-15	-10
TLES9KK.2	0.92	1.09	1.25	1.32	1.43	1.61	1.80

Test conditions	EN 12900/CECOMAF	ASHRAE
Condensing temperature	55°C	55°C
Ambient and suction gas temp.	32°C	32°C
Liquid temperature	55°C	32°C
Static cooling, 220V 50Hz,		
PTC consumption incl.		

Accessories

Devices	Fig.	TLES9KK.2
PTC starting device 6.3 mm spades	a1	103N0011
		103N0018
PTC starting device 4.8 mm spades	a1	103N0016
		103N0021
Cover	b	103N2010
Cord relief	d	103N1010
Run capacitor 4 µF (optional)	e	117-7117
		117-7119
Protection screen for PTC	g	103N0476
Mounting accessories		
Bolt joint for one compressor		118-1917
Bolt joint in quantities		118-1918
Snap-on in quantities		118-1919

