

# TLX6KK

## High Energy-optimized Compressor

### R600a

### 220-240V 50Hz

#### Data Sheet

#### General

Compressor	TLX6KK
Code number	102H4646

#### Application

Application	LBP
Evaporating temperature range	°C -35 to -10
Voltage range	V/Hz 198 - 254 /50
Motor type	RSCR*
Max. ambient temperature	°C 38
Comp. cooling at ambient temp.	32°C S
	38°C S

\* run capacitor 4 µF compulsory

#### Design

Displacement	cm <sup>3</sup>	5.70
Oil quantity	cm <sup>3</sup>	180
Maximum refrigerant charge	g	150
Free gas vol. in compressor	cm <sup>3</sup>	1790
Weight without electrical equipment	kg	8.2

#### Motor

Motor size	watt	62
LRA (rated after 4 sec. UL984) LST	A	2.0
Cut-in current LST	A	5.5
Resistance, main and start winding (25°C)	Ω	37.0/21.0
Approvals	EN 60335-2-34 with Annex AA	

#### Dimensions

Height	mm	A	173
		B	169
Suction connector	location/I.D. mm	C	6.2 ±0.09
Process connector	location/I.D. mm	D	6.2 ±0.09
Discharge connector	location/I.D. mm	E	5.0 +0.12/+0.20
Compressors on a pallet	pcs.		125

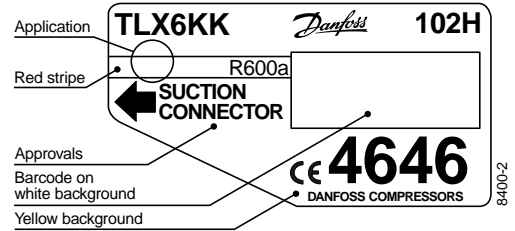

- S = Static cooling normally sufficient
- O = Oil cooling
- F<sub>1</sub> = Fan cooling 1.5 m/s  
(compressor compartment temperature equal to ambient temperature)
- F<sub>2</sub> = Fan cooling 3.0 m/s necessary

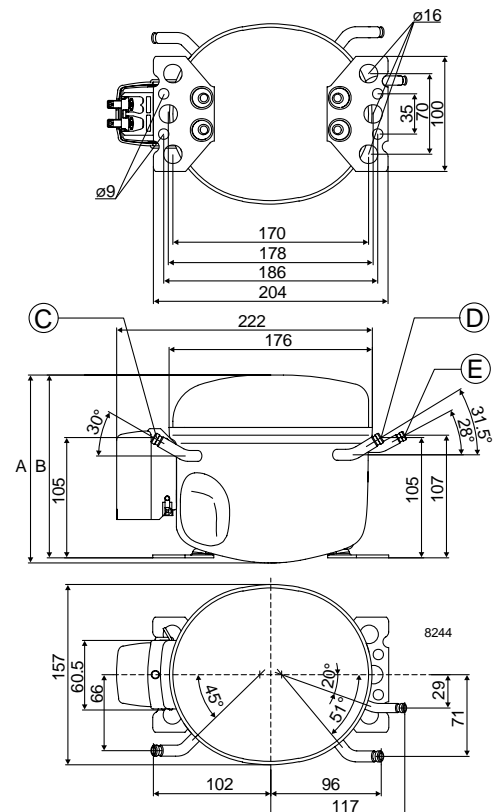
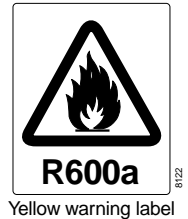

**Capacity (EN 12900/CECOMAF)**

**watt**

Comp. °C	-35	-30	-25	-23.3	-20	-15	-10
TLX6KK	35.6	50.4	68.0	74.7	88.7	113	142

**Capacity (ASHRAE)**

**watt**

Comp. °C	-35	-30	-25	-23.3	-20	-15	-10
TLX6KK	43.3	61.3	82.7	90.9	108	138	172

**Power consumption**

**watt**

Comp. °C	-35	-30	-25	-23.3	-20	-15	-10
TLX6KK	45.6	52.7	59.8	62.2	67.1	74.9	83.5

**Current consumption**

**A**

Comp. °C	-35	-30	-25	-23.3	-20	-15	-10
TLX6KK	0.24	0.27	0.29	0.30	0.33	0.36	0.40

**COP (EN 12900/CECOMAF)**

**W/W**

Comp. °C	-35	-30	-25	-23.3	-20	-15	-10
TLX6KK	0.78	0.96	1.14	1.20	1.32	1.51	1.70

**COP (ASHRAE)**

**W/W**

Comp. °C	-35	-30	-25	-23.3	-20	-15	-10
TLX6KK	0.95	1.16	1.38	1.46	1.61	1.84	2.06

Test conditions                      EN 12900/CECOMAF      ASHRAE  
 Condensing temperature          55°C                              55°C  
 Ambient and suction gas temp.    32°C                              32°C  
 Liquid temperature                  55°C                              32°C  
 Static cooling, with RC 4 µF, 220V 50Hz, PTC consumption incl.

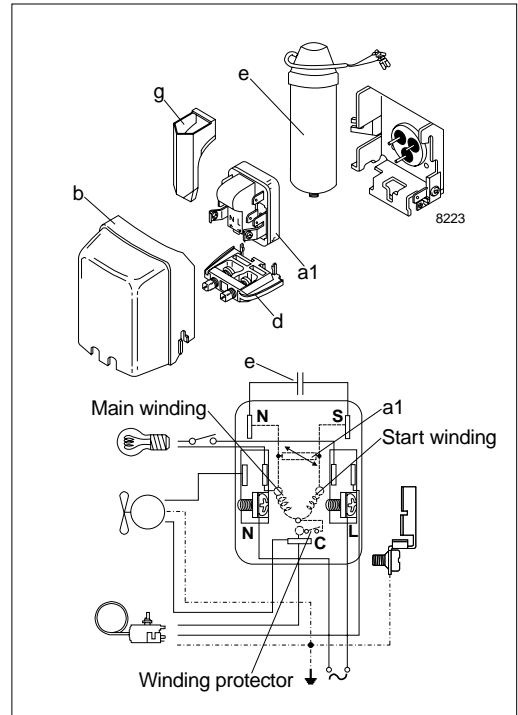

**Accessories**

Devices	Fig.	TLX6KK
PTC starting device      6.3 mm spades 4.8 mm spades	a1	103N0016 103N0021
Cover	b	103N2010
Cord relief	d	103N1010
Run capacitor 4 µF (compulsory) 6.3 mm spades 4.8 mm spades	e	117-7117 117-7119
Protection screen for PTC	g	103N0476
Mounting accessories Bolt joint for one compressor Bolt joint in quantities Snap-on in quantities		118-1917 118-1918 118-1919