

TLX7KK

High Energy-optimized Compressor

R600a

220-240V 50Hz

Data Sheet (Replaces CG.52.E1.02)

General

Compressor	TLX7KK
Code number	102H4746

Application

Application	LBP	
Evaporating temperature range	°C	-35 to -10
Voltage range	V/Hz	198 - 254 /50
Motor type	RSCR*	
Max. ambient temperature	°C	38
Comp. cooling at ambient temp.	32°C	S
	38°C	S

* run capacitor 4 µF compulsory

Design

Displacement	cm ³	6.49
Oil quantity	cm ³	180
Maximum refrigerant charge	g	150
Free gas vol. in compressor	cm ³	1790
Weight without electrical equipment	kg	8.3

Motor

Motor size	watt	65
LRA (rated after 4 sec. UL984) LST	A	2.3
Cut-in current LST	A	6.6
Resistance, main and start winding (25°C)	Ω	30.0/15.0
Approvals	EN 60335-2-34 with Annex AA	

Dimensions

Height	mm	A	173
		B	169
Suction connector	location/I.D. mm	C	6.2 ±0.09
Process connector	location/I.D. mm	D	6.2 ±0.09
Discharge connector	location/I.D. mm	E	5.0 +0.12/+0.20
Compressors on a pallet	pcs.		125

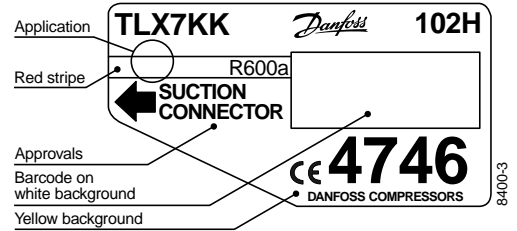

- S = Static cooling normally sufficient
- O = Oil cooling
- F₁ = Fan cooling 1.5 m/s
(compressor compartment temperature equal to ambient temperature)
- F₂ = Fan cooling 3.0 m/s necessary

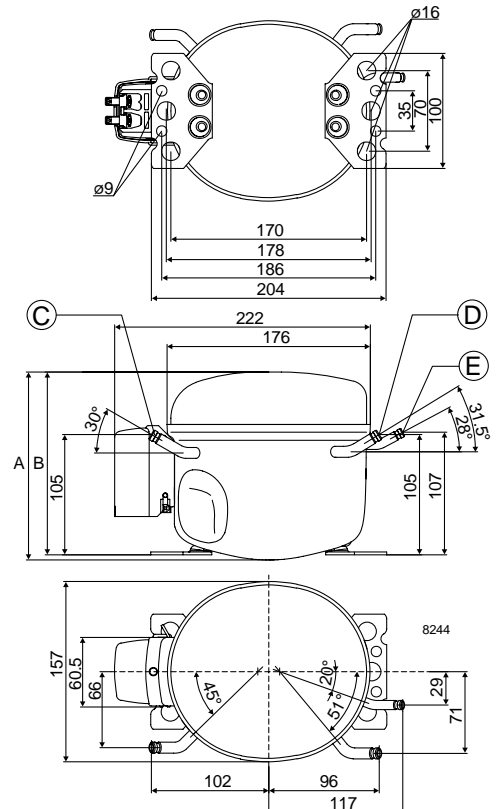

Capacity (EN 12900/CECOMAF)

watt

Comp.°C	-35	-30	-25	-23.3	-20	-15	-10
TLX7KK	41.5	57.6	77.0	84.4	100	128	160

Capacity (ASHRAE)

watt

Comp.°C	-35	-30	-25	-23.3	-20	-15	-10
TLX7KK	50.4	70.1	93.7	103	122	156	195

Power consumption

watt

Comp.°C	-35	-30	-25	-23.3	-20	-15	-10
TLX7KK	49.7	58.7	67.0	69.8	75.2	83.8	93.5

Current consumption

A

Comp.°C	-35	-30	-25	-23.3	-20	-15	-10
TLX7KK	0.25	0.28	0.31	0.33	0.35	0.40	0.45

COP (EN 12900/CECOMAF)

W/W

Comp.°C	-35	-30	-25	-23.3	-20	-15	-10
TLX7KK	0.83	0.98	1.15	1.21	1.33	1.52	1.71

COP (ASHRAE)

W/W

Comp.°C	-35	-30	-25	-23.3	-20	-15	-10
TLX7KK	1.02	1.19	1.40	1.47	1.62	1.86	2.09

Test conditions	EN 12900/CECOMAF	ASHRAE
Condensing temperature	55°C	55°C
Ambient and suction gas temp.	32°C	32°C
Liquid temperature	55°C	32°C
Static cooling, with RC 4 µF, 220V 50Hz, PTC consumption incl.		

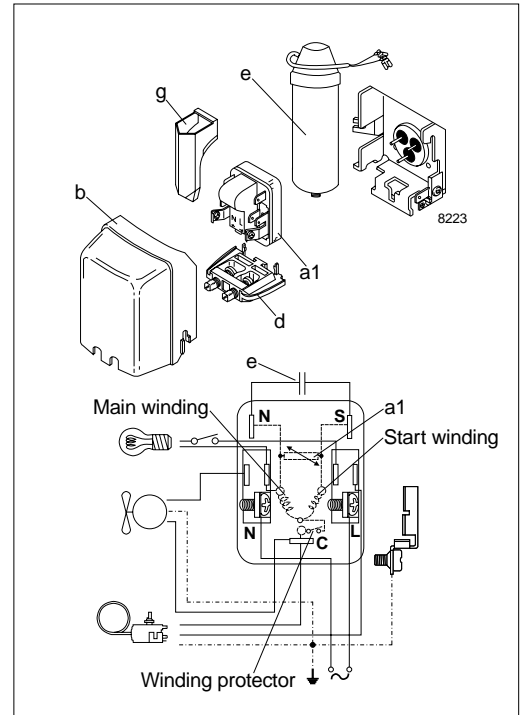

Accessories

Devices	Fig.	TLX7KK
PTC starting device 6.3 mm spades 4.8 mm spades	a1	103N0016 103N0021
Cover	b	103N2010
Cord relief	d	103N1010
Run capacitor 4 µF (compulsory) 6.3 mm spades 4.8 mm spades	e	117-7117 117-7119
Protection screen for PTC	g	103N0476
Mounting accessories Bolt joint for one compressor Bolt joint in quantities Snap-on in quantities		118-1917 118-1918 118-1919