

TLY4F

High Energy-optimized Compressor

R134a

220-240V 50Hz

Data Sheet (Replaces CD.42M7.02)

General

Compressor	TLY4F
Code number	102G4441

Application

Application	LBP	
Evaporating temperature range	°C	-35 to -10
Voltage range	V/Hz	198 - 254 /50
Motor type	RSCR/RSIR	
Max. ambient temperature	°C	43
Comp. cooling at ambient temp.	32°C	S
	38°C	S
	43°C	S

Design

Displacement	cm ³	3.86
Oil quantity	cm ³	180
Maximum refrigerant charge	g	400
Free gas vol. in compressor	cm ³	1790
Weight without electrical equipment	kg	7.6

Motor

Motor size	watt	80
LRA (rated after 4 sec. UL984) LST	A	2.9
Cut-in current LST	A	7.6
Resistance, main and start winding (25°C)	Ω	25.7/15.7
Approvals	EN 60335-2-34 with Annex AA	

Dimensions

Height	mm	A	173
		B	169
Suction connector	location/I.D. mm	C	6.2 ±0.09
Process connector	location/I.D. mm	D	6.2 ±0.09
Discharge connector	location/I.D. mm	E	5.0 +0.12/+0.20
Compressors on a pallet	pcs.		125

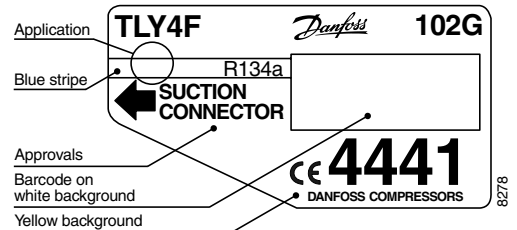

- S = Static cooling normally sufficient
- O = Oil cooling
- F₁ = Fan cooling 1.5 m/s
(compressor compartment temperature equal to ambient temperature)
- F₂ = Fan cooling 3.0 m/s necessary

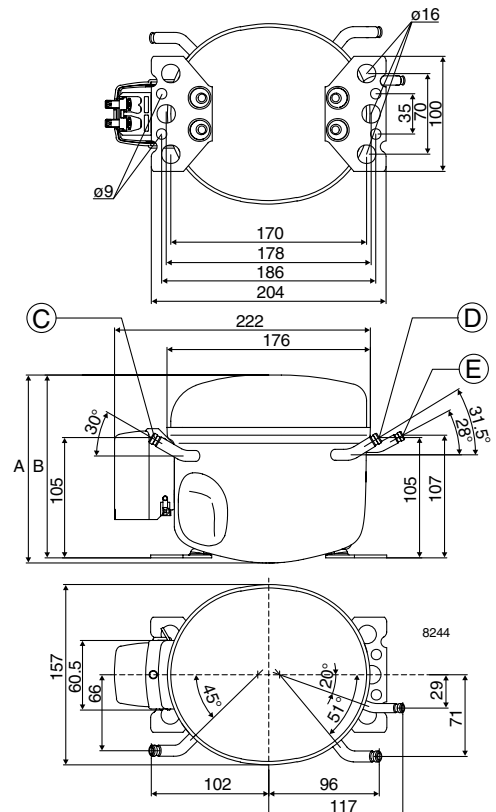

Capacity (EN 12900/CECOMAF)

watt

Comp. \ °C	-35	-30	-25	-23.3	-20	-15	-10
TLY4F	34.6	51.5	72.0	79.9	96.8	126	162

Capacity (ASHRAE)

watt

Comp. \ °C	-35	-30	-25	-23.3	-20	-15	-10
TLY4F	42.6	63.5	88.9	98.6	119	156	200

Power consumption

watt

Comp. \ °C	-35	-30	-25	-23.3	-20	-15	-10
TLY4F	54.4	63.4	73.0	76.5	83.6	95.2	108

Current consumption

A

Comp. \ °C	-35	-30	-25	-23.3	-20	-15	-10
TLY4F	0.27	0.31	0.36	0.37	0.41	0.46	0.52

COP (EN 12900/CECOMAF)

W/W

Comp. \ °C	-35	-30	-25	-23.3	-20	-15	-10
TLY4F	0.63	0.81	0.99	1.04	1.16	1.33	1.49

COP (ASHRAE)

W/W

Comp. \ °C	-35	-30	-25	-23.3	-20	-15	-10
TLY4F	0.78	1.00	1.22	1.29	1.43	1.64	1.85

Test conditions EN 12900/CECOMAF ASHRAE
 Condensing temperature 55°C 55°C
 Ambient and suction gas temp. 32°C 32°C
 Liquid temperature 55°C 32°C
 Static cooling, with RC 4 µF, 220V 50Hz,
 PTC consumption included (two watt power consumption to be subtracted,
 when ePTC is used; this is also affecting the COP)

Accessories

Devices	Fig.	TLY4F
PTC starting device 6.3 mm spades 4.8 mm spades	a1 (pos.1)	103N0011
		103N0018
ePTC starting device 4.8 mm spades	a1 (pos.2)	103N0050
PTC starting device 6.3 mm spades 4.8 mm spades		103N0016 103N0021
Cover	b	103N2010
Cord relief	d	103N1010
Run capacitor 4 µF (optional) 6.3 mm spades 4.8 mm spades	e	117-7117
		117-7119
Protection screen for PTC	g	103N0476
Mounting accessories		
Bolt joint for one compressor		118-1917
Bolt joint in quantities		118-1918
Snap-on in quantities		118-1919

