

# SC12FTX Tropical Compressor R134a 115-127V 60Hz



## General

Code number	104G7205
Approvals	UL984
Compressors on pallet	80

## Application

Application	LBP/MBP			
	Hz	50	60	
Frequency	Hz	50	60	
Evaporating temperature	°F	-	-31 to 23	
Voltage range	V	-	95 - 135	
Max. condensing temperature continuous (short)	°F	-	140 (158)	
Max. winding temperature continuous (short)	°F	-	257 (275)	

## Cooling requirements

Frequency	Hz	50			60		
		LBP	MBP	HBP	LBP	MBP	HBP
90°F		-	-	-	F <sub>2</sub>	F <sub>2</sub>	-
100°F		-	-	-	F <sub>2</sub>	F <sub>2</sub>	-
110°F		-	-	-	F <sub>2</sub>	F <sub>2</sub>	-

Remarks on application: Not applicable below -20°F evaporating temperature in 110°F ambient temperature above 127V.

## Motor

Motor type	CSIR		
LRA (rated after 4 sec. UL984), HST   LST	A	38.2	-
Cut in Current, HST   LST	A	38.2	-
Resistance, main   start winding (77°F)	Ω	1.2	4.2

## Design

Displacement	cu.in	0.78
Oil quantity (type)	fl.oz.	20.3 (polyolester)
Maximum refrigerant charge	oz.	45.5
Free gas volume in compressor	fl.oz.	49.4
Weight without electrical equipment	lbs.	27.7

## Dimensions

Height	inch	A	8.23
		B	8.00
Suction connector	location, I.D. in.   angle	C	0.320-0.327   37°
		material   comment	Cu-plated steel   Al cap
Process connector	location, I.D. in.   angle	D	0.252-0.259   37°
		material   comment	Cu-plated steel   Al cap
Discharge connector	location, I.D. in.   angle	E	0.252-0.259   37°
		material   comment	Cu-plated steel   Al cap
Oil cooler connector	location, I.D. in.   angle	F	-
		material   comment	-
Remarks:			

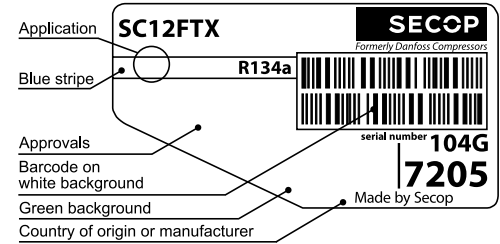

- S = Static cooling normally sufficient
- O = Oil cooling
- F<sub>1</sub> = Fan cooling 1.5 m/s (compressor compartment temperature equal to ambient temperature)
- F<sub>2</sub> = Fan cooling 3.0 m/s necessary
- SG = Suction gas cooling normally sufficient
- = not applicable in this area

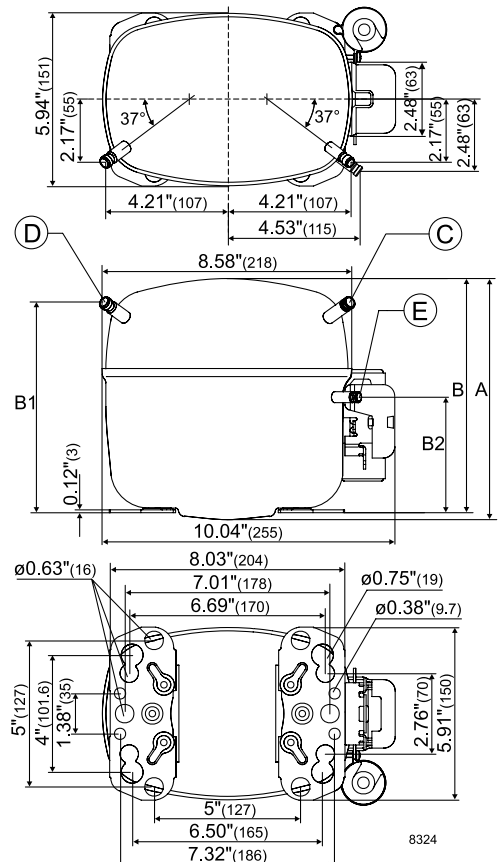

**ASHRAE**

115V, 60Hz, fan cooling F<sub>2</sub>

Evap. temp. in °F	-49	-40	-30	-20	-13	-10	0	10	14	20	30	40	41	45	50	59	68
Capacity in BTU/h			563	889	1155	1280	1753	2324	2583	3008							
Power cons. in W			244	302	343	360	419	478	502	537							
Current cons. in A			5.01	5.28	5.48	5.57	5.88	6.20	6.34	6.55							
EER in BTU/Wh			2.30	2.94	3.37	3.55	4.18	4.86	5.15	5.60							

**EN 12900 Household (CECOMAF)**

115V, 60Hz, fan cooling F<sub>2</sub>

Evap. temp. in °F	-49	-40	-30	-20	-13	-10	0	10	14	20	30	40	41	45	50	59	68
Capacity in W			132	210	273	303	415	549	610	710							
Power cons. in W			244	302	343	360	419	478	502	537							
Current cons. in A			5.01	5.28	5.48	5.57	5.88	6.20	6.34	6.55							
COP in W/W			0.54	0.70	0.80	0.84	0.99	1.15	1.21	1.32							

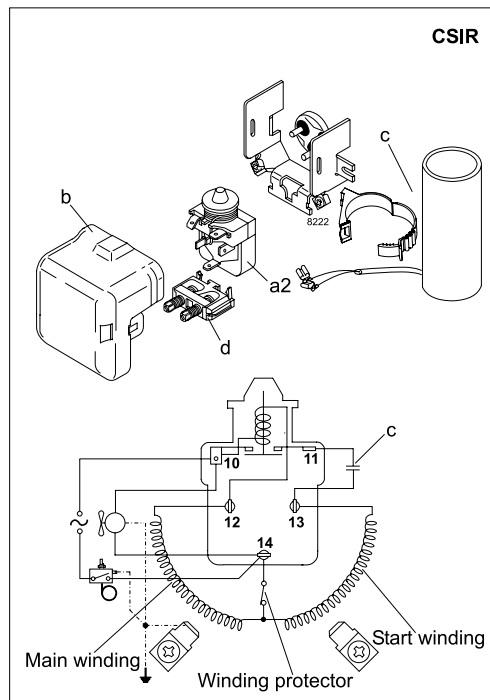

Accessories for	SC12FTX	Figure	Code number
PTC starting device	1/4 in. spade connect.	-	-
	3/16 in. spade connect.	-	-
Starting relay	1/4 in. spade connect.	a2	117U6012
Cover		b	103N2008
Start. capacitor 240 µF	1/4 in. spade connect.	c	117U5023
Cord relief		d	103N1004
Protection screen for PTC		-	-

Test conditions	ASHRAE	EN 12900/CECOMAF
Condensing temp.	130°F	131°F
Ambient temperature	90°F	90°F
Suction gas temp.	90°F	90°F
Liquid temperature	90°F	131°F

Mounting accessories		Code number
Bolt joint for one comp.	Ø: 5/8 in.	118-1917
Bolt joint in quantities	Ø: 5/8 in.	118-1918
Snap-on in quantities	Ø: 5/8 in.	118-1919

Danfoss can accept no responsibility for possible errors in catalogues, brochures and other printed material. Danfoss reserves the right to alter its products without notice. This also applies to products already on order provided that such alterations can be made without subsequential changes being necessary in specifications already agreed. All trademarks in this material are property of the respective companies. Danfoss and the Danfoss logotype are trademarks of Danfoss A/S. All rights reserved.