

TTE4.6FK

Energy-optimized Compressor

R134a

115V 60Hz



General

Code number	102G3448
Approvals	UL984
Compressors on pallet	125

Application

Application	LBP			
Frequency	Hz	50	60	
Evaporating temperature	°F	-	-31 to 14	
Voltage range	V	-	103 - 127	
Max. condensing temperature continuous (short)	°F	-	140 (158)	
Max. winding temperature continuous (short)	°F	-	257 (257)	

Cooling requirements

Frequency	Hz	50			60		
Application		LBP	MBP	HBP	LBP	MBP	HBP
90°F		-	-	-	S	-	-
100°F		-	-	-	S	-	-
110°F		-	-	-	S	-	-
Remarks on application:							

Motor

Motor type	RSCR		
LRA (rated after 4 sec. UL984), HST LST	A	-	9.5
Cut in Current, HST LST	A	-	18.0
Resistance, main start winding (77°F)	Ω	3.7	5.4

Design

Displacement	cu.in	0.28
Oil quantity (type)	fl.oz.	6.1 (polyolester)
Maximum refrigerant charge	oz.	14.0
Free gas volume in compressor	fl.oz.	60.6
Weight without electrical equipment	lbs.	16.5

Dimensions

Height	inch	A	6.81
		B	6.65
		B1	-
		B2	-
Suction connector	location, I.D. in. angle	C	0.252-0.259 30°
	material comment		Cu-plated steel Al cap
Process connector	location, I.D. in. angle	D	0.252-0.259 31.5°
	material comment		Cu-plated steel Al cap
Discharge connector	location, I.D. in. angle	E	0.202-0.205 28°
	material comment		Cu-plated steel Al cap
Oil cooler connector	location, I.D. in. angle	F	-
	material comment		-
Remarks:			

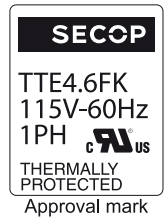
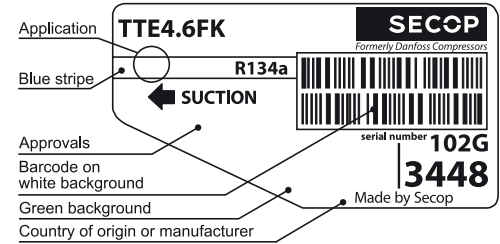

- S = Static cooling normally sufficient
- O = Oil cooling
- F₁ = Fan cooling 1.5 m/s (compressor compartment temperature equal to ambient temperature)
- F₂ = Fan cooling 3.0 m/s necessary
- SG = Suction gas cooling normally sufficient
- = not applicable in this area

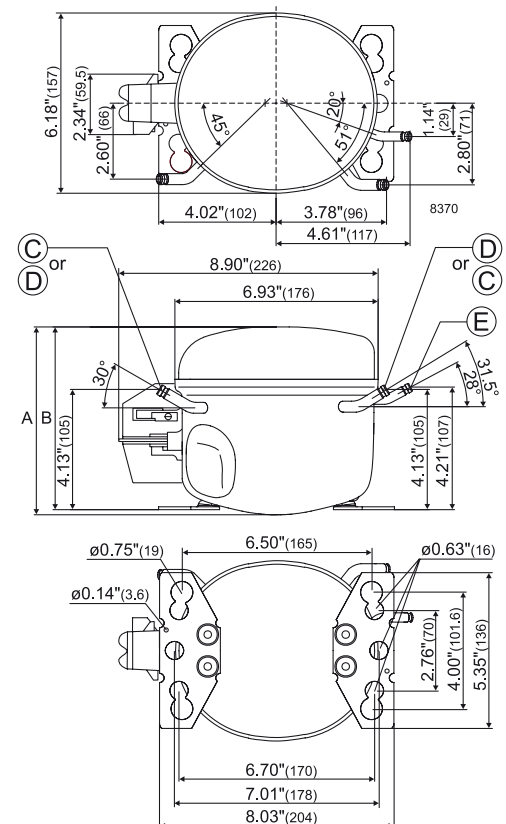

ASHRAE LBP

Static cooling, with RC 15µF, 115V 60Hz, PTC consumption incl., preliminary data

Evap. temp. in °F	-49	-40	-30	-20	-13	-10	0	10	14	20	30	40	41	45	50	59	68
Capacity in BTU/h			219			488		866									
Power cons. in W			72			105		142									
Current cons. in A			0.62			0.92		1.24									
EER in BTU/Wh			3.05			4.65		6.24									

EN 12900 Household (CECOMAF)

Static cooling, with RC 15µF, 115V 60Hz, PTC consumption incl., preliminary data

Evap. temp. in °F	-49	-40	-30	-20	-13	-10	0	10	14	20	30	40	41	45	50	59	68
Capacity in W			52			117		212									
Power cons. in W			72			105		142									
Current cons. in A			0.62			0.92		1.24									
COP in W/W			0.72			1.11		1.49									

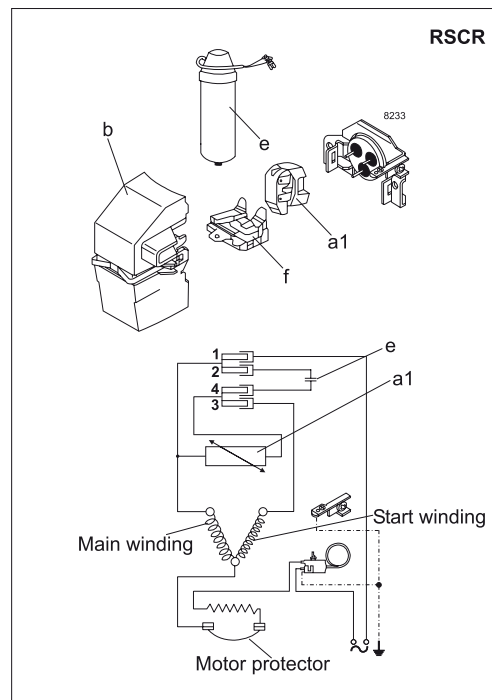

Accessories for	TTE4.6FK	Figure	Code number
PTC starting device (Siemens) with reduced loss of energy		a1	117U6106
			J506-A120-A320
Cover		b	117U1026
Run capacitor 15 µF (compulsory)		e	117-7118
Protector (Texas Instruments)		f	117U3302
			TI-4TM314NFBYY-53

Test conditions	ASHRAE LBP	EN 12900/CECOMAF
Condensing temp.	130°F	131°F
Ambient temp.	90°F	90°F
Suction gas temp.	90°F	90°F
Liquid temperature	90°F	131°F

Mounting accessories	Code number
Bolt joint for one comp. Ø: 5/8 in.	118-1917
Bolt joint in quantities Ø: 5/8 in.	118-1918
Snap-on in quantities Ø: 5/8 in.	118-1919

Danfoss can accept no responsibility for possible errors in catalogues, brochures and other printed material. Danfoss reserves the right to alter its products without notice. This also applies to products already on order provided that such alterations can be made without subsequential changes being necessary in specifications already agreed. All trademarks in this material are property of the respective companies. Danfoss and the Danfoss logotype are trademarks of Danfoss A/S. All rights reserved.