

Datasheets

NLE11CNL Energy-optimized LBP R290 220-240V 50Hz

General

| | |
|-----------------------|---------------------------|
| Code number | 105H6174 |
| Approvals | EN 60335-2-34 w. Annex AA |
| Compressors on pallet | 80 |

Application

| Application | LBP | | |
|--|-----|------------|----|
| Frequency | Hz | 50 | 60 |
| Evaporating temperature | °C | -35 to -10 | - |
| Voltage range | V | 198 to 254 | - |
| Max. condensing temperature continuous (short) | °C | 60 (70) | - |
| Max. winding temperature continuous (short) | °C | 125 (135) | - |

Cooling requirements

| Frequency | Hz | 50 | | | 60 | | |
|-------------------------|----|----------------|-----|-----|-----|-----|-----|
| Application | | LBP | MBP | HBP | LBP | MBP | HBP |
| 32°C | | F ₂ | - | - | - | - | - |
| 38°C | | F ₂ | - | - | - | - | - |
| 43°C | | F ₂ | - | - | - | - | - |
| Remarks on application: | | | | | | | |

Motor

| Motor type | CSIR/RSIR | | |
|---|-----------|------|------|
| LRA (rated after 4 sec. UL984), HST LST | A | 13.8 | 12.6 |
| Cut in Current, HST LST | A | 13.8 | 17.1 |
| Resistance, main start winding (25°C) | Ω | 8.0 | 18.0 |

Design

| | | |
|-------------------------------------|-----------------|-------------------|
| Displacement | cm ³ | 11.15 |
| Oil quantity (type) | cm ³ | 320 (polyolester) |
| Maximum refrigerant charge | g | 150 |
| Free gas volume in compressor | cm ³ | 2360 |
| Weight without electrical equipment | kg | 12.1 |

Dimensions

| | | | |
|----------------------|--------------------------|----|--------------------------|
| Height | mm | A | 203 |
| | | B | 197 |
| | | B1 | - |
| | | B2 | - |
| Suction connector | location/I.D. mm angle | C | 8.2 15° |
| | material comment | | Cu-plated steel Al cap |
| Process connector | location/I.D. mm angle | D | 6.2 25° |
| | material comment | | Cu-plated steel Al cap |
| Discharge connector | location/I.D. mm angle | E | 6.2 21° |
| | material comment | | Cu-plated steel Al cap |
| Oil cooler connector | location/I.D. mm angle | F | - |
| | material comment | | - |
| Connector tolerance | I.D. mm | | ±0.09 |
| Remarks: | | | |

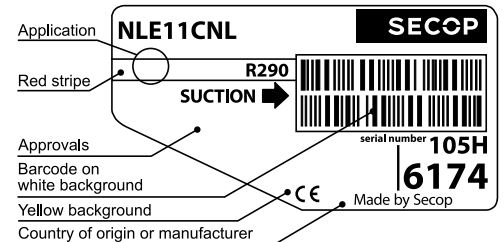

Yellow warning label

- S = Static cooling normally sufficient
- O = Oil cooling
- F₁ = Fan cooling 1.5 m/s (compressor compartment temperature equal to ambient temperature)
- F₂ = Fan cooling 3.0 m/s necessary
- SG = Suction gas cooling normally sufficient
- = not applicable in this area

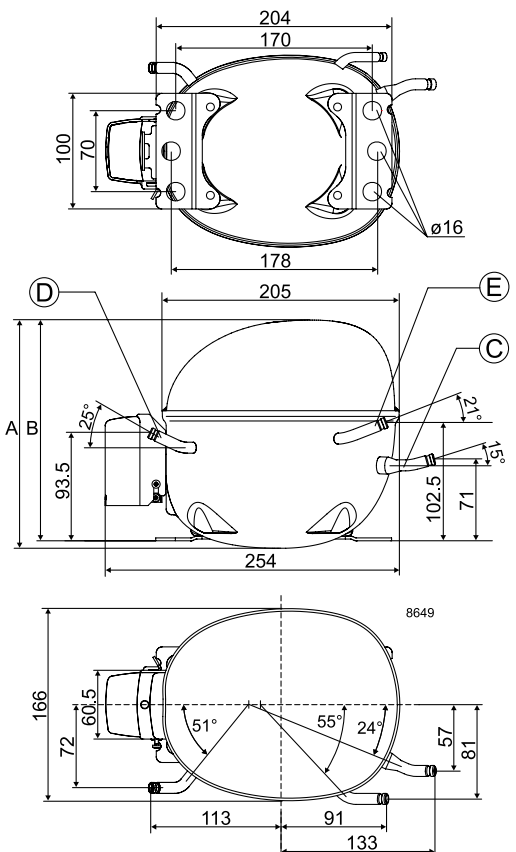

EN 12900 LBP 220V, 50Hz, fan cooling F₂

| | | | | | | | | | | | | | | | | | |
|--------------------|-----|-----|------|------|------|-------|------|------|------|------|----|---|---|-----|----|----|----|
| Evap. temp. in °C | -45 | -40 | -35 | -30 | -25 | -23.3 | -20 | -15 | -10 | -6.7 | -5 | 0 | 5 | 7.2 | 10 | 15 | 20 |
| Capacity in W | | | 309 | 398 | 505 | 545 | 630 | 774 | 938 | | | | | | | | |
| Power cons. in W | | | 270 | 302 | 335 | 347 | 369 | 404 | 437 | | | | | | | | |
| Current cons. in A | | | 1.95 | 2.02 | 2.12 | 2.15 | 2.22 | 2.33 | 2.45 | | | | | | | | |
| COP in W/W | | | 1.15 | 1.32 | 1.50 | 1.57 | 1.71 | 1.92 | 2.14 | | | | | | | | |

EN 12900 MBP 220V, 50Hz, fan cooling F₂

| | | | | | | | | | | | | | | | | | |
|--------------------|-----|-----|------|------|------|-------|------|------|------|------|----|---|---|-----|----|----|----|
| Evap. temp. in °C | -45 | -40 | -35 | -30 | -25 | -23.3 | -20 | -15 | -10 | -6.7 | -5 | 0 | 5 | 7.2 | 10 | 15 | 20 |
| Capacity in W | | | 285 | 367 | 466 | 504 | 583 | 718 | 872 | | | | | | | | |
| Power cons. in W | | | 274 | 308 | 344 | 356 | 381 | 420 | 458 | | | | | | | | |
| Current cons. in A | | | 1.96 | 2.04 | 2.14 | 2.18 | 2.25 | 2.38 | 2.52 | | | | | | | | |
| COP in W/W | | | 1.04 | 1.19 | 1.36 | 1.41 | 1.53 | 1.71 | 1.90 | | | | | | | | |

ASHRAE LBP 220V, 50Hz, fan cooling F₂

| | | | | | | | | | | | | | | | | | |
|--------------------|-----|-----|------|------|------|-------|------|------|------|------|----|---|---|-----|----|----|----|
| Evap. temp. in °C | -45 | -40 | -35 | -30 | -25 | -23.3 | -20 | -15 | -10 | -6.7 | -5 | 0 | 5 | 7.2 | 10 | 15 | 20 |
| Capacity in W | | | 300 | 390 | 499 | 540 | 628 | 778 | 950 | | | | | | | | |
| Power cons. in W | | | 267 | 303 | 342 | 356 | 383 | 427 | 472 | | | | | | | | |
| Current cons. in A | | | 1.97 | 2.06 | 2.18 | 2.22 | 2.32 | 2.48 | 2.65 | | | | | | | | |
| COP in W/W | | | 1.12 | 1.29 | 1.46 | 1.52 | 1.64 | 1.82 | 2.01 | | | | | | | | |

ASHRAE MBP/HBP 220V, 50Hz, fan cooling F₂

| | | | | | | | | | | | | | | | | | |
|--------------------|-----|-----|------|------|------|-------|------|------|------|------|----|---|---|-----|----|----|----|
| Evap. temp. in °C | -45 | -40 | -35 | -30 | -25 | -23.3 | -20 | -15 | -10 | -6.7 | -5 | 0 | 5 | 7.2 | 10 | 15 | 20 |
| Capacity in W | | | 271 | 352 | 450 | 488 | 567 | 702 | 857 | | | | | | | | |
| Power cons. in W | | | 267 | 303 | 342 | 356 | 383 | 427 | 472 | | | | | | | | |
| Current cons. in A | | | 1.97 | 2.06 | 2.18 | 2.22 | 2.32 | 2.48 | 2.65 | | | | | | | | |
| COP in W/W | | | 1.01 | 1.16 | 1.32 | 1.37 | 1.48 | 1.65 | 1.82 | | | | | | | | |

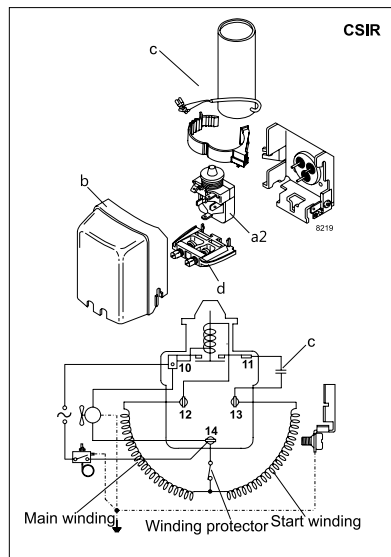
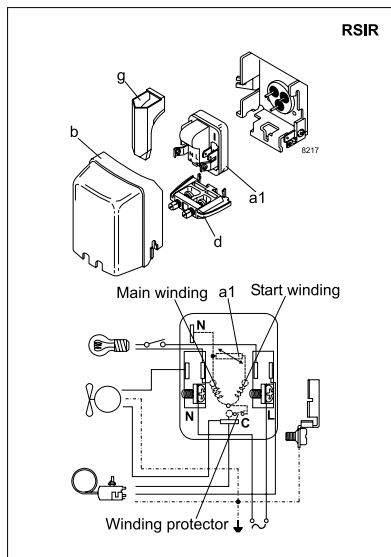

| Accessories for | NLE11CNL | Figure | Code number |
|---------------------------|-------------------------|--------|-------------|
| PTC starting device | 6.3 mm spade connectors | a1 | - |
| | 4.8 mm spade connectors | | - |
| ePTC starting device | 4.8 mm spade connectors | | 103N0050 |
| Starting relay | 6.3 mm spade connectors | a2 | 117U7003 |
| Start. capacitor 80 µF | 6.3 mm spade connectors | c | 117U5015 |
| Cover | | b | 103N2010 |
| Cord relief | | d | 103N1010 |
| Protection screen for PTC | | g | - |

| Test conditions | EN 12900 | | ASHRAE | |
|-------------------------|---------------|------|--------|--------|
| | LBP | MBP | LBP | MBP |
| Condensing temperature | 40°C | 45°C | 54.4°C | 54.4°C |
| Ambient temperature | 32°C | 32°C | 32.2°C | 35°C |
| Suction gas temperature | 20°C | 20°C | 32.2°C | 35°C |
| Liquid temperature | no subcooling | | 32.2°C | 46.1°C |

| Mounting accessories | Code number | |
|--------------------------|-------------|----------|
| Bolt joint for one comp. | Ø: 16 mm | 118-1917 |
| Bolt joint in quantities | Ø: 16 mm | 118-1918 |
| Snap-on in quantities | Ø: 16 mm | 118-1919 |

Danfoss can accept no responsibility for possible errors in catalogues, brochures and other printed material. Danfoss reserves the right to alter its products without notice. This also applies to products already on order provided that such alterations can be made without subsequent changes being necessary in specifications already agreed. All trademarks in this material are property of the respective companies. Danfoss and the Danfoss logotype are trademarks of Danfoss A/S. All rights reserved.