

4

3

2

1

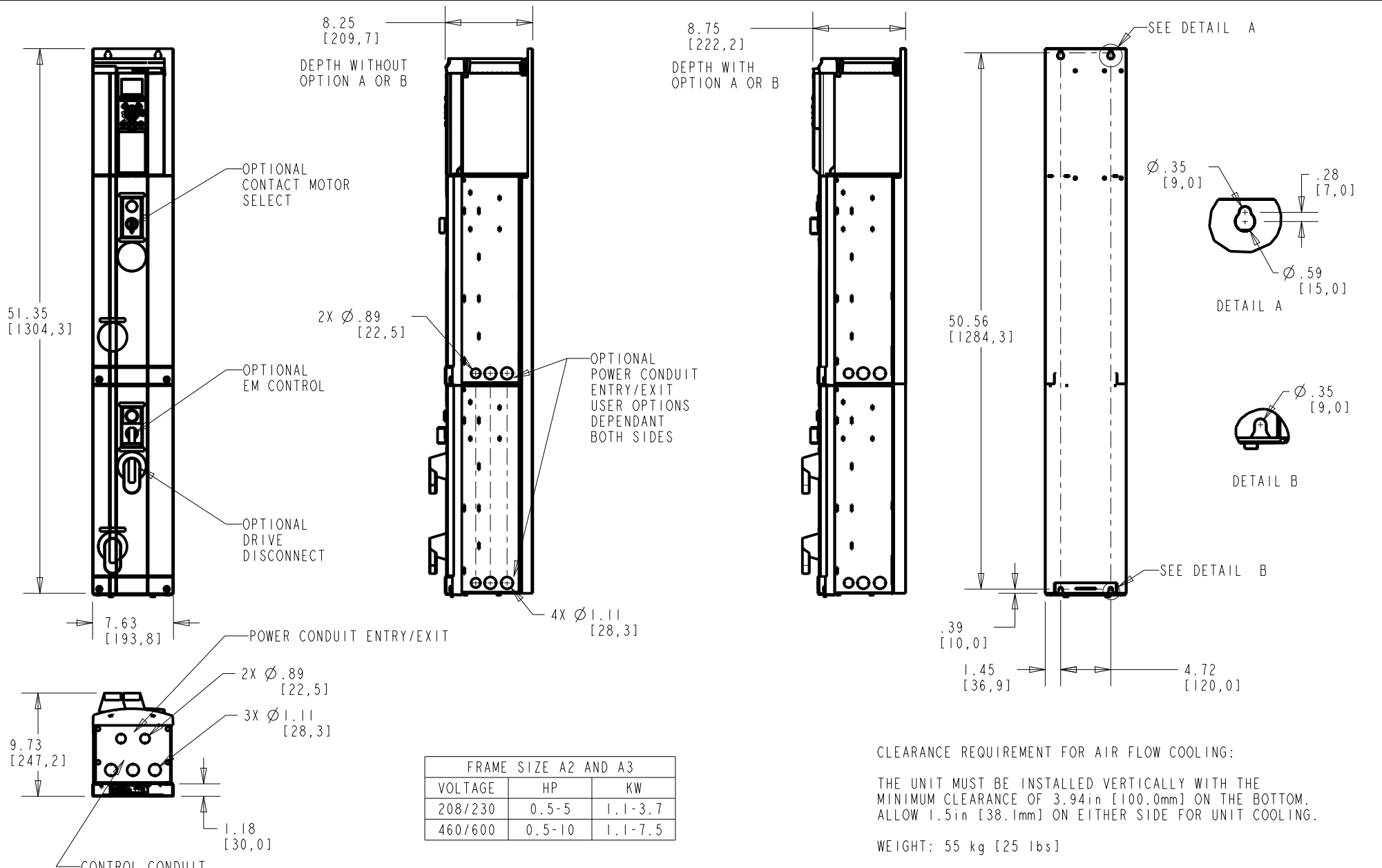

FRAME SIZE A2 AND A3		
VOLTAGE	HP	KW
208/230	0.5-5	1.1-3.7
460/600	0.5-10	1.1-7.5

CLEARANCE REQUIREMENT FOR AIR FLOW COOLING:
 THE UNIT MUST BE INSTALLED VERTICALLY WITH THE MINIMUM CLEARANCE OF 3.94in [100.0mm] ON THE BOTTOM. ALLOW 1.5in [38.1mm] ON EITHER SIDE FOR UNIT COOLING.
 WEIGHT: 55 kg [25 lbs]

-NOTICE- THIS DRAWING IS PROPRIETARY AND SHALL NOT BE COPIED OR ITS CONTENTS DISCLOSED TO OUTSIDE PARTIES WITHOUT THE WRITTEN CONSENT OF THE TRANE COMPANY		PRO-E ENTRY BY/DATE: MN 10/11/08	CHECKED BY/DATE:	THE TRANE COMPANY TITLE: DWG, REF, SUBMITTAL, A2-A3-TIER 3	
		DESIGNED BY/DATE: MN 10/11/08	MFG. APPROVAL BY/DATE:		
LATEST E.C.N. NO.: SPI0100		E.C.N. PRO-E ENTRY BY/DATE: SAK 09/01/10	APPROVAL:	ENG. APPROVAL BY/DATE:	SHEET: OF: DRAWING NO.: 174N3456
		PLOT SCALE: NONE	PRO-E FILE:		REV.: A

4

3

2

1