

Name plate:

**VLT®** MCE101 Brake Resistor  
www.danfoss.com

T/C: MCE101xxxxxPxxxxE65TAW  
P/N: 175Uxxxx S/N: 456001-443  
xxxR±10% Average power. xxxkW  
xxxxW/xxxxW@ 10%/40% duty cycle of 30s  
IP65 Tamb.= 40°C xxkg

\*175U0000456001-443\*

MADE IN DENMARK

CBR-Vxxx BT 914 xxxR KT  
Zxxxxxxxx914 Pr.no:123456 E208678 C

Thermo Switch Connection:  
Marked: T1/T2  
Type: PHOENIX G5/2 with Screw Connection.  
IEC: 0,2-4 mm<sup>2</sup> / 500V  
UL: AWG 24 -12 / 300V  
Wire Stripping: 8 mm (0.31 in)  
Torque: 0.7 Nm (6.2 lb-in)

For temperature Switch Cable:  
Clamping Range: 3.5-7.0 mm (0.14-0.28 lb-in)

For resistor cable:  
Cable gland with internal connection for braid  
Clamping Range: 9.0-16.5 mm (0.35-0.65 in)

Resistor connection:  
Marked RB1 / RB2  
Type: PHOENIX G10/2  
IEC: 0,5 - 10 mm<sup>2</sup> / 800V  
UL: AWG 20 - 6 / 600V  
Wire Stripping: 12 mm (0.47 in)  
Torque: 1.5-1.8 Nm (13.28-15.94 lb-in)

PE M4  
Torque 2-3 Nm  
(17.71-26.57 lb-in)

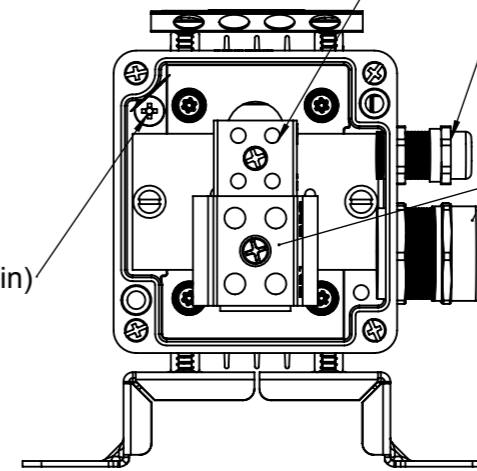

Danfoss code	Typecode	Ohm	L±2, mm	L±0.08, in	L1±2, mm	L1±0.08, in	Weight, kg	Center of mass, mm		
								X	Y	Z
175U3010	MCE101A200RP360RE65TAW	200	210	8.27	110	4.33	1.8	32	49	64
175U3013	MCE101A145RP450RE65TAW	145	260	10.24	160	6.3	2.4	52	49	64
175U3015	MCE101A145RP280RE65TAW	145	160	6.3	70	2.76	1.3	9	49	62
175U3018	MCE101A110RP360RE65TAW	110	210	8.27	110	4.33	1.8	32	49	64
175U3020	MCE101A105RP570RE65TAW	105	330	12.99	230	9.06	3	86	50	65
175U3023	MCE101A80R0P450RE65TAW	80	260	10.24	160	6.3	2.4	52	49	64
175U3025	MCE101A72R0P960RE65TAW	72	560	22.05	460	18.11	4.6	199	50	67
175U3028	MCE101A56R0P680RE65TAW	56	400	15.75	300	11.81	3.5	120	50	66
175U3030	MCE101A52R0P1K29E65TAW	52	760	29.92	660	25.98	6.1	298	50	67
175U3035	MCE101A38R0P1K13E65TAW	38	660	25.98	560	22.05	5.4	248	50	67
175U3042	MCE101A27R0P280RE65TAW	27	160	6.3	70	2.76	1.3	9	49	62
175U3054	MCE101A18R0P450RE65TAW	18	260	10.24	160	6.3	2.4	52	49	64
175U3060	MCE101A13R0P680RE65TAW	13	400	15.75	300	11.81	3.5	120	50	66
175U3069	MCE101A9R00P1K13E65TAW	9	660	25.98	560	22.05	5.4	248	50	67
175U3103	MCE101A1K20P360RE65TAW	1200	210	8.27	110	4.33	1.8	32	49	64
175U3105	MCE101A850RP280RE65TAW	850	160	6.3	70	2.76	1.3	9	49	62
175U3109	MCE101A630RP360RE65TAW	630	210	8.27	110	4.33	1.8	32	49	64
175U3111	MCE101A570RP570RE65TAW	570	330	12.99	230	9.06	3	86	50	65
175U3113	MCE101A415RP790RE65TAW	415	460	18.11	360	14.17	3.9	149	50	66
175U3115	MCE101A410RP570RE65TAW	410	330	12.99	230	9.06	3	86	50	65
175U3117	MCE101A270RP790RE65TAW	270	460	18.11	360	14.17	3.9	149	50	66
175U3119	MCE101A270RP1K13E65TAW	270	660	25.98	560	22.05	5.4	248	50	67
175U3121	MCE101A200RP1K13E65TAW	200	660	25.98	560	22.05	5.4	248	50	67
175U3125	MCE101A145RP450RE65TAW	145	260	10.24	160	6.3	2.4	52	49	64
175U3137	MCE101A100RP570RE65TAW	100	330	12.99	230	9.06	3	86	50	65
175U3145	MCE101A70R0P790RE65TAW	70	460	18.11	360	14.17	3.9	149	50	66
175U3401	MCE101A100RP450RE65TAW	100	260	10.24	160	6.3	2.4	52	49	64
175U3403	MCE101A70R0P570RE65TAW	70	330	12.99	230	9.06	3	86	50	65
175U3405	MCE101A48R0P960RE65TAW	48	560	22.05	460	18.11	4.6	199	50	67
175U3407	MCE101A35R0P1K13E65TAW	35	660	25.98	560	22.05	5.4	248	50	67
175U3415	MCE101A410RP450RE65TAW	410	260	10.24	160	6.3	2.4	52	49	64
175U3417	MCE101A270RP570RE65TAW	270	330	12.99	230	9.06	3	86	50	65
175U3419	MCE101A200RP960RE65TAW	200	560	22.05	460	18.11	4.6	199	50	67
175U3421	MCE101A145RP1K13E65TAW	145	660	25.98	560	22.05	5.4	248	50	67
175U3429	MCE101A570RP450RE65TAW	570	260	10.24	160	6.3	2.4	52	49	64
175U3431	MCE101A415RP570RE65TAW	415	330	12.99	230	6.09	3	86	50	65
175U3433	MCE101A270RP960RE65TAW	270	560	22.05	460	18.11	4.6	199	50	67
175U3435	MCE101A200RP1K13E65TAW	200	660	25.98	560	22.05	5.4	248	50	67
175U3441	MCE101A18R0P570RE65TAW	18	330	12.99	230	9.06	3	86	50	65
175U3449	MCE101A110RP450RE65TAW	110	260	10.24	160	6.3	2.4	52	49	64
175U3451	MCE101A80R0P570RE65TAW	80	330	12.99	230	9.06	3	86	50	65
175U3455	MCE101A72R0P680RE65TAW	72	400	15.75	300	11.81	3.5	120	50	66
175U3457	MCE101A52R0P1K13E65TAW	52	660	25.98	560	22.05	5.4	248	50	67
175U3465	MCE101A72R0P1K13E65TAW	72	660	25.98	560	22.05	5.4	248	50	67
175U3478	MCE101A27R0P360RE65TAW	27	210	8.27	110	4.33	1.8	32	49	64
175U3482	MCE101A105RP790RE65TAW	105	460	18.11	360	14.17	3.9	149	50	66

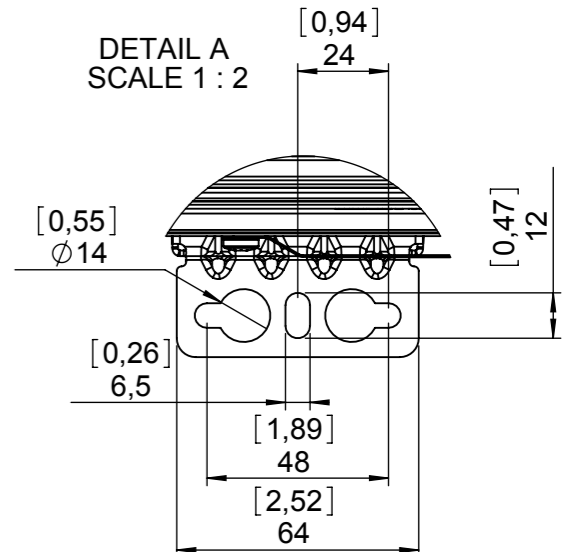
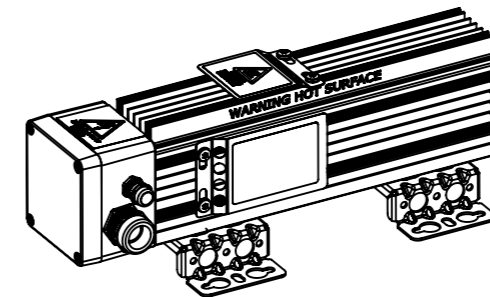

**Danfoss** Danfoss A/S  
Power Electronics Division  
Ulsnæs 1, 6300 Graasten  
Denmark

**MCE 101 Brake Resistor**  
xxR ± 10% 914 IP65  
175C0631

Weight (g)	Date	Creator:	Approved:	Scale
-	27.08.2010	OC	PM	1:3
Tolerance: -		File: 914CBR-VxxxBT		
No.:	Last Revision:	Rev Date:	By:	Paper size:
5	Hot surface print added	29.09.2014	SAPU	A3

Any amendment must be confirmed by DANOTHERM ELECTRIC A/S

Drawing No.: **914CBR-VxxxBT** Sheet: 1 of 1

Material:

Path: T:\sw\kute\KUTETEGN\