

10 9 8 7 6 5 4 3 2 1

H
G
F
E
D
C
B
A

H
G
F
E
D
C
B
A

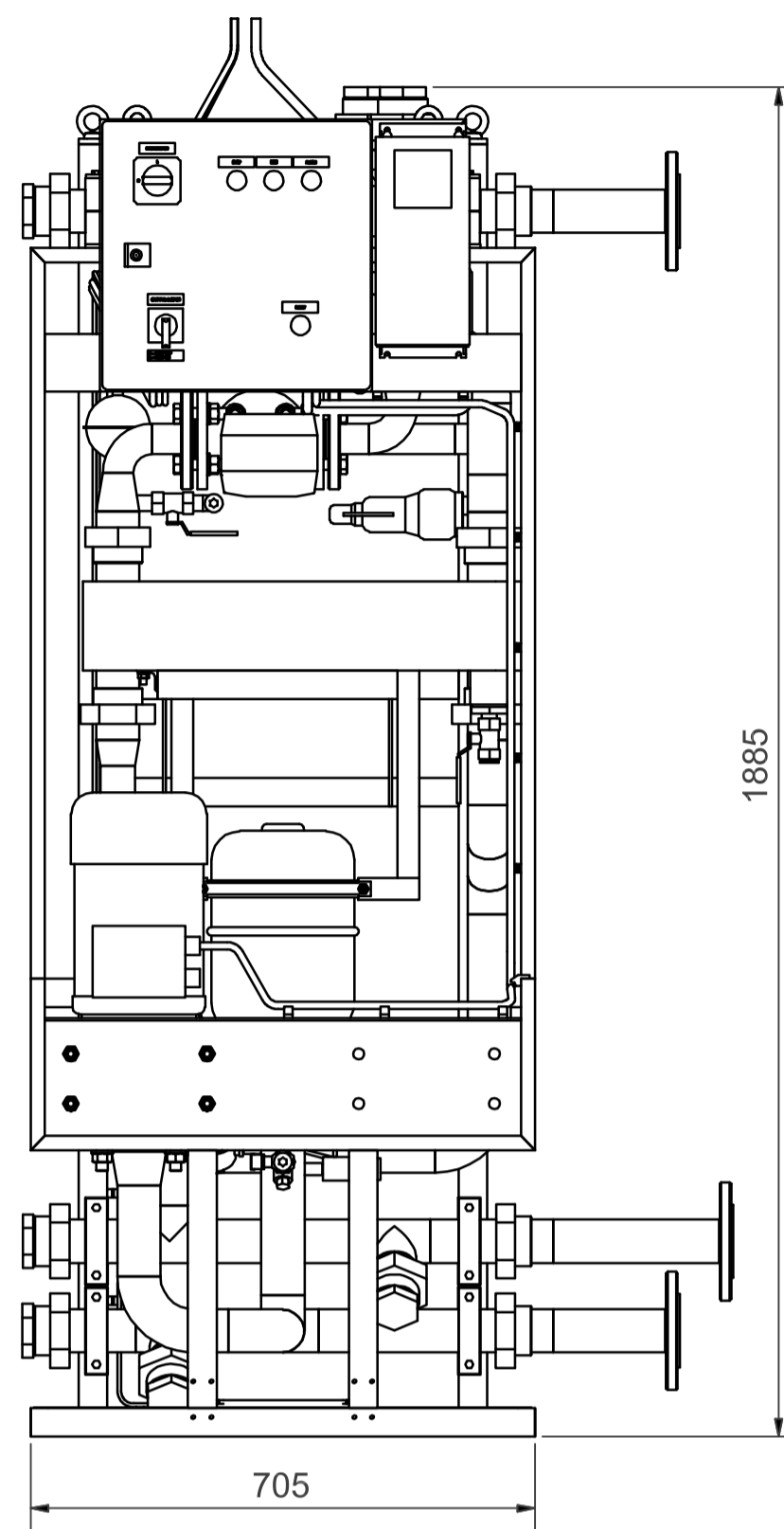
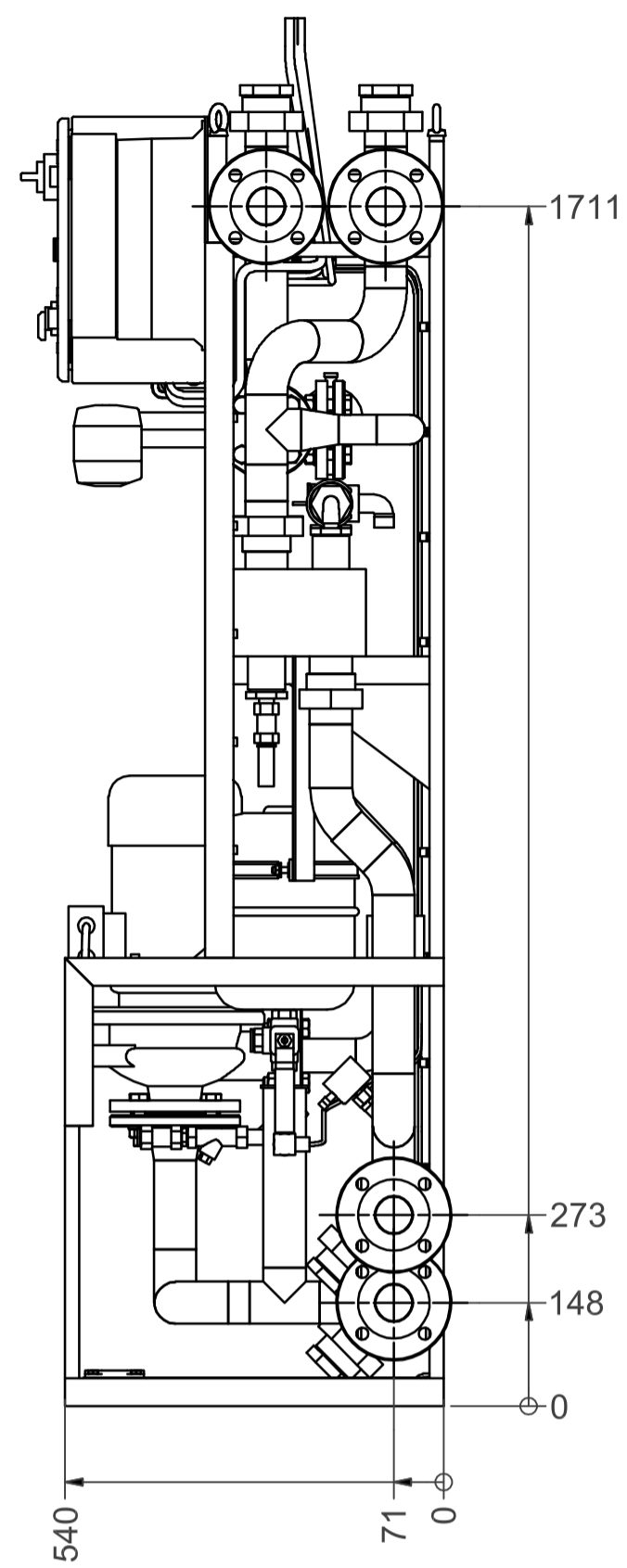
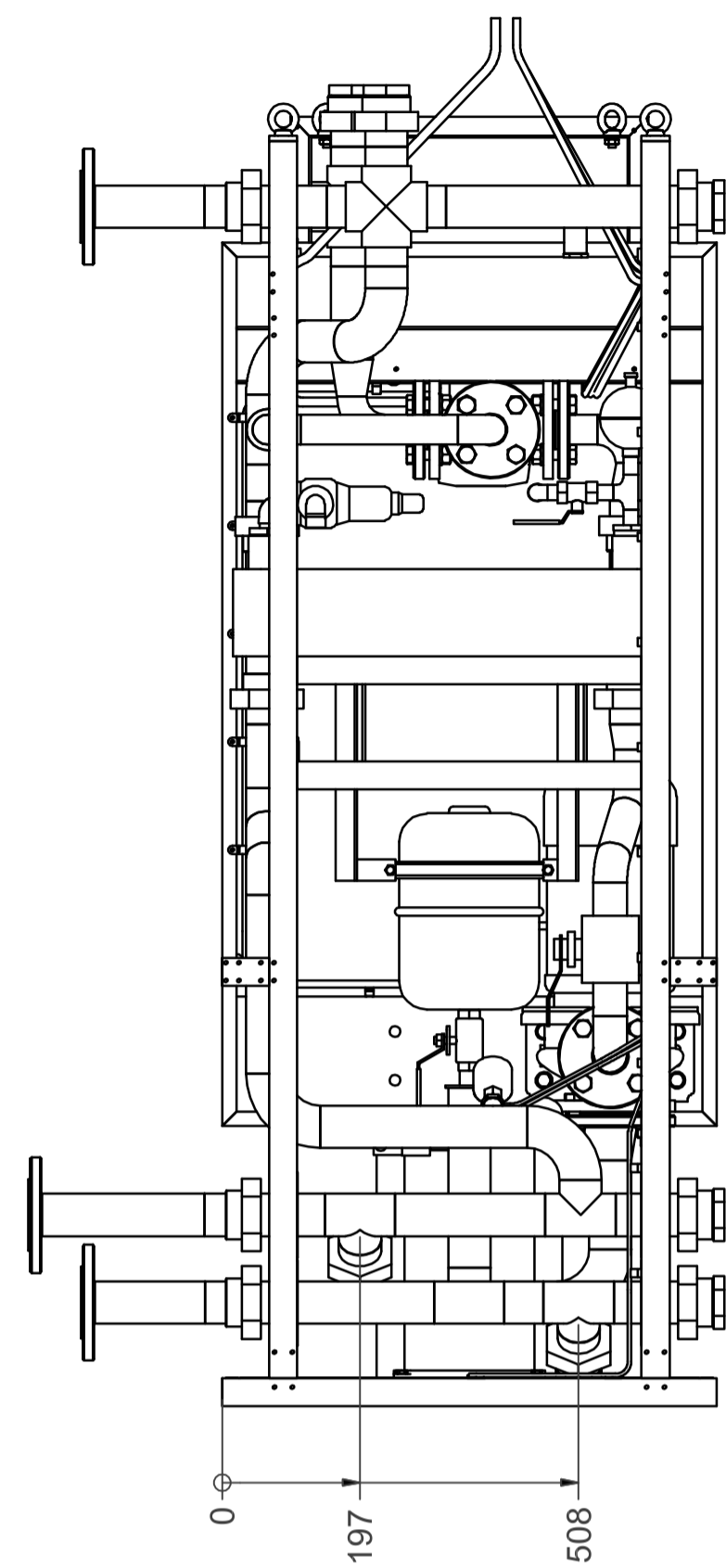

STD CONNECTIONS

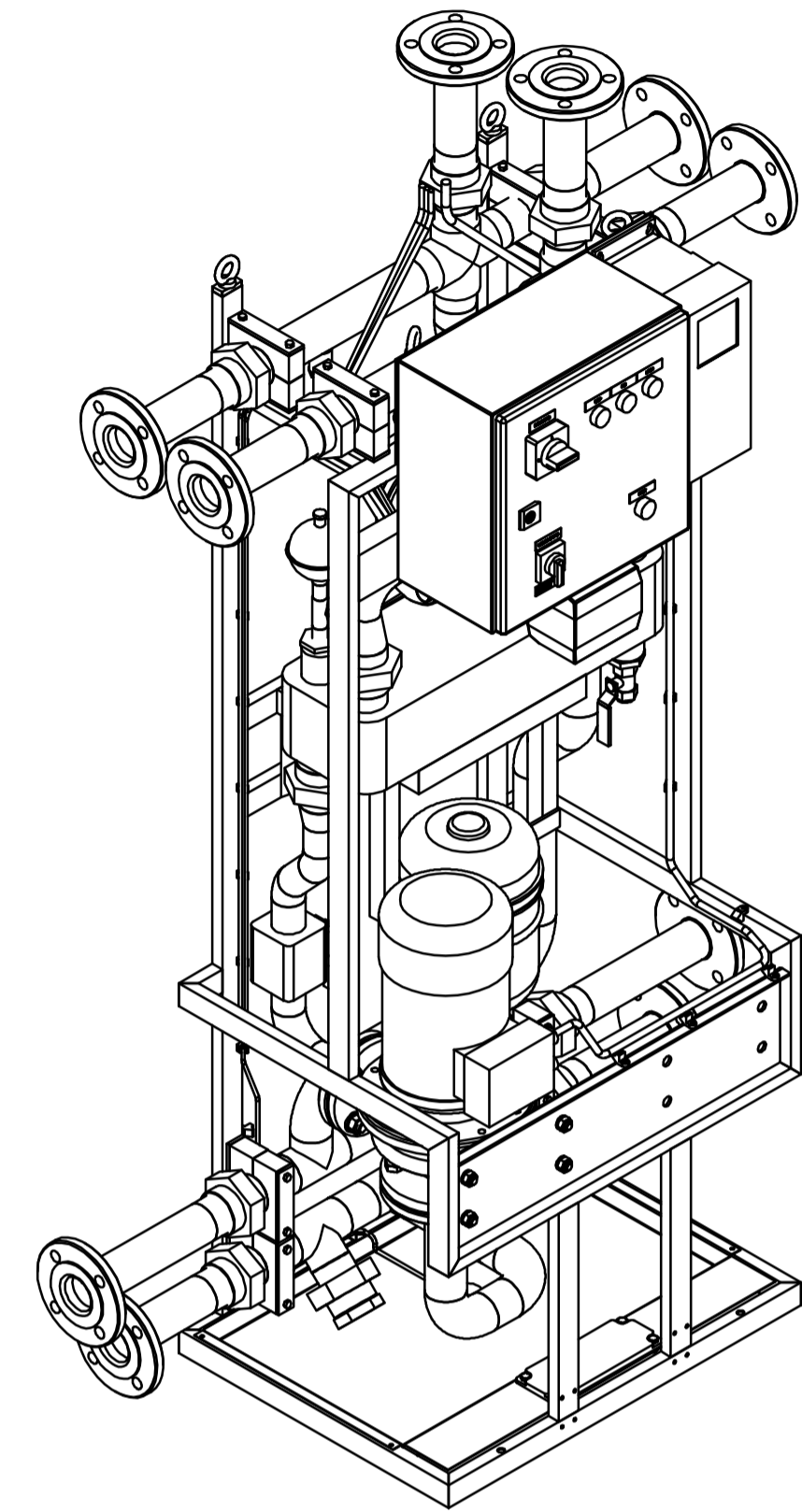
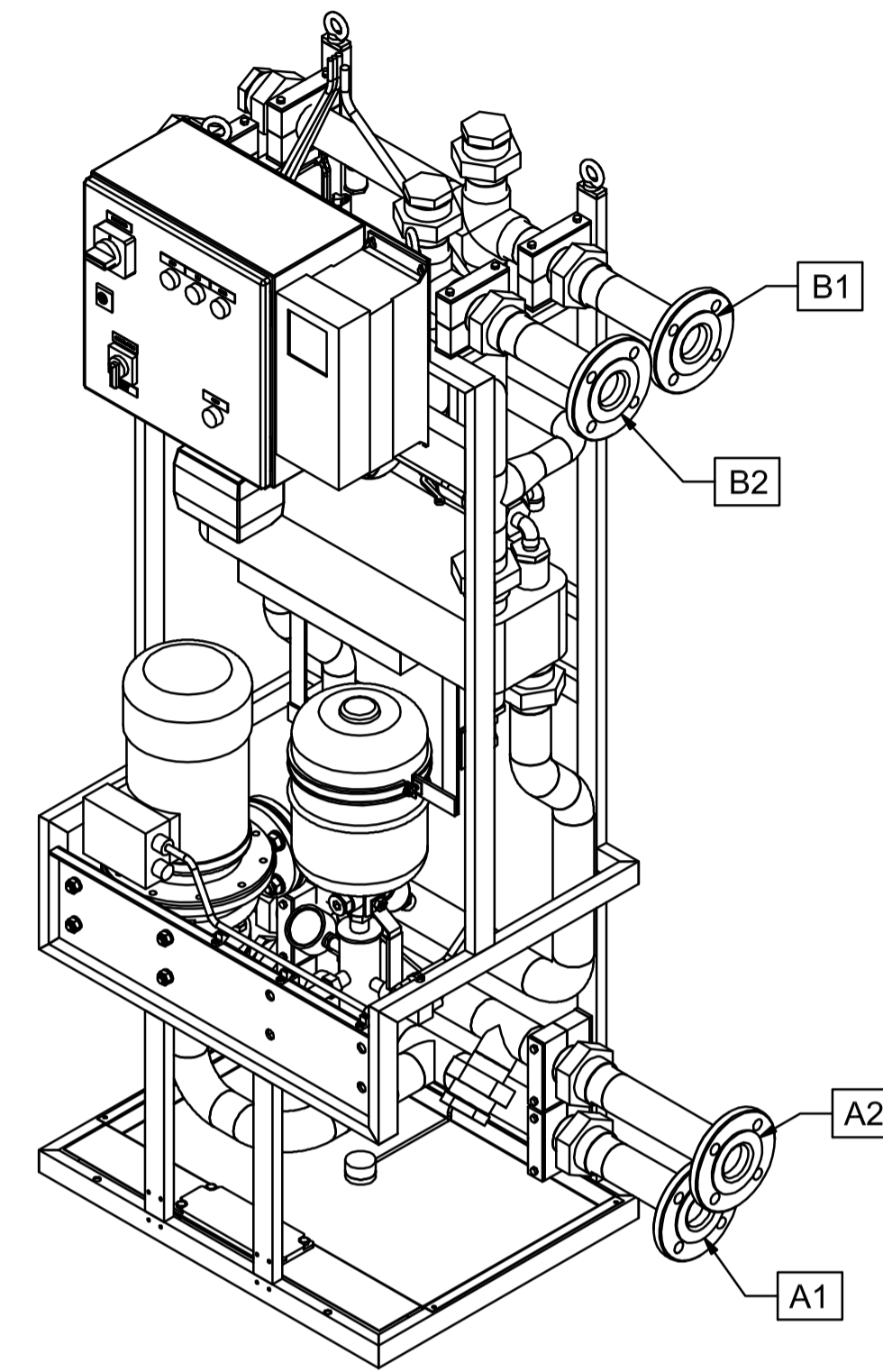

Customer cooling water interface can be chosen from the following directions;
- Left
- Right
- Up

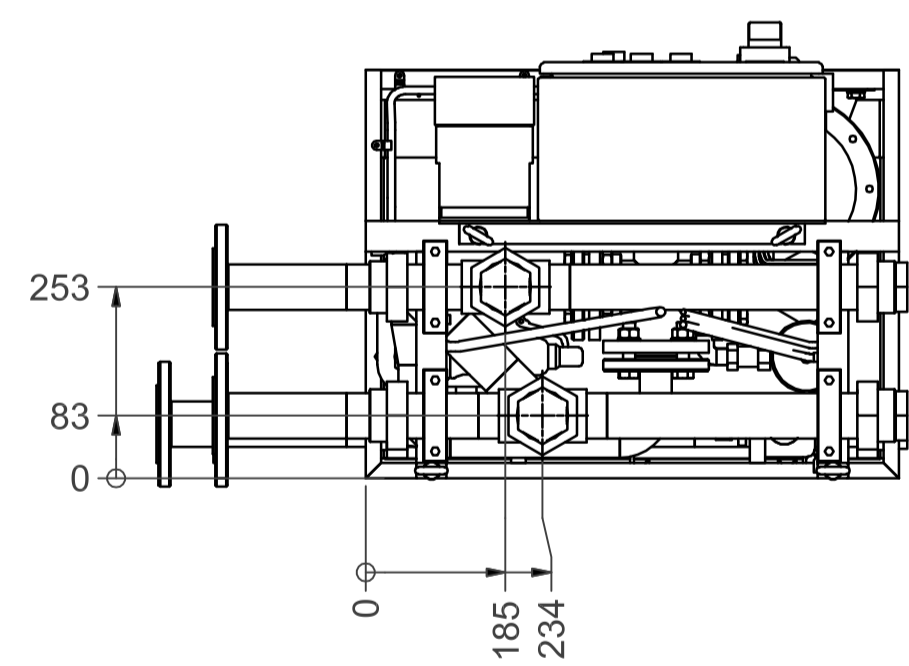

NOZZLE DATA					
A1	FROM DRIVE	2"	ISO 7/1	or	DN50 DIN 2642
A2	TO DRIVE	2"	ISO 7/1	or	DN50 DIN 2642
B1	INLET CUSTOMER	2"	ISO 7/1	or	DN50 DIN 2642
B2	OUTLET CUSTOMER	2"	ISO 7/1	or	DN50 DIN 2642

DESIGN DATA AND CAPACITY		
	Primary side	Secondary side
Pressure	6 bar	10 bar
Temperature	60°C	50°C
Maximum Flow	360 l/min/2.7 bar	Acc. to project info
Power Supply	3~ 400 VAC (50 Hz) or 3~ 440 VAC (60 Hz), 16 A	
Maximum straight pipe distance between HX-unit and drive for achieving maximum flow: 40 m + 40 m (turn + return)		
NOTE! Elbows and other components will reduce the pipe distance.		

REFERENCE DRAWINGS	
P&I Diagram	VL39-5020-10
Cubicle Veda	VL39-5023-10
Cubicle Rittal	VL39-5023-11

REVISION HISTORY				
REV	DESCRIPTION	DATE	BY	APPROVED
a	Misc.	31.08.2007	A-M. Haka	J-P. Sampola

Part no.	Qty.	Part name, type and/or measures	Standard/Draw. no.	Material	Weight/pc
GENERAL TOLERANCES					
ISO 2768-c		DRAWING NAME HXL120 DIMENSIONAL		CUSTOMER VACON OYJ	
DRAWING TYPE Assembly drawing		PROJECT NAME HXL-M-120-N-S		PROJECT NAME STD HX-unit	
DRAWING NUMBER HXL-M-120-N-S		DATE 19.10.2006		CUSTOMER PROJECT NUMBER VL39-5023-12a	
DRAWN A-M. Haka		SCALE 1:10		REV. NO. VL39-5023-12a	
CHECKED U. Kähtävä		SIZE A1		REV.	
APPROVED J-P. Sampola					

10 9 8 7 6 5 4 3 2 1

These documents must not be copied without our written permission. If you have any questions, please contact us. All rights reserved. No part of this document may be reproduced, stored in a retrieval system, or transmitted in any form or by any means, electronic, mechanical, photocopying, recording, or by any information storage and retrieval system, without the prior written permission of Vacon Oy.