

Installation Instructions

Control Cassettes

VLT[®] AutomationDrive FC 360

There are 3 types of control cassettes for VLT[®] AutomationDrive FC 360:

- Standard control cassette (132B0255)
- Control cassette with PROFIBUS (132B0256)
- Control cassette with PROFINET (132B0257)

The installation instructions in this document apply to all of them. For control cassette with PROFIBUS and control cassette with PROFINET, make sure to mount the PROFIBUS/PROFINET decoupling kit after mounting the control cassette. Instructions on mounting the decoupling kit can be found in the kit package.

Items Supplied

- 1 of the 3 types of control cassettes:
 - Standard control cassette.
 - Control cassette with PROFIBUS.
 - Control cassette with PROFINET.
- Screws
- PROFIBUS/PROFINET decoupling kit

Safety Instructions



DISCHARGE TIME

The frequency converter contains DC-link capacitors, which can remain charged even when the frequency converter is not powered. Failure to wait the specified time after power has been removed before performing service or repair work, could result in death or serious injury.

- Disconnect AC mains, permanent magnet type motors, and remote DC-link power supplies, including battery back-ups, UPS, and DC-link connections to other frequency converters.
- Wait for the capacitors to discharge fully, before performing any service or repair work. The duration of waiting time is specified in *Table 1.1*.

Voltage [V]	Minimum waiting time (minutes)	
	4	15
380–480	0.37–7.5 kW	11–75 kW
High voltage may be present even when the warning LEDs are off!		

Table 1.1 Discharge Time

Refer to the *quick guide* for detailed information about safe installation of the frequency converter.

Mounting

1. Remove the old control cassette. See the chapter *Assembly and Disassembly* in the *service manual* for instructions to remove a control cassette.
2. Connect the control cassette with the frequency converter, bending the cable as shown in *Illustration 1.1*.

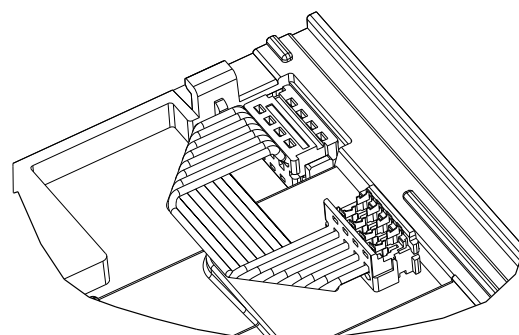

1308D358.10

Illustration 1.1 Bend the Connection Cable

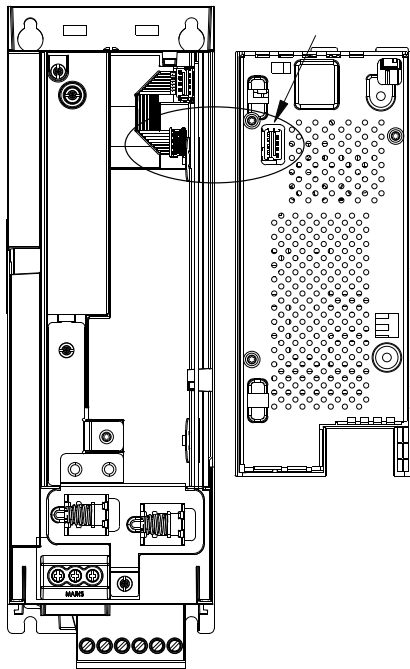

1308D359.10

Illustration 1.2 Connection Point on the Control Cassette

- Place the control cassette on the frequency converter and slide it into place.

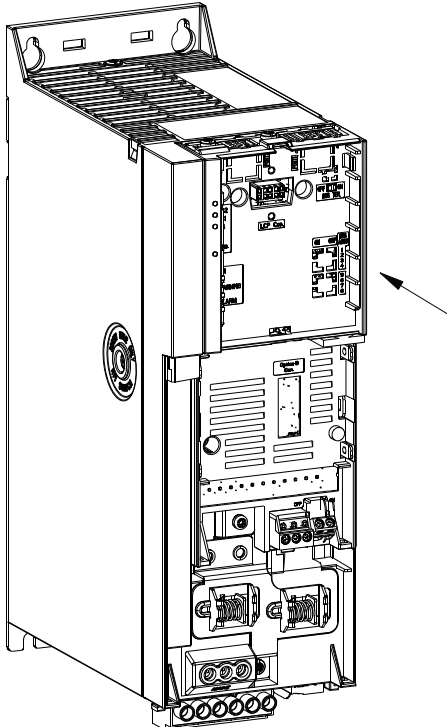

1308D357.10

Illustration 1.3 Slide the Control Cassette into Place

- Fasten the control cassette on the frequency converter using 2 screws (supplied). Tightening torque 0.7–1.0 Nm.

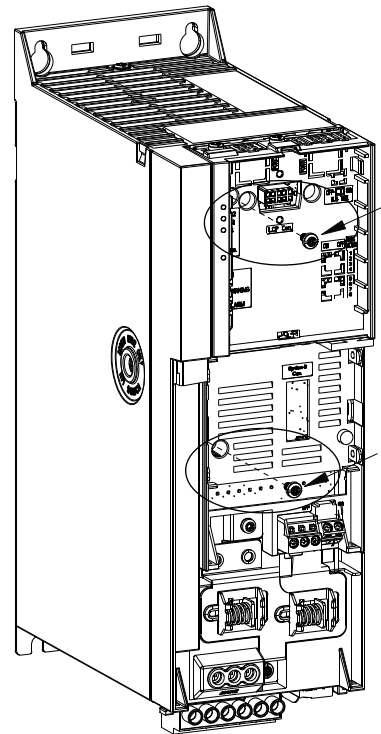

1308D360.10

Illustration 1.4 Tighten Screws

NOTICE

For the new control cassette to be properly recognised by the frequency converter, update the software in the frequency converter every time a new control cassette is installed. For details about how to update the software, see the section *Flashing of Frequency Converter after Control Card Replacement* in the service manual.

Danfoss can accept no responsibility for possible errors in catalogues, brochures and other printed material. Danfoss reserves the right to alter its products without notice. This also applies to products already on order provided that such alterations can be made without subsequential changes being necessary in specifications already agreed. All trademarks in this material are property of the respective companies. Danfoss and the Danfoss logotype are trademarks of Danfoss A/S. All rights reserved.

