

SPECIFICATIONS

- Duty cycle rating: 100% at 133% of rated voltage
- Magnet wire insulation: (200°C)
- Ambient temperature: -30 to 90 °C [-22 to 194 °F]
- Diodes are available; contact your Comatrol representative.
- Environmental protection: IP65
- All AC coils are internally rectified

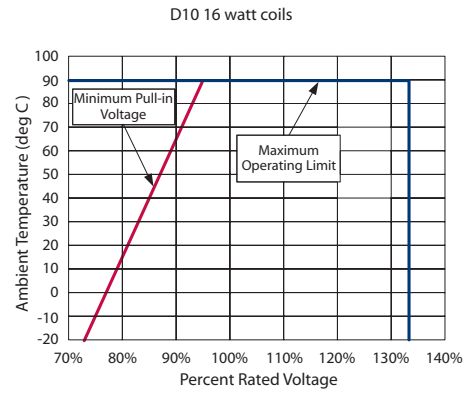

ELECTRICAL SPECIFICATIONS

16 watt coils

Voltage (V)	10 VDC	12 VDC	20 VDC	24 VDC	110 VAC	220 VAC
Resistance (Ohms) @ 20 °C [68 °F]	6.3	9	25	36	900	3600
Current draw (A) at 25 °C [68 °F]	1.6	1.33	0.8	0.67	0.13	0.07
Color	Green	Grey	Blue	Black	Black	Black

30 watt coils

Voltage (V)	10 VDC	12 VDC	20 VDC	24 VDC	110 VAC	220 VAC
Resistance (Ohms) @ 20 °C [68 °F]	3.3	4.8	13	19	480	1920
Current draw (A) @ 20 °C [68 °F]	3	2.5	1.5	1.25	0.25	0.13
Color	Green	Grey	Blue	Black	Black	Black

TERMINALS

Deutsch
 Code DE

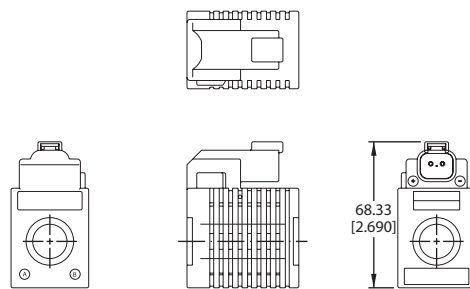

Deutsch w/diode
 Code DED

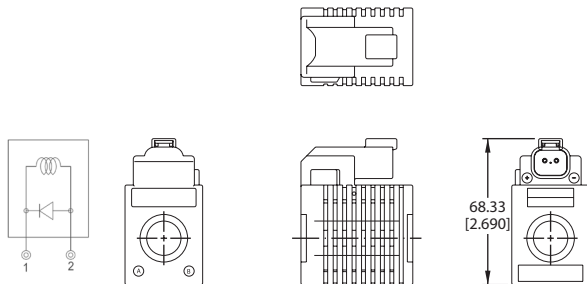

Part numbers

Voltage (V)	Power (W)	Part Number
10 VDC	16	D10-16W-10D-DE
12 VDC	16	D10-16W-12D-DE
20 VDC	16	D10-16W-20D-DE
24 VDC	16	D10-16W-24D-DE
10 VDC	30	D10-30W-10D-DE
12 VDC	30	D10-30W-12D-DE
20 VDC	30	D10-30W-20D-DE
24 VDC	30	D10-30W-24D-DE

Part numbers

Voltage (V)	Power (W)	Part Number
10 VDC	16	D10-16W-10D-DED
12 VDC	16	D10-16W-12D-DED
20 VDC	16	D10-16W-20D-DED
24 VDC	16	D10-16W-24D-DED
10 VDC	30	D10-30W-10D-DED
12 VDC	30	D10-30W-12D-DED
20 VDC	30	D10-30W-20D-DED
24 VDC	30	D10-30W-24D-DED

**TERMINALS
 (continued)**

**DIN 43650
 Code H**

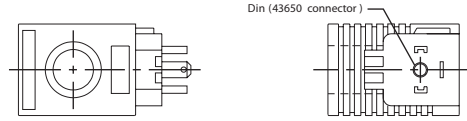

Part numbers

Voltage (V)	Power (W)	Part Number
10 VDC	16	D10-16W-10D-H
12 VDC	16	D10-16W-12D-H
20 VDC	16	D10-16W-20D-H
24 VDC	16	D10-16W-24D-H
110 VAC	16	D10-16W-120A-H
220 VAC	16	D10-16W-240A-H
10 VDC	30	D10-30W-10D-H
12 VDC	30	D10-30W-12D-H
20 VDC	30	D10-30W-20D-H
24 VDC	30	D10-30W-24D-H
110 VAC	30	D10-30W-120A-H
220 VAC	30	D10-30W-240A-H

**Lead wires
 Code L**

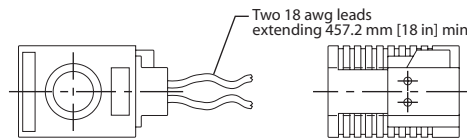

Part numbers

Voltage (V)	Power (W)	Part Number
10 VDC	16	D10-16W-10D-L
12 VDC	16	D10-16W-12D-L
20 VDC	16	D10-16W-20D-L
24 VDC	16	D10-16W-24D-L
10 VDC	30	D10-30W-10D-L
12 VDC	30	D10-30W-12D-L
20 VDC	30	D10-30W-20D-L
24 VDC	30	D10-30W-24D-L

**MetriPak 150 Type 1
 Code M2**

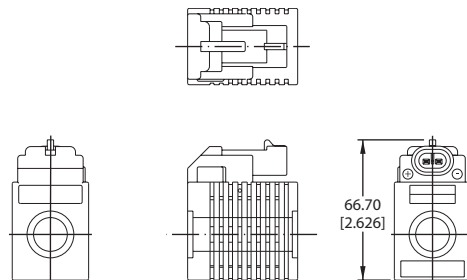

Part numbers

Voltage (V)	Power (W)	Part Number
10 VDC	16	D10-16W-10D-M2
12 VDC	16	D10-16W-12D-M2
20 VDC	16	D10-16W-20D-M2
24 VDC	16	D10-16W-24D-M2
10 VDC	30	D10-30W-10D-M2
12 VDC	30	D10-30W-12D-M2
20 VDC	30	D10-30W-20D-M2
24 VDC	30	D10-30W-24D-M2

**TERMINALS
 (continued)**

Dual Spade
 Code S

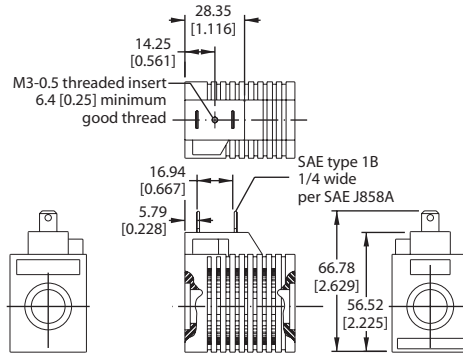

Part numbers

Voltage (V)	Power (W)	Part Number
10 VDC	16	D10-16W-10D-S
12 VDC	16	D10-16W-12D-S
20 VDC	16	D10-16W-20D-S
24 VDC	16	D10-16W-24D-S
10 VDC	30	D10-30W-10D-S
12 VDC	30	D10-30W-12D-S
20 VDC	30	D10-30W-20D-S
24 VDC	30	D10-30W-24D-S