

Dimensions

mm [in]

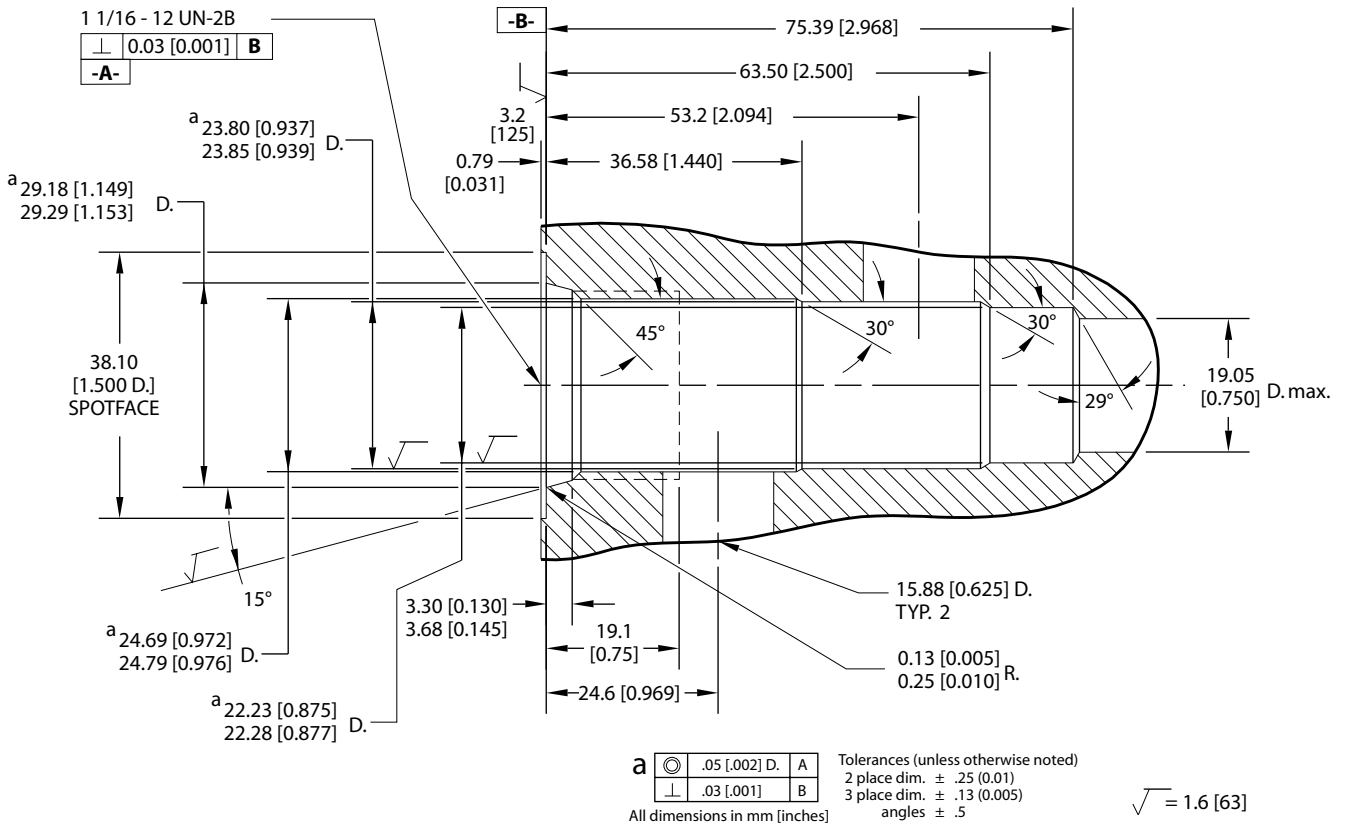

CA - Cavities
CP12-3

Form tools

| | Model code | Material number |
|-----------------------|------------|-----------------|
| Roughing tool | CP-12-3-RT | 310033 |
| Finishing Tool | CP-12-3-FT | 310007 |

Housings

| Order Code | Description | Ports | Page |
|-------------|------------------|---------|---------|
| CP12-3-10S | Aluminum Housing | SAE #10 | HS - 14 |
| CP12-3-12S | Aluminum Housing | SAE #12 | HS - 14 |
| CP12-3-4B | Aluminum Housing | 1/2 BSP | HS - 14 |
| CP12-3-6B | Aluminum Housing | 3/4 BSP | HS - 14 |
| CP12-3-S10S | Steel Housing | SAE #10 | HS - 14 |
| CP12-3-S12S | Steel Housing | SAE #12 | HS - 14 |