



KIT BEARING SENSOR HERMETIC FEED THROUGH - 9 PIN

100295 & 100295-1.



Installation and servicing of Danfoss Turbocor® compressors by qualified and product trained personnel only. Follow these instructions and sound refrigeration/electrical/servicing practices relating to installation, commissioning, maintenance and service.

<p>Consult the appropriate Danfoss Turbocor Compressors Inc. (DTC) Service Manual on turbocor.danfoss.com for detailed service instructions.</p>	<p>Never power compressor without covers in place and secured.</p> <p>Removing the mains input cover will expose you to a voltage hazard of up to 575V. Ensure the mains input power is off and locked out before removing cover.</p> <p>Before removing top cover, wait at least 20 minutes after isolating AC power to allow the high voltage capacitors to discharge.</p>	<p>Always wear appropriately rated safety equipment when working around equipment and/or components energized with high voltage.</p> <p>This equipment contains hazardous voltages that can cause serious injury or death.</p>	<p>Recover all refrigerant from compressor in accordance with local codes and ensure pressure is fully vented before the removal of refrigerant containing components.</p>
--	---	---	---

1 - Introduction:

BEARING SENSOR HERMETIC FEED THROUGH - 9 PIN Removal and Installation Instructions.

2 - Removing Refrigerant from Compressor:

- Recover refrigerant from compressor in accordance with local codes and practices.

3 - Suggested Tools:

- 4 mm hex socket bit
- Torque wrench – Must be able to measure a torque of 5 Nm (3.7 ft.lb)
- Needle-nose pliers
- Philips screwdriver

4 - Replacement Procedure:

1. Remove the six (6) screws that secure the Service Side Cover. Lift away cover.
2. Pull the Serial Driver Module out of its slot and keep it in a safe place. Make sure you do not damage the connector pins.

- NOTE:** Refer to the Service Manual for proper electrostatic discharge (ESD) handling of electronic components.
- Pull the Bearing Motor Compressor Controller (BMCC) out of its slot, and keep it in a safe place. Make sure you do not touch or damage the connector pins.
 - Remove the bearing sensor cable from the 9-pin feed through (Figure 1).

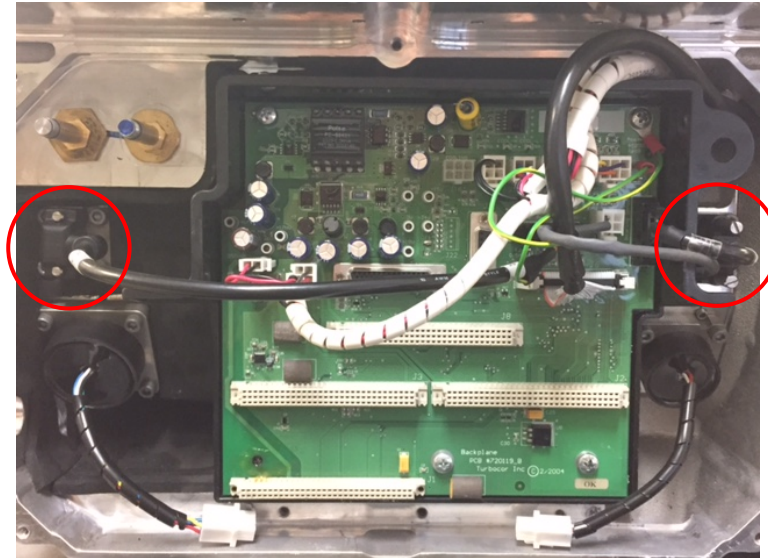

Figure 1 - 9-Pin Feed Through Connector Locations

- Using a hex socket, remove the four (4) screws that secure the 9-pin feed through.
- Carefully remove the 9-pin feed through. It may be necessary to use needle-nose pliers to grasp the feed through. Do not use a screwdriver to pry the feed through out of the housing.
- Using a lint-free cloth, clean the mating surface on the compressor housing.
- Verify that the new O-rings and 9-pin feed through are clean. If not, wipe off any contaminants with a lint-free cloth.
- Apply a drop of lube on each of the new O-rings.
- Install the new O-rings onto the new 9-pin feed through.
- Install the new 9-pin feed through.
- Secure the feed through with the provided four (4) M5x16 screws. Finger-tighten the screws and then follow the torque sequence (Figure 2) and torque to 3 Nm (2.2 ft.lb.). Torque the screws a final time to 5 Nm (3.7 ft.lb.).

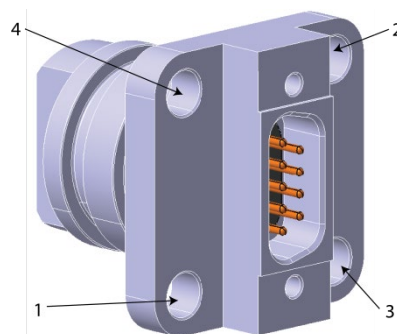
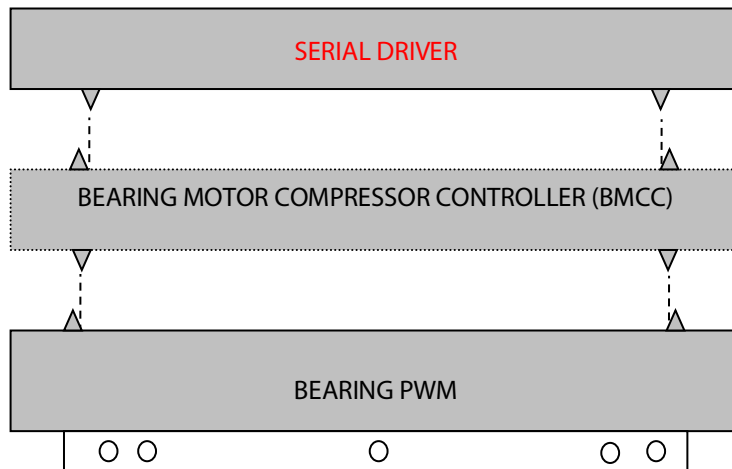

Figure 2 – Torque Sequence

- Leak test and evacuate compressor in accordance with good industry practices.
- Install the bearing sensor cable onto the new 9-pin feed through.
- Carefully, insert the BMCC back into its slot. Align the BMCC module's two lower guides so they are aligned on the inside of the Bearing PWM module's two upper guides. Note the insertion guides in the following figure.

- Carefully, insert the Serial Driver back into its slot. Align the serial driver module's two lower guide rails so that they are aligned on the inside of the BMCC module's two upper guide rails. See the following figure.





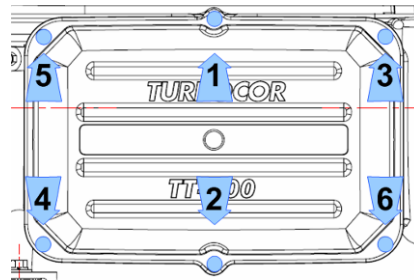

- Ensure that no residue remains on the contact surfaces of the cover and main housing sides.
- Place the Service Side Cover and secure it with the six (6) screws according to the following sequence.

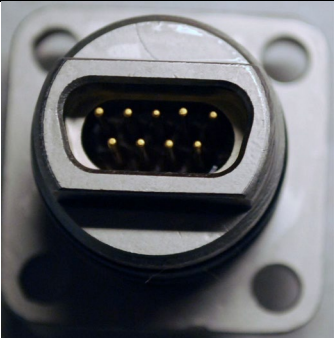

- Follow the sequence twice. The first time, only fasten the screws to half way down to allow adjustments.
- Apply mains power to the compressor.
- Charge the compressor with refrigerant.

5 - Kit Contents

QTY	Part(s) Description	Picture(s)
1	HERMETIC FEED THROUGH – 9-PIN D-SUB	
4	SCREW, M5X16 SOCKET HEAD CAP	
2	O-RING	
1	LUBRICATION, SUPER-O-LUBE-2G	

Danfoss can accept no responsibility for possible errors in catalogues, brochures and other printed material. Danfoss reserves the right to alter its products without notice. This also applies to products already on order provided that such alterations can be made without subsequential changes being necessary in specifications already agreed. All trademarks in this material are property of the respective companies. Danfoss and the Danfoss logotype are trademarks of Danfoss A/S. All rights reserved.