

Side view, right

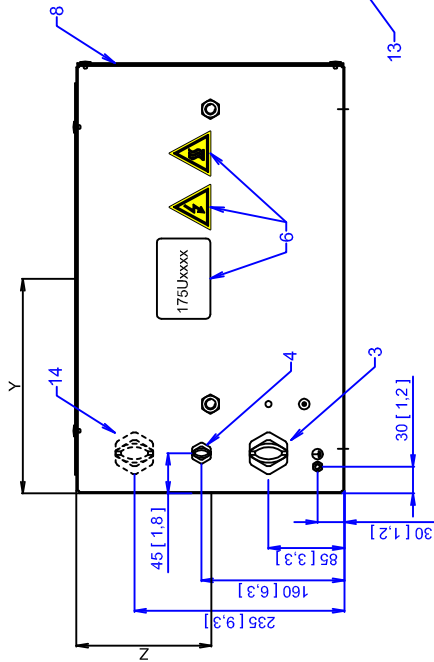

Front view

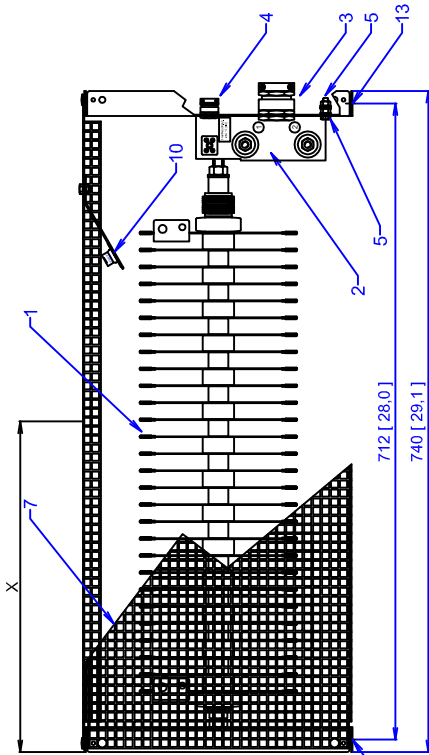

Side view, left

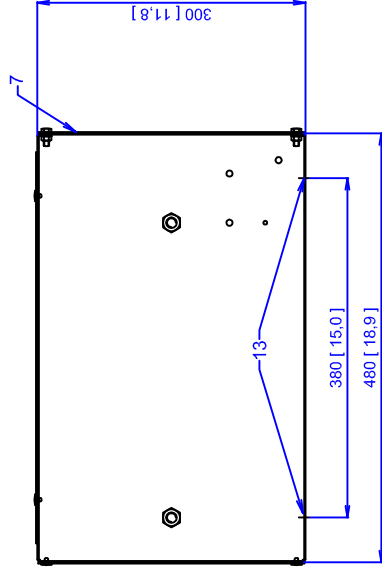

Top view

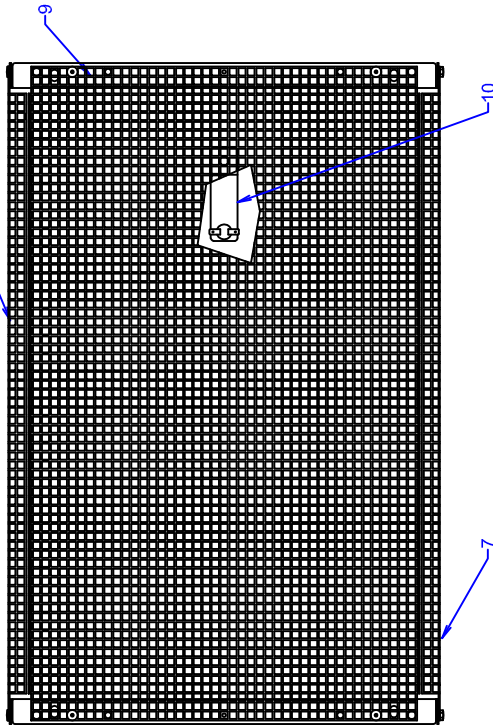

Detail view

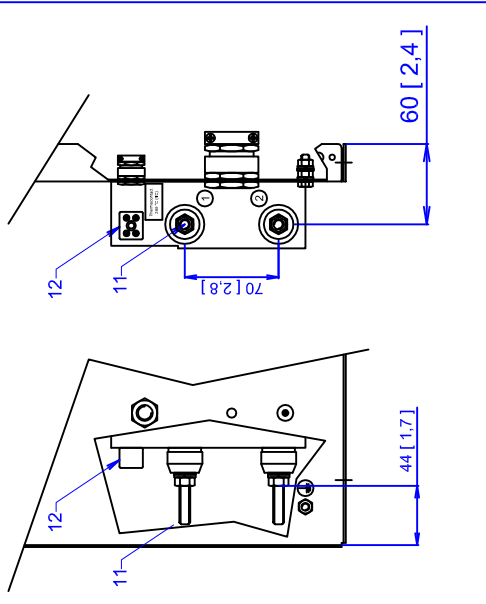

Name Plate



DECLARATION

1. Resistor
2. Terminal board, see detail view
3. Cable gland for load cables
4. Cable gland M16 thermo contact cable
5. Eathing bolt M6
6. Name plate / Warning signs
7. Front cover IP20
8. Rear cover IP20
9. Top cover IP20
10. Thermocontact 260 °C (NC)
11. Load connection, 2x bolt M8
12. Auxiliary connection for thermo contact, porcelain clamp 2,5" 4x fixing hole Ø 9mm
13. Second cable gland (on demand)
14. Second cable gland (on demand)

Weight (g)	Date	Creator:	Approved:	Scale
-	14.03.2012	F. Bülle	H. Hansen	1:1
Tolerance:	File: 917CM17_02.dwg			
No.:	Last Revision:	Rev Date:	F. Bülle	Paper size:
02	13/637	11.12.2013	A3	A3

Danfoss
Danfoss A/S
Power Electronics Division
Ulsmøse 1, 6300 Grøsten
Denmark

MCE101 Brake resistor
xxR±10% IP20
175C0608

Material: Zinc plated steel, without coating.
Cabinet material: Path:

Drawing No.:		917CM17
Sheet:		1 of 1

CABINET TYPE: CM17

Danfoss code	Typecode	Ohm	cable gland type for load cables (3)	Weight [kg]	Center of mass [mm]		
					X	Y	Z
175U3072	MCE101C7R40P11K0E20BAW	7,4	M40	24	370	260	155
175U3075	MCE101C6R10P13K0E20BAW	6,1	M50	25	370	260	155
175U3083	MCE101C3R70P11K0E20BAW	3,7	M50	24	370	260	155
175U3084	MCE101C3R30P13K0E20BAW	3,3	2x M25	25	370	260	155
175U3201	MCE101C27R0P14K0E20BAW	27,0	M25	25	370	260	155
175U3204	MCE101C19R0P14K0E20BAW	19,0	M25	25	370	260	155
175U3206	MCE101C14R0P14K0E20BAW	14,0	M32	25	370	260	155
175U3224	MCE101C3R50P14K0E20BAW	3,5	M40	25	370	260	155