



CONTACTOR,  
200KW/400V/AC-3 AC(40...60HZ)/DC OPERATION UC 220-  
240V AUXILIARY CONTACTS 2NO+2NC 3-POLE,  
SIZE S12 BAR CONNECTIONS CONVENT. OPERATING  
MECHANISM SCREW TERMINAL

### General technical data:

<b>product brand name</b>		SIRIUS
<b>Size of the contactor</b>		S12
<b>Protection class IP / on the front</b>		IP00
<b>Degree of pollution</b>		3
<b>Installation altitude / at a height over sea level / maximum</b>	m	2,000
<b>Ambient temperature / during operating</b>	°C	-25 ... +60
<b>Mechanical operating cycles as operating time</b>		
• of the contactor / typical		10,000,000
• of the contactor with added auxiliary switch block / typical		10,000,000
• of the contactor with added electronics-compatible auxiliary switch block / typical		5,000,000

### Main circuit:

<b>Number of NC contacts / for main contacts</b>		0
<b>Number of NO contacts / for main contacts</b>		3
<b>Operational current</b>		
• at AC-1 / at 400 V		
• at 40 °C ambient temperature / rated value	A	430
• at 60 °C ambient temperature / rated value	A	400
• at AC-3 / at 400 V / rated value	A	400

• at AC-4 / at 400 V / rated value	A	350
• with 1 current path / at DC-1		
• at 24 V / rated value	A	400
• at 110 V / rated value	A	33
• with 2 current paths in series / at DC-1		
• at 24 V / rated value	A	400
• at 110 V / rated value	A	400
• with 3 current paths in series / at DC-1		
• at 24 V / rated value	A	400
• at 110 V / rated value	A	400
• with 1 current path / at DC-3 / at DC-5		
• at 24 V / rated value	A	400
• at 110 V / rated value	A	3
• with 2 current paths in series / at DC-3 / at DC-5		
• at 24 V / rated value	A	400
• at 110 V / rated value	A	400
• with 3 current paths in series / at DC-3 / at DC-5		
• at 24 V / rated value	A	400
• at 110 V / rated value	A	400
<b>Service power</b>		
• at AC-2 / at 400 V / rated value	kW	231
• at AC-3 / at 400 V / rated value	kW	231
• at AC-4 / at 400 V / rated value	W	200,000

<b>Control circuit:</b>		
<b>Design of the surge suppressor</b>		with varistor
<b>Type of voltage / of the controlled supply voltage</b>		AC/DC
<b>Operating range factor control supply voltage rated value / of the magnet coil</b>		
• at 50 Hz		
• for AC		0.8 ... 1.1
• at 60 Hz		
• for AC		0.8 ... 1.1
• for DC		0.8 ... 1.1
<b>Apparent pull-in power / of the solenoid / for AC</b>	V·A	830
<b>Apparent holding power / of the solenoid / for AC</b>	V·A	9.2
<b>Inductive power factor / with the pull-in power of the coil</b>		0.9
<b>Inductive power factor / with the pull-in power of the coil</b>		0.9
<b>Pull-in power / of the solenoid / for DC</b>	W	920
<b>Holding power / of the solenoid / for DC</b>	W	10

**Auxiliary circuit:**

<b>Contact reliability / of the auxiliary contacts</b>		1 faulty switching per 100 million (17 V, 1 mA)
<b>Number of NC contacts / for auxiliary contacts / instantaneous switching</b>		2
<b>Number of NO contacts / for auxiliary contacts / instantaneous switching</b>		2

**Short-circuit:**

<b>Design of the fuse link</b>		
<ul style="list-style-type: none"> <li>• for short-circuit protection of the auxiliary switch / required</li> <li>• for short-circuit protection of the main circuit <ul style="list-style-type: none"> <li>• with type of assignment 1 / required</li> <li>• at type of coordination 2 / required</li> </ul> </li> </ul>		fuse gL/gG: 10 A  fuse gL/gG: 630 A  fuse gL/gG: 500 A

**Installation/mounting/dimensions:**

<b>Type of mounting</b>		screw fixing
<b>series installation</b>		Yes
<b>Width</b>	mm	160
<b>Height</b>	mm	214
<b>Depth</b>	mm	225
<b>Distance, to be maintained, to earthed part / sideways</b>	mm	10

**Connection type:**

<b>Design of the electrical connection</b>		
<ul style="list-style-type: none"> <li>• for main current circuit</li> <li>• for auxiliary and control current circuit</li> </ul>		screw-type terminals  screw-type terminals
<b>Type of the connectable conductor cross-section</b>		
<ul style="list-style-type: none"> <li>• for AWG conductors / for main contacts</li> <li>• for auxiliary contacts <ul style="list-style-type: none"> <li>• solid</li> <li>• finely stranded <ul style="list-style-type: none"> <li>• with conductor end processing</li> </ul> </li> </ul> </li> <li>• for AWG conductors / for auxiliary contacts</li> </ul>		2/0 ... 500 kcmil  2x (0.5 ... 1.5 mm <sup>2</sup> ), 2x (0.75 ... 2.5 mm <sup>2</sup> ), max. 2x (0.75 ... 4 mm <sup>2</sup> )  2x (0.5 ... 1.5 mm <sup>2</sup> ), 2x (0.75 ... 2.5 mm <sup>2</sup> )  2x (20 ... 16), 2x (18 ... 14), 1x 12

**Certificates/approvals:**

<b>General Product Approval</b>				<b>Functional Safety / Safety of Machinery</b>	<b>Declaration of Conformity</b>
---------------------------------	--	--	--	--	----------------------------------



CCC



CSA



GOST



UL

[Type Examination](#)



EG-Konf.

<b>Test Certificates</b>	<b>Shipping Approval</b>				
--------------------------	--------------------------	--	--	--	--

[other](#)

[Special Test Certificate](#)



ABS



DNV



GL



RMRS

**other**

[Confirmation](#)

[other](#)

[Environmental Confirmations](#)

### Further information:

#### Information- and Downloadcenter (Catalogs, Brochures,...)

<http://www.siemens.com/industrial-controls/catalogs>

#### Industry Mall (Online ordering system)

<http://www.siemens.com/industrial-controls/mall>

#### Cax online generator:

<http://www.siemens.com/cax>

#### Service&Support (Manuals, Certificates, Characteristics, FAQs,...)

<http://support.automation.siemens.com/WW/view/en/3RT1075-6AP36/all>

#### Image database (product images, 2D dimension drawings, 3D models, device circuit diagrams, ...)

[http://www.automation.siemens.com/bilddb/cax\\_en.aspx?mlfb=3RT1075-6AP36](http://www.automation.siemens.com/bilddb/cax_en.aspx?mlfb=3RT1075-6AP36)

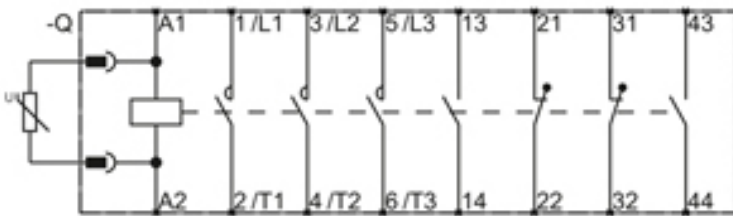
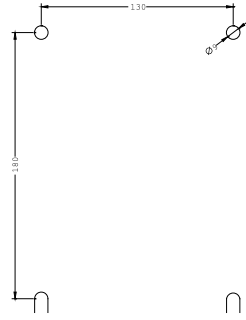
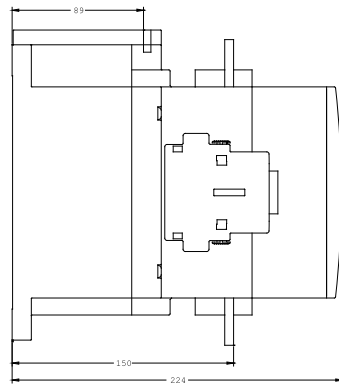
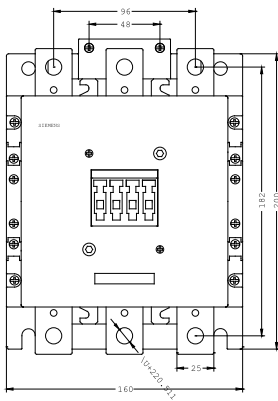

last change:

May 20, 2013