

TOP VIEW

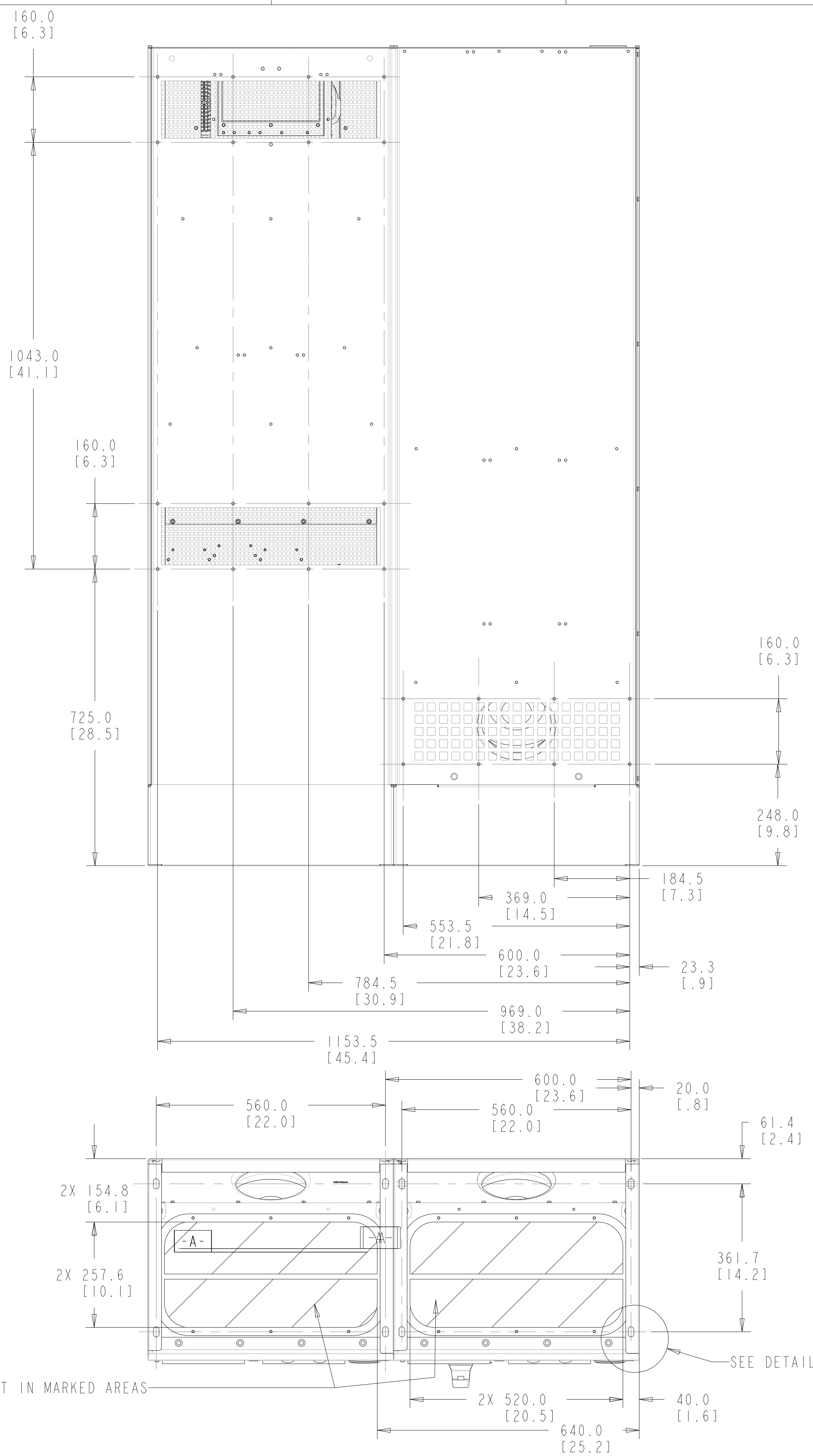

PLACE CONDUIT IN MARKED AREAS

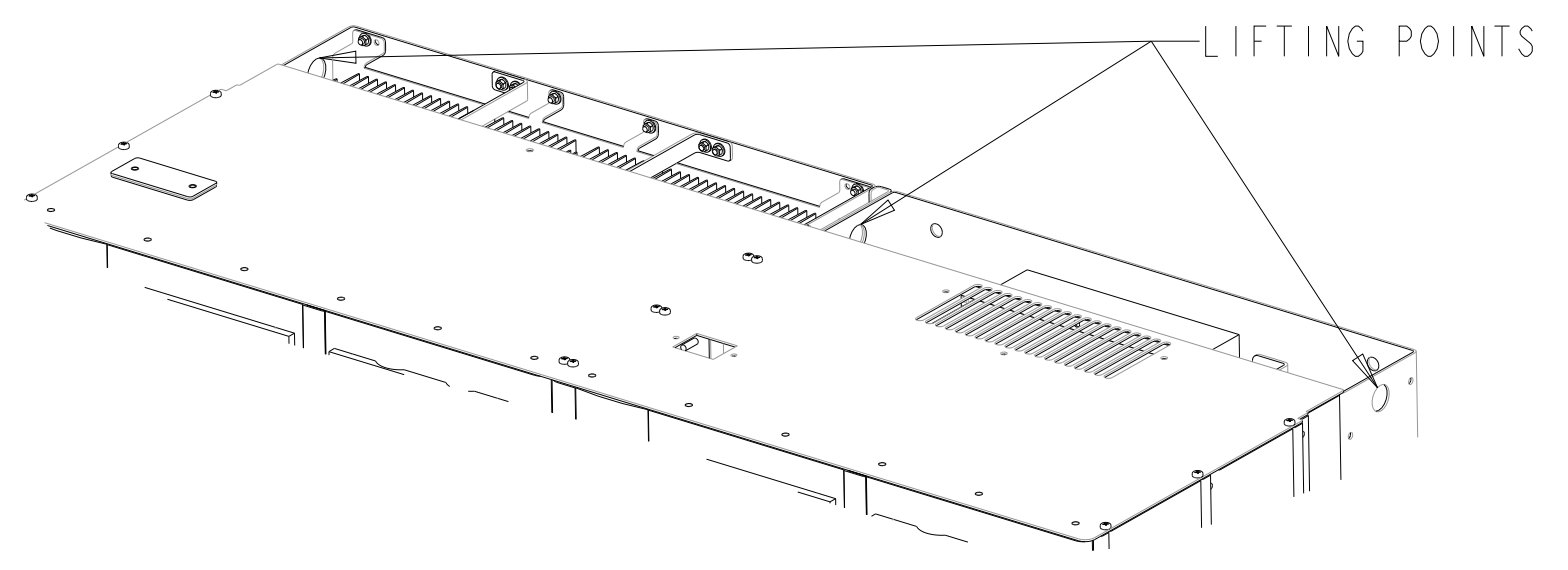
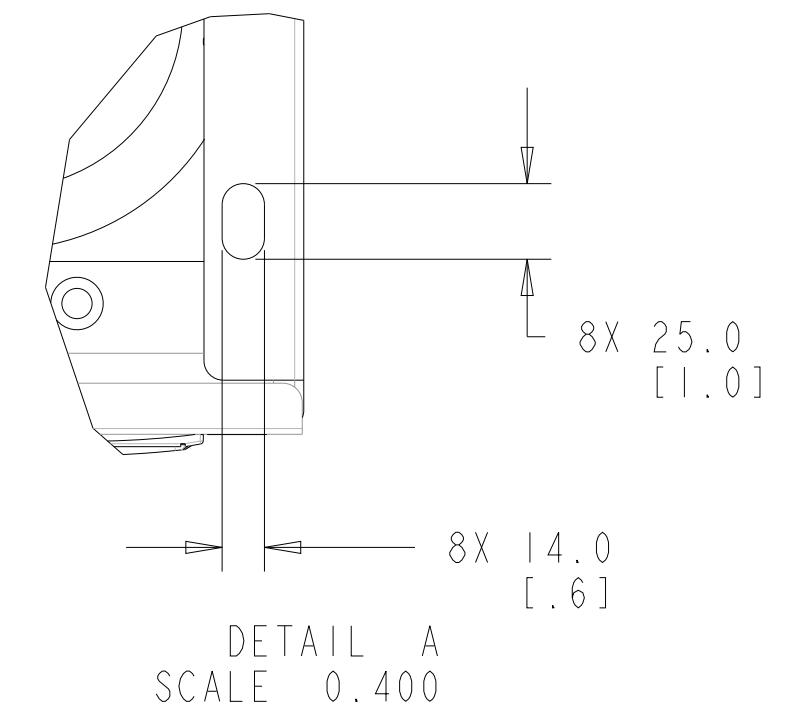

SEE DETAIL A

TITLE		
INST, MTG, SERIES 6, LHD210, E FRAME		
SIZE	MODEL	REV
D	LHD210-1P54-V5	004
SCALE	DRAWING NO.	SHEET
0.150	177R0352	2 OF 4

8

7

6

5

4

3

2

1

WITH DISCONNECT

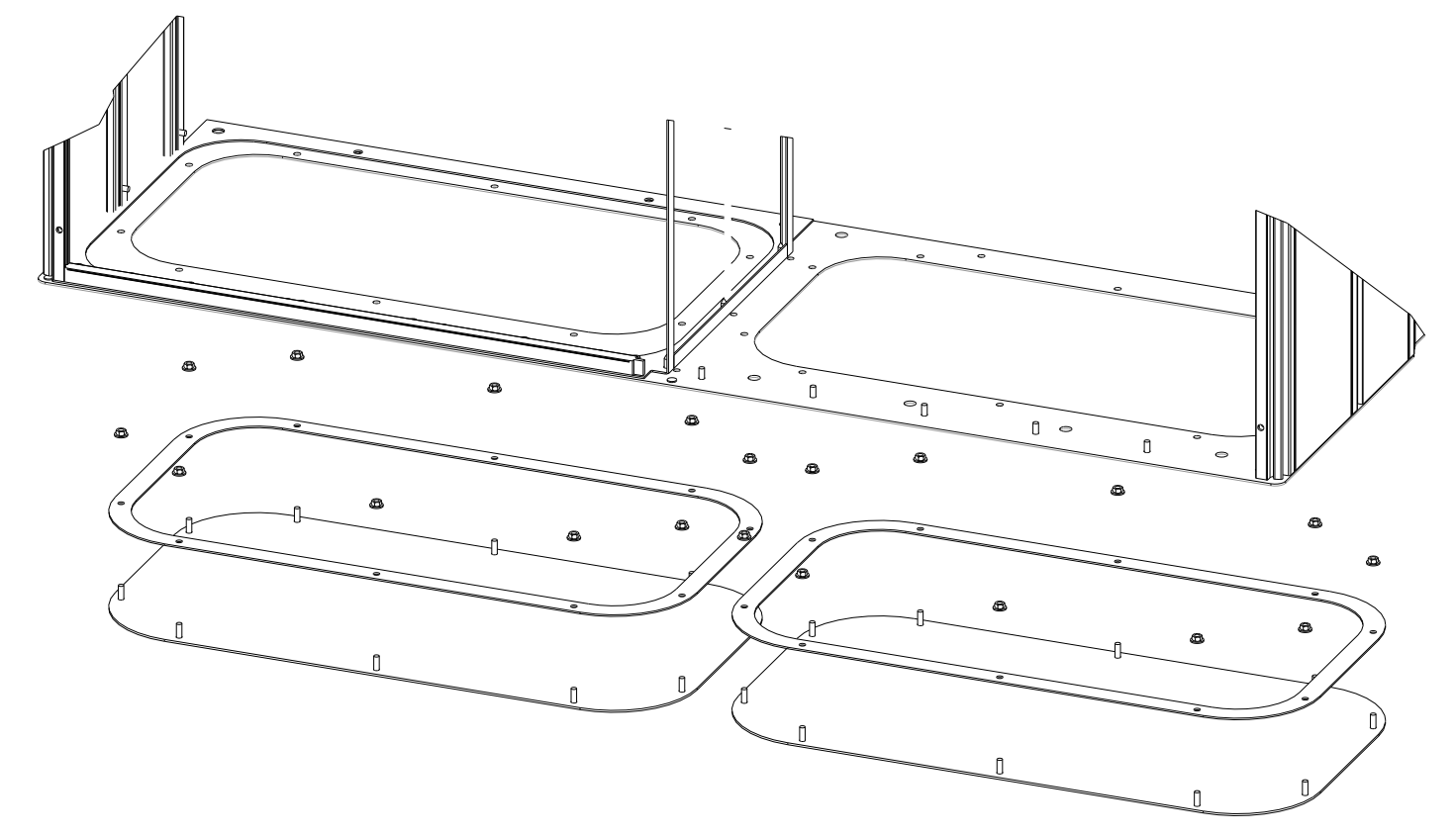
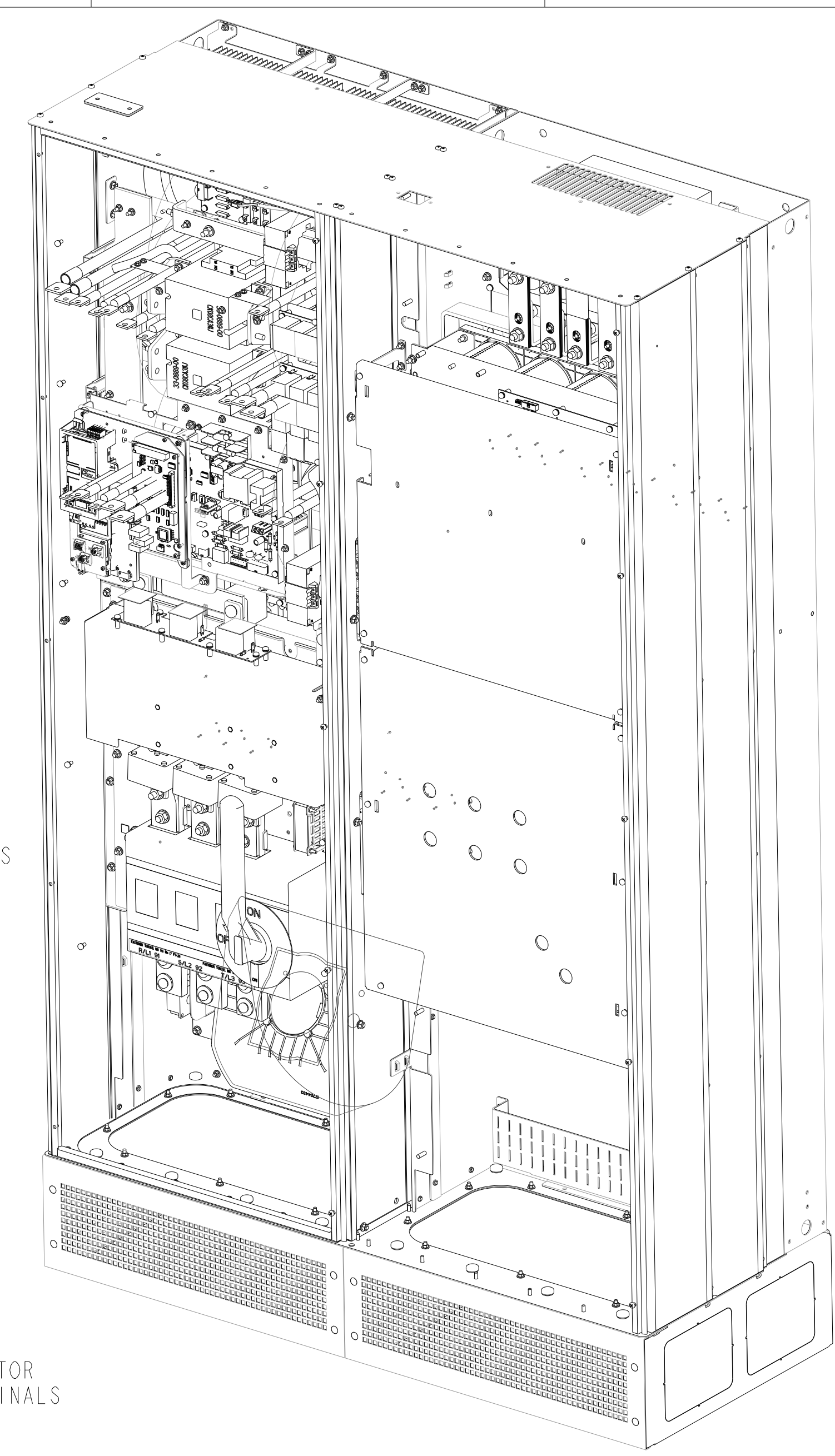
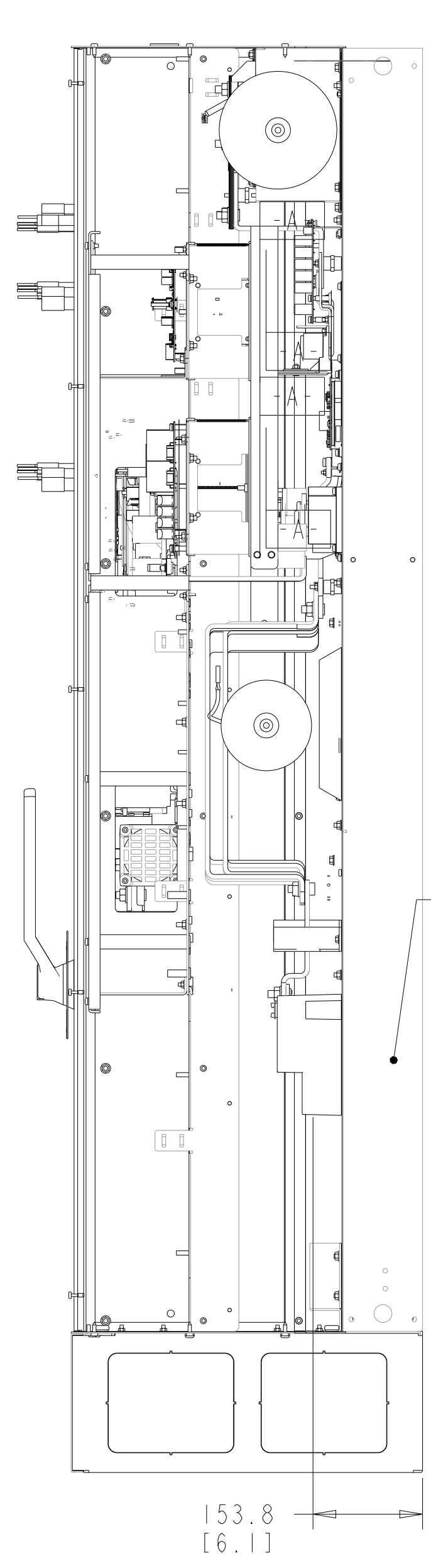
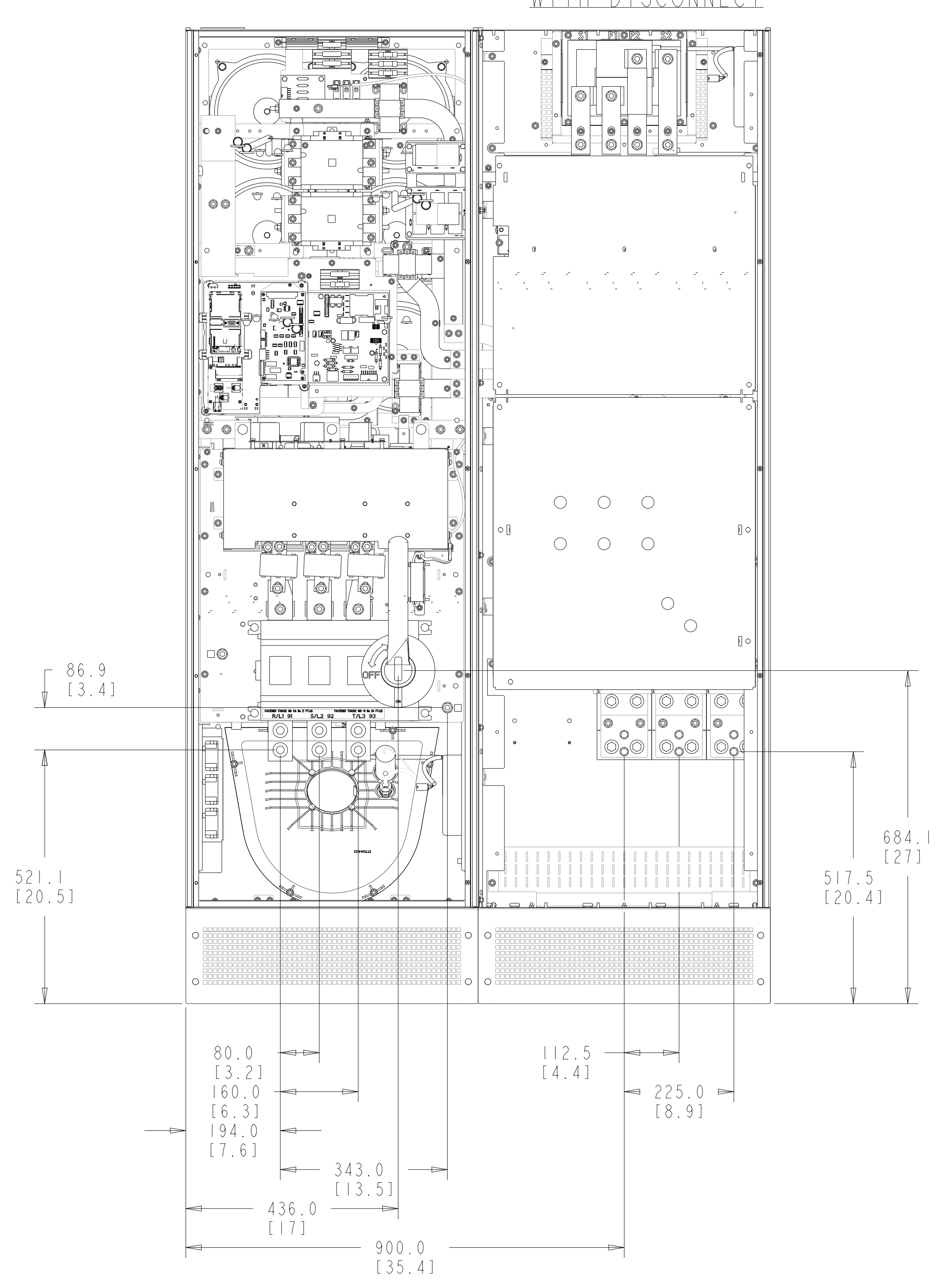
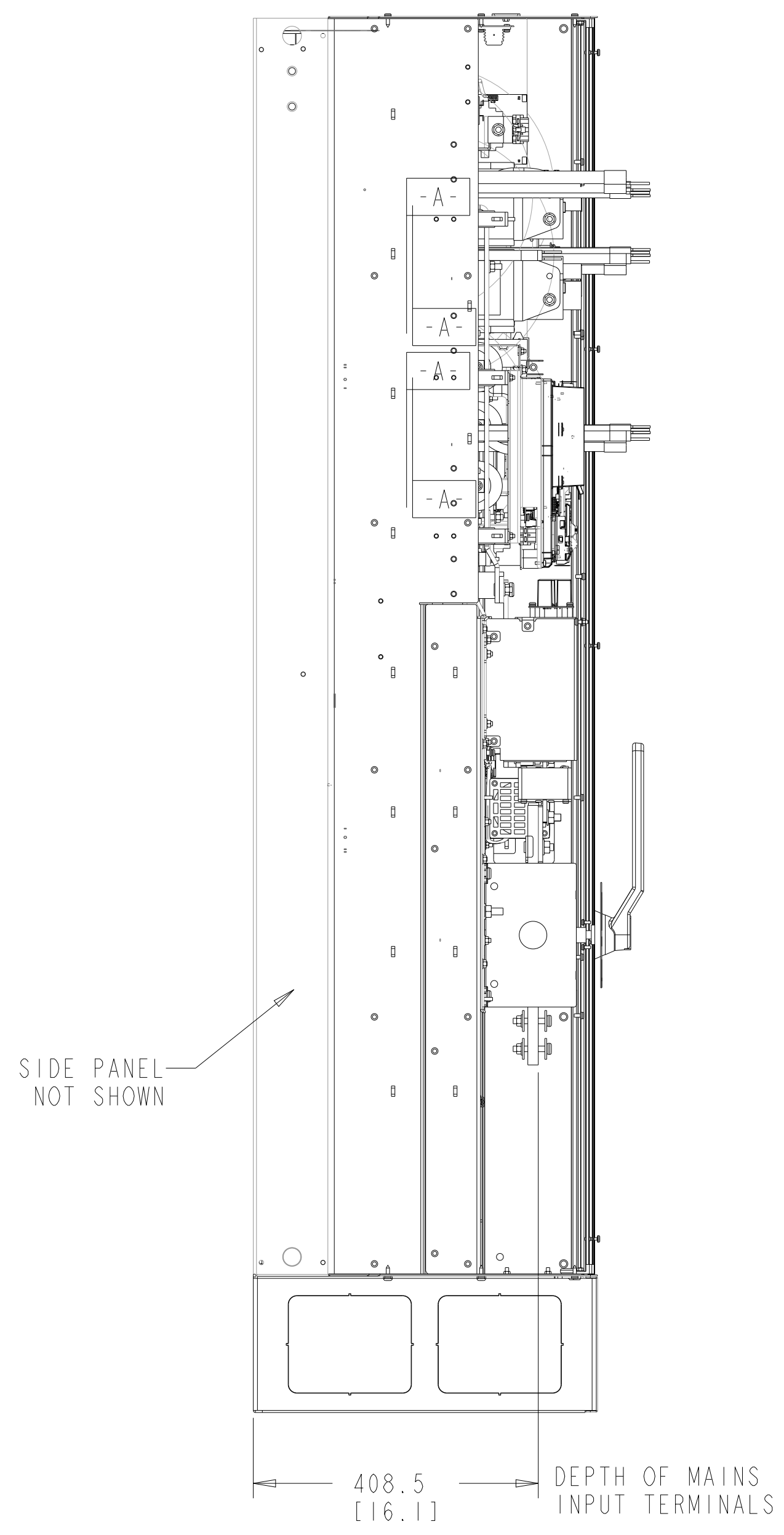

TITLE			
ASSY, LHD210, IP54, FUSE, RF I			
SIZE	MODEL	REV	
D	LHD210-IP54-V5	004	
SCALE	DRAWING NO.	SHEET	
0.150	177R0352	3 OF 4	

8

7

6

5

4

3

2

1

WITHOUT DISCONNECT

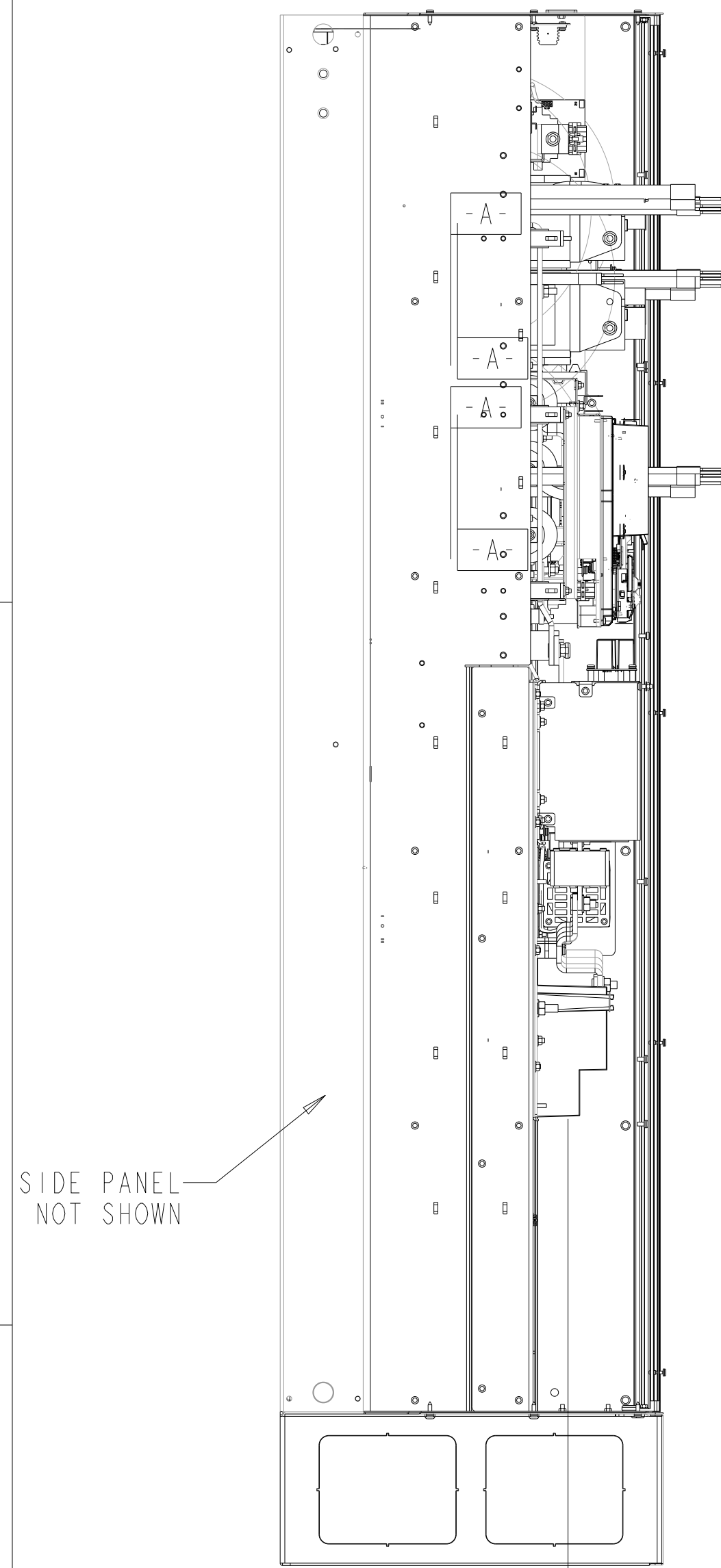

370.8 [14.6] DEPTH OF MAINS INPUT TERMINALS

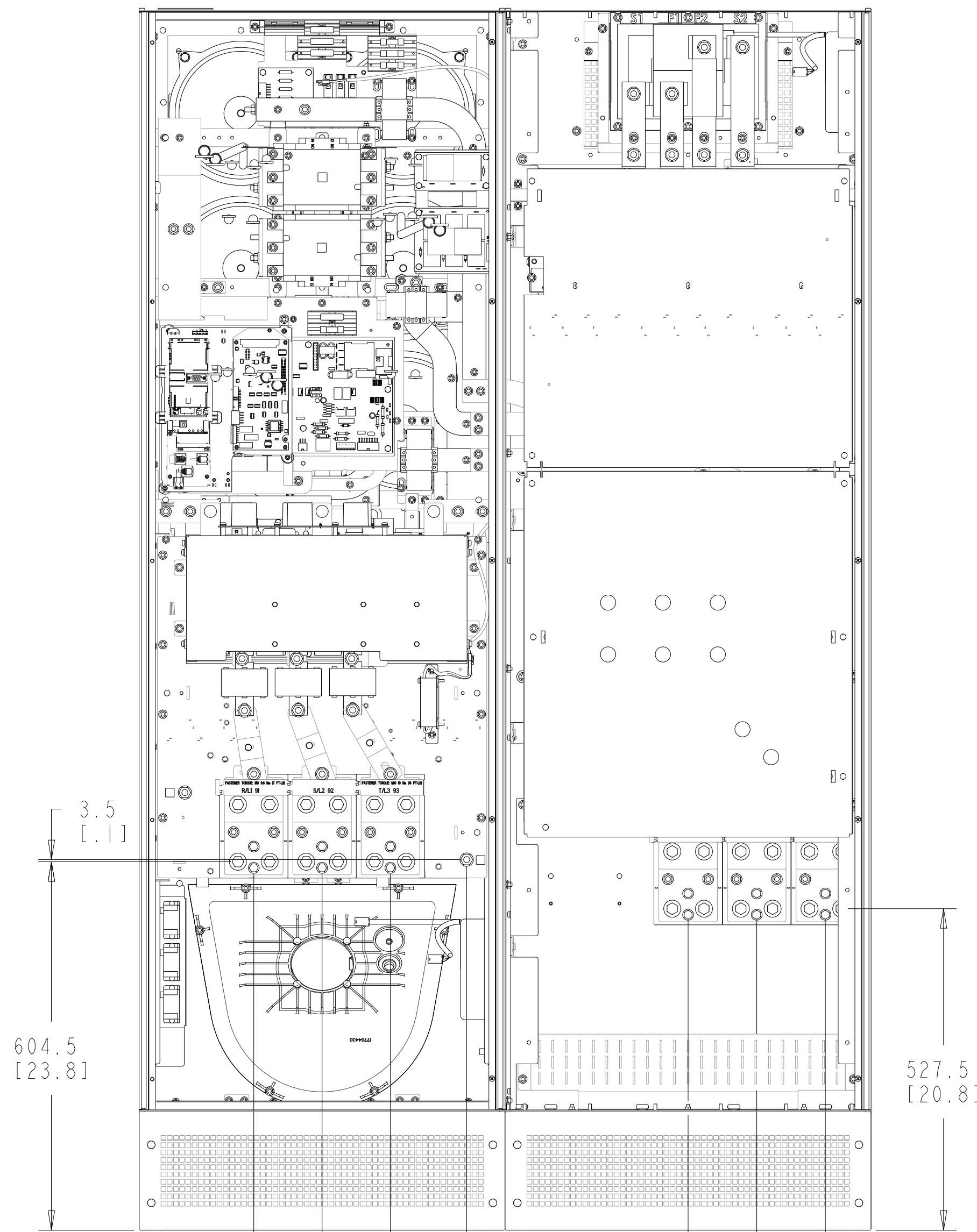

3.5 [1.1]
 604.5 [23.8]
 527.5 [20.8]
 112.0 [4.4]
 188.0 [7.4]
 224.0 [8.8]
 349.0 [13.7]
 900.0 [35.4]
 112.5 [4.4]
 225.0 [8.9]

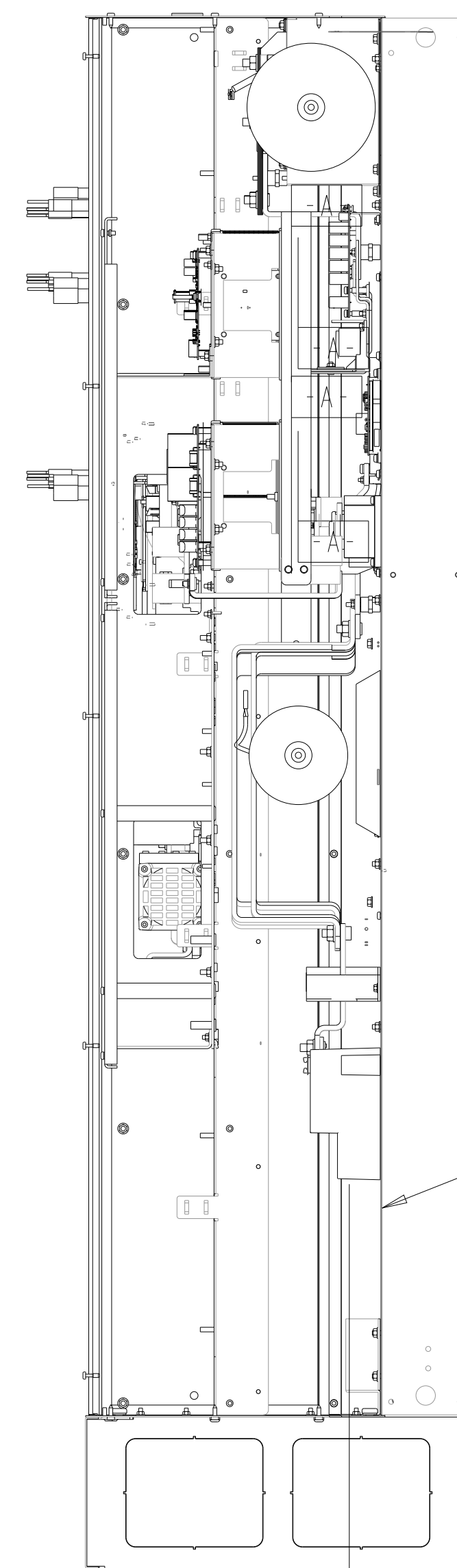

153.8 [6.1] DEPTH OF MOTOR OUTPUT TERMINALS

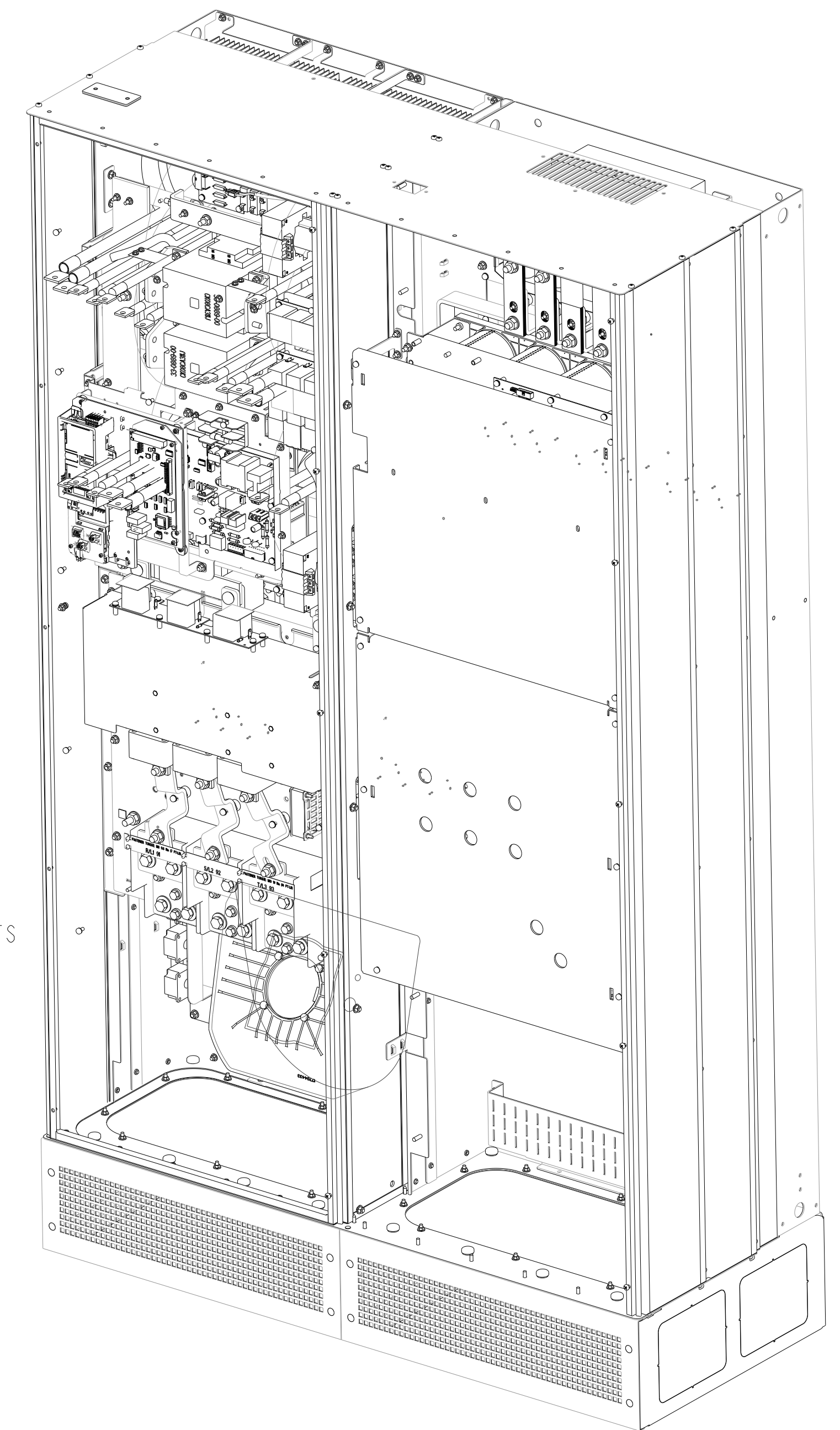

NOTES:
 COOLING:
 1) THE VLT FREQUENCY CONVERTER MUST BE INSTALLED VERTICALLY WITH THE MINIMUM INDICATED FREE SPACE ABOVE THE ENCLOSURE.
 2) ALL IP21/UL TYPE NEMA 1 AND IP54/UL TYPE NEMA 12 UNITS MAY BE MOUNTED SIDE BY SIDE WITH NO MINIMUM CLEARANCE.
 3) FAILURE TO REINSTALL THE CABINET FLOOR GLAND PLATES WILL HAVE A NEGATIVE INFLUENCE ON THE INTERNAL COOLING CAPACITY OF THE UNIT AND MAY CAUSE TRIP FAULTS.
 4) STANDARD COOLING CONFIGURATION IS WITH THE INTAKE THROUGH THE BASE CABLE PLINTH AND EXHAUST OUT THE TOP OF THE ENCLOSURE. THE DOORS ARE ALSO EQUIPPED WITH FANS TO PROVIDE COOLING FOR THE CABINET.

BACK WALL COOLING:
 OPTIONAL BACK WALL COOLING CONFIGURATION IS WITH THE INTAKE THROUGH THE LOWER REAR OF THE CABINET. THE EXHAUST IS EITHER OUT THE UPPER REAR FOR THE DRIVE OR OUT THE TOP OF THE ENCLOSURE FOR THE FILTER. (CONSULT THE FACTORY WHEN PLACING UNITS NEXT TO EACH OTHER IN THIS CONFIGURATION).

WALL MOUNTING:
 THE DRIVE IS NOT INTENDED TO BE WALL MOUNTED. IF THE UNIT IS SECURED TO THE WALL, THE BOTTOM OF THE UNIT MUST BE SUPPORTED BY THE FLOOR USING THE ATTACHED PLINTH OR OTHER FACTORY APPROVED MEANS.

LIFTING:
 THE DRIVE IS INTENDED TO BE LIFTED USING THE HOLES IN THE SIDES OF THE BACKCHANNEL. THERE ARE THREE HOLES, ONE EACH ON THE OUTSIDE AND ONE AT THE CENTER WHERE THE DRIVE AND FILTER ARE CONNECTED.

RATING:
 IP21/ IP54 AND NEMA 1 AND NEMA 12

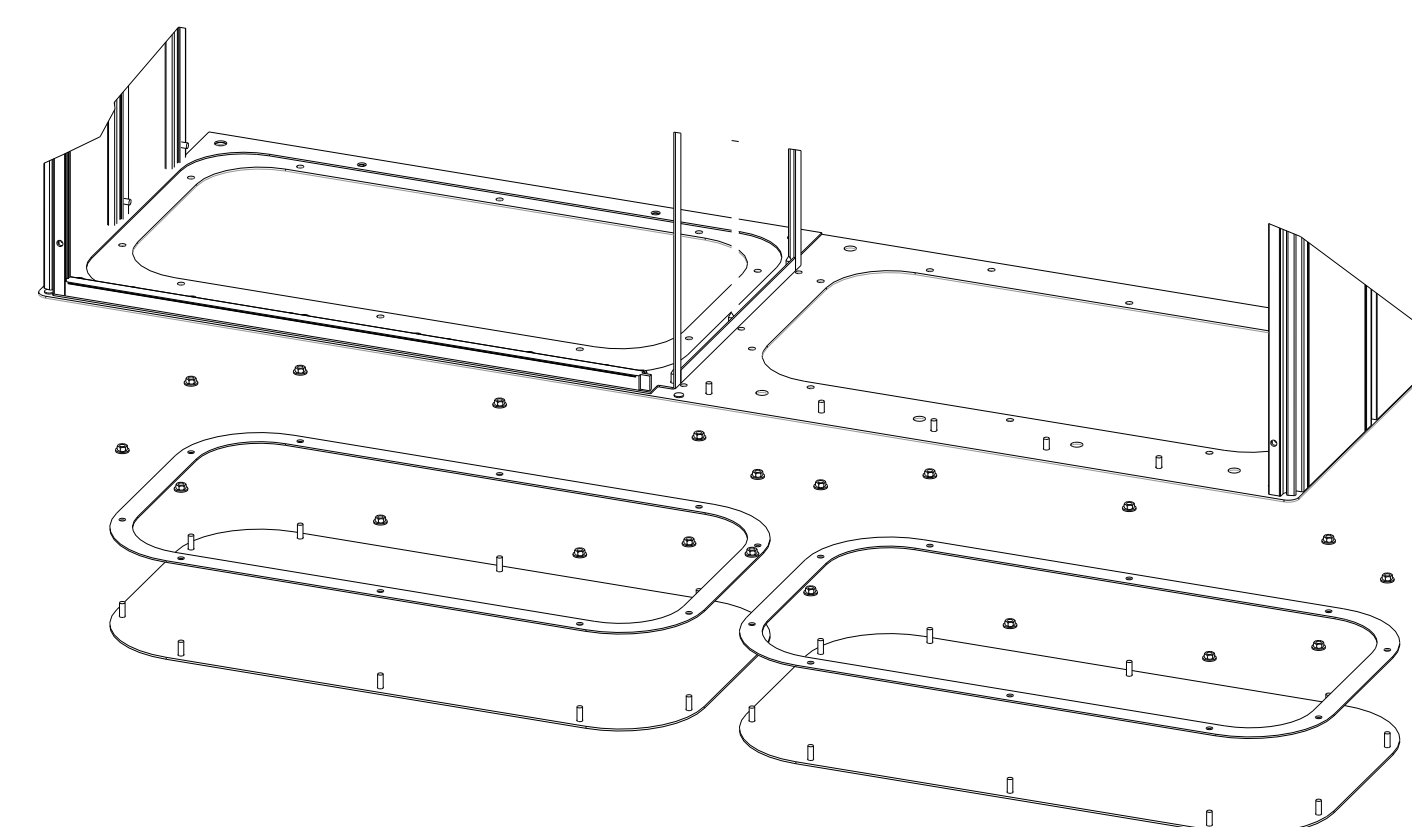

TITLE			
ASSY, LHD210, IP54, FUSE, RF I			
SIZE	MODEL	REV	
D	LHD210-IP54-V5	004	
SCALE	DRAWING NO.	SHEET	
0.150	177R0352	4 OF 4	