

■ External 24 V DC Supply

You can use the external 24 V DC supply as low-voltage supply to the control card or any option card installed.

This enables full operation of the LCP (including the parameter setting) without connection to mains.

External 24 V DC supply specification	
Input voltage range:	24V DC \pm 15% (max. 37 V in 10 s)
Max. input current:	2.2 A
Max. cable length:	75 m
Input capacitance load:	\leq 110 μ F
Power-up delay:	\leq 0.6 s

■ 24 V Back-Up Option

Terminal numbers:

Terminal 35: - external 24 V DC supply.

Terminal 36: + external 24 V DC supply.

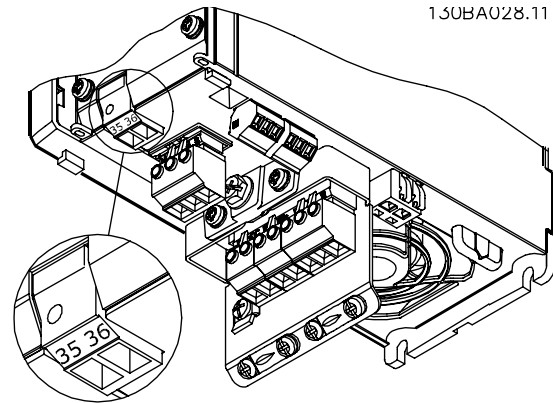

Connection to 24 V back-up supplier.

