

External 24 V DC Supply

You can use the external 24 VDC supply a slow-voltage supply to the control card or any option card installed. This enables full operation of the LCP (including the parameter setting) without connection to line power.

External 24 V DC supply specification	
Input voltage range:	24V DC $\pm 15\%$ (max. 37 V in 10 s)
Max. input current:	2.2 A
Max. cable length:	246 ft [75 m]
Input capacitance load:	$\leq 110 \mu\text{F}$
Power-up delay:	$\leq 0.6 \text{ s}$

24 V Backup Option

Terminal numbers:

Terminal 35: - external 24 DC supply.

Terminal 36: +external 24 VDC supply.

130BAU28.11

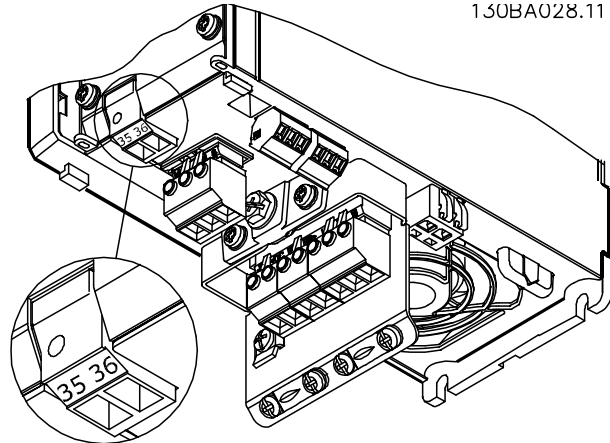

Connection to 24 V back-up supplier.

