

**VACON<sup>®</sup> NX**  
AC DRIVES

**MOUNTING OF CABLE ACCESSORIES  
FR4-FR8 AND MF4-MF6**

**VACON<sup>®</sup>**



## TABLE OF CONTENTS

Document ID: DPD01422C

Document revision: C

Release date: 15.12.2017

<b>1. FR4-FR6 and MF4-MF6 cable accessories .....</b>	<b>4</b>
1.1 Accessories bag contents .....	4
1.2 Mounting the accessories .....	5
<b>2. FR7 and FR8 cable accessories .....</b>	<b>7</b>
2.1 Accessories bag contents .....	7
2.2 Mounting the accessories .....	8

## 1. FR4-FR6 AND MF4-MF6 CABLE ACCESSORIES

Enclosed to your VACON® NX or NXL AC drive you have received a plastic bag containing components that are needed for the installation of the mains and motor cables in the AC drive.

### 1.1 ACCESSORIES BAG CONTENTS

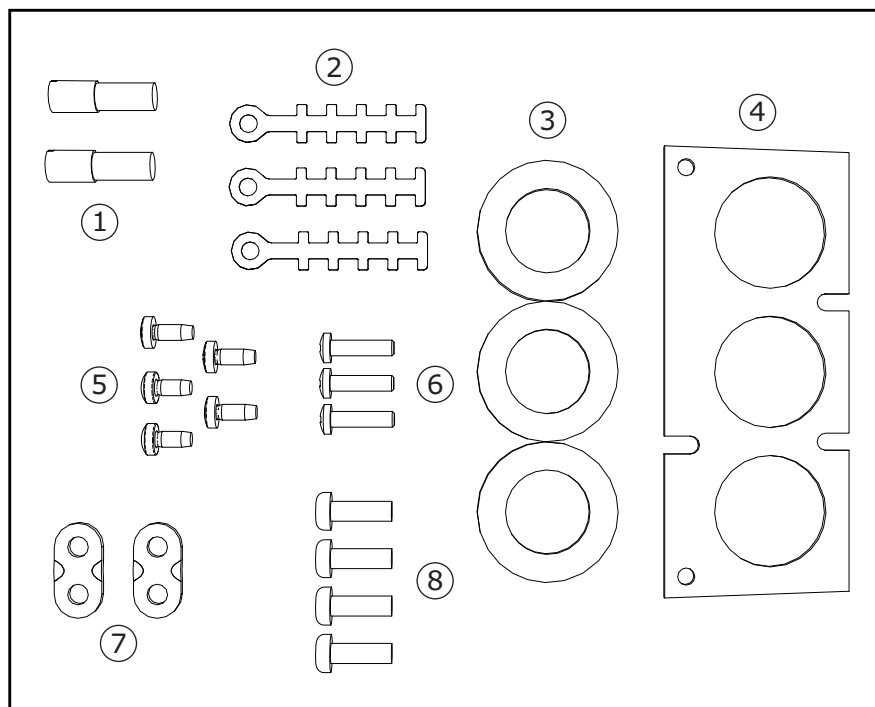

Figure 1. The cable accessories for FR4-FR6 and MF4-MF6

#### Components:

1. The grounding terminals (FR4, FR5/MF4, MF5), 2 pieces
2. The grounding clamps for control cable, 3 pieces
3. The rubber grommets (sizes vary from class to class), 3 pieces
4. The cable entry flange
5. Screws, M4x10, 5 pieces
6. Screws, M4x16, 3 pieces
7. The grounding clamps for grounding conductor (FR6, MF6), 2 pieces
8. The grounding screws M5x16 (FR6, MF6), 4 pieces

**NOTE!** The cable accessories installation kit for AC drives of protection class IP54 includes all components except 4 and 5.

## 1.2 MOUNTING THE ACCESSORIES

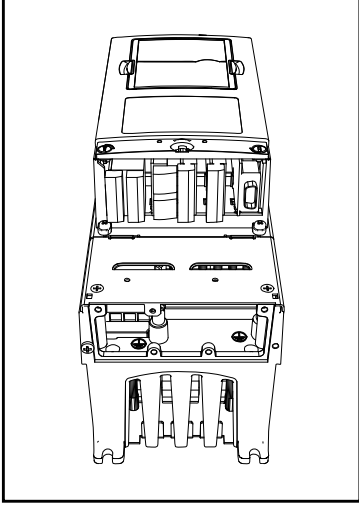
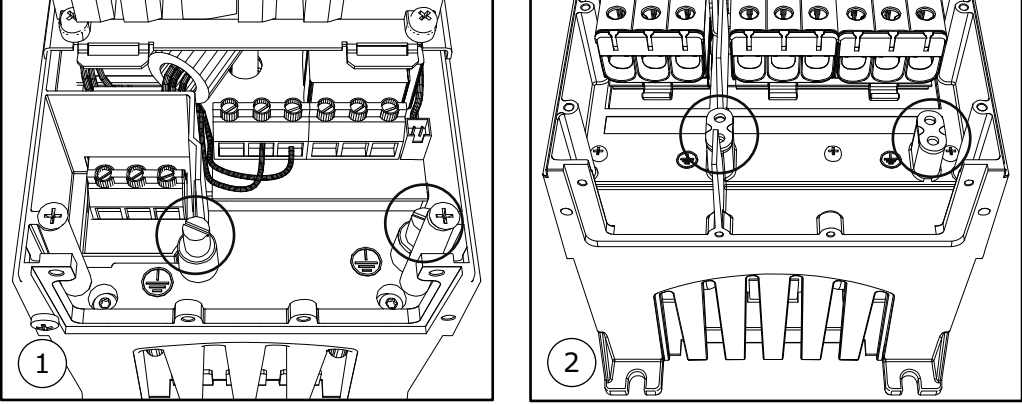
1	Make sure that the plastic bag you have received contains all necessary components.
2	<p>Open the cover of the AC drive.</p>  <p style="text-align: center;"><i>Figure 2.</i></p>
3	<p>Remove the cable cover. See the locations for:</p> <ol style="list-style-type: none"> <li>1. the grounding terminals (FR4/FR5; MF4/MF6).</li> <li>2. the grounding clamps for grounding conductor (FR6/MF6).</li> </ol>  <p style="text-align: center;"><i>Figure 3.</i></p>

4

Attach again the cable cover. Attach the grounding clamps for control cable with 3 pieces of M4x16 screws.

**NOTE!** The location of the grounding bar in FR6/MF6 is different from the picture.

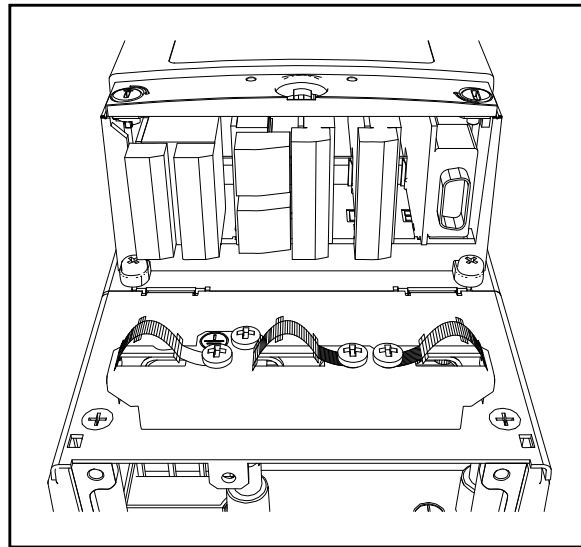

Figure 4.

5

Put the rubber grommets in the openings.

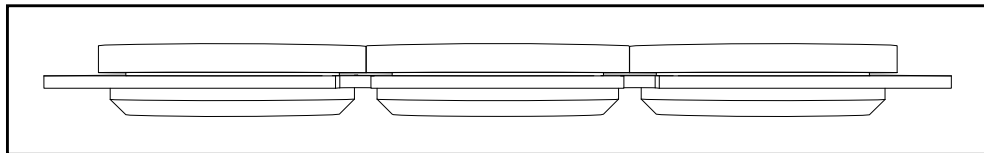

Figure 5.

6

Attach the cable entry flange to the frame of the AC drive with 5 pieces of M4x10 screws. Close the cover of the AC drive.

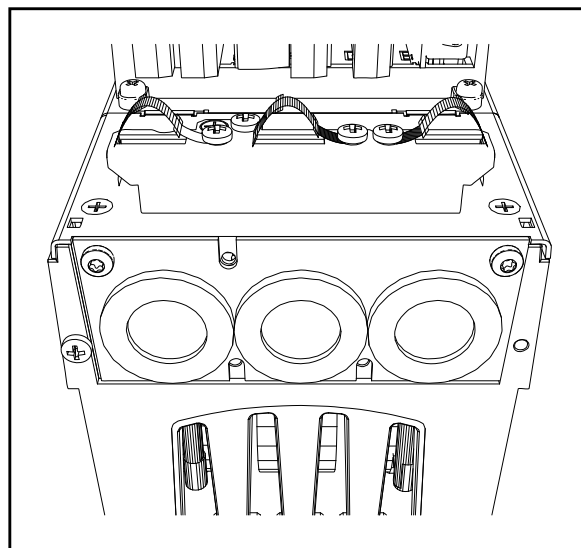

Figure 6.

## 2. FR7 AND FR8 CABLE ACCESSORIES

Enclosed to your VACON® NX AC drive you have received a plastic bag containing components that are needed for the installation of the mains and motor cables in the AC drive.

### 2.1 ACCESSORIES BAG CONTENTS

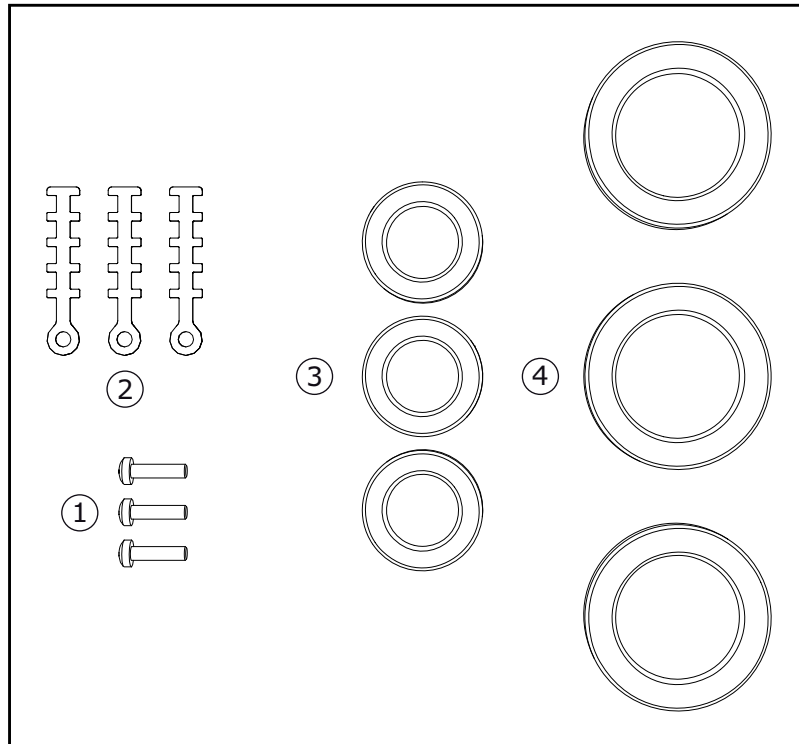

Figure 7. The cable accessories for FR7 and FR8

#### Components:

1. Screws, M4x16, 3 pieces
2. The grounding clamps for control cable, 3 pieces
3. The rubber grommets GD21 (FR7 IP54), 3 pieces / (FR8), 6 pieces
4. The rubber grommets GDM36 (FR7), 3 pieces

2.2 MOUNTING THE ACCESSORIES

<b>1</b>	Make sure that the plastic bag you have received contains all necessary components.
<b>2</b>	Open the cover of the AC drive.
<b>3</b>	<p>Attach the grounding clamps for control cable on the grounding level with M4x16 screws:</p> <ol style="list-style-type: none"> <li>1. FR7 standard,</li> <li>2. FR7 profibus,</li> <li>3. FR8 standard,</li> <li>4. FR8 profibus.</li> </ol> <div style="display: flex; justify-content: space-around; align-items: center;"> <div style="text-align: center;">  <p>1</p> </div> <div style="text-align: center;">  <p>2</p> </div> </div> <div style="display: flex; justify-content: space-around; align-items: center;"> <div style="text-align: center;">  <p>3</p> </div> <div style="text-align: center;">  <p>4</p> </div> </div>

Figure 8.



Put the rubber grommets in the openings:

1. FR7 IP21,
2. FR7 IP54,
3. FR8.

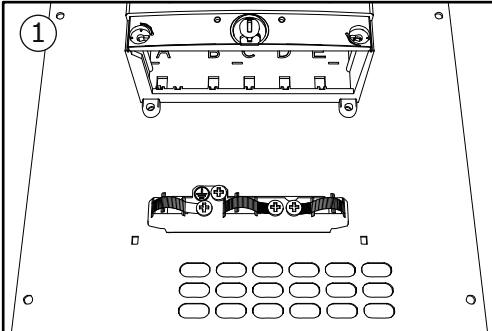
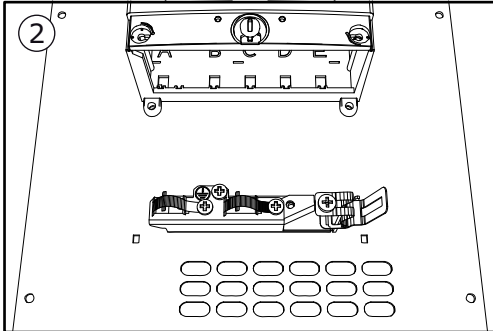
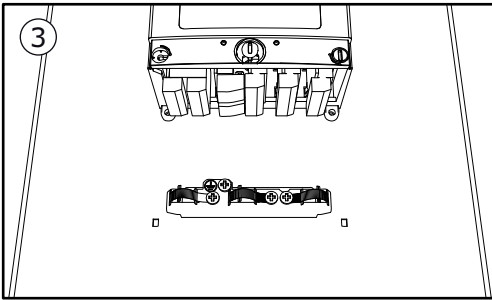
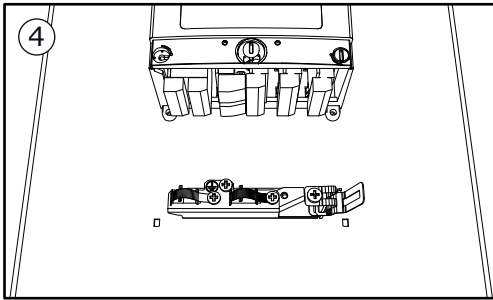
See also Figure 5 on page 6 for how to place the grommets correctly.

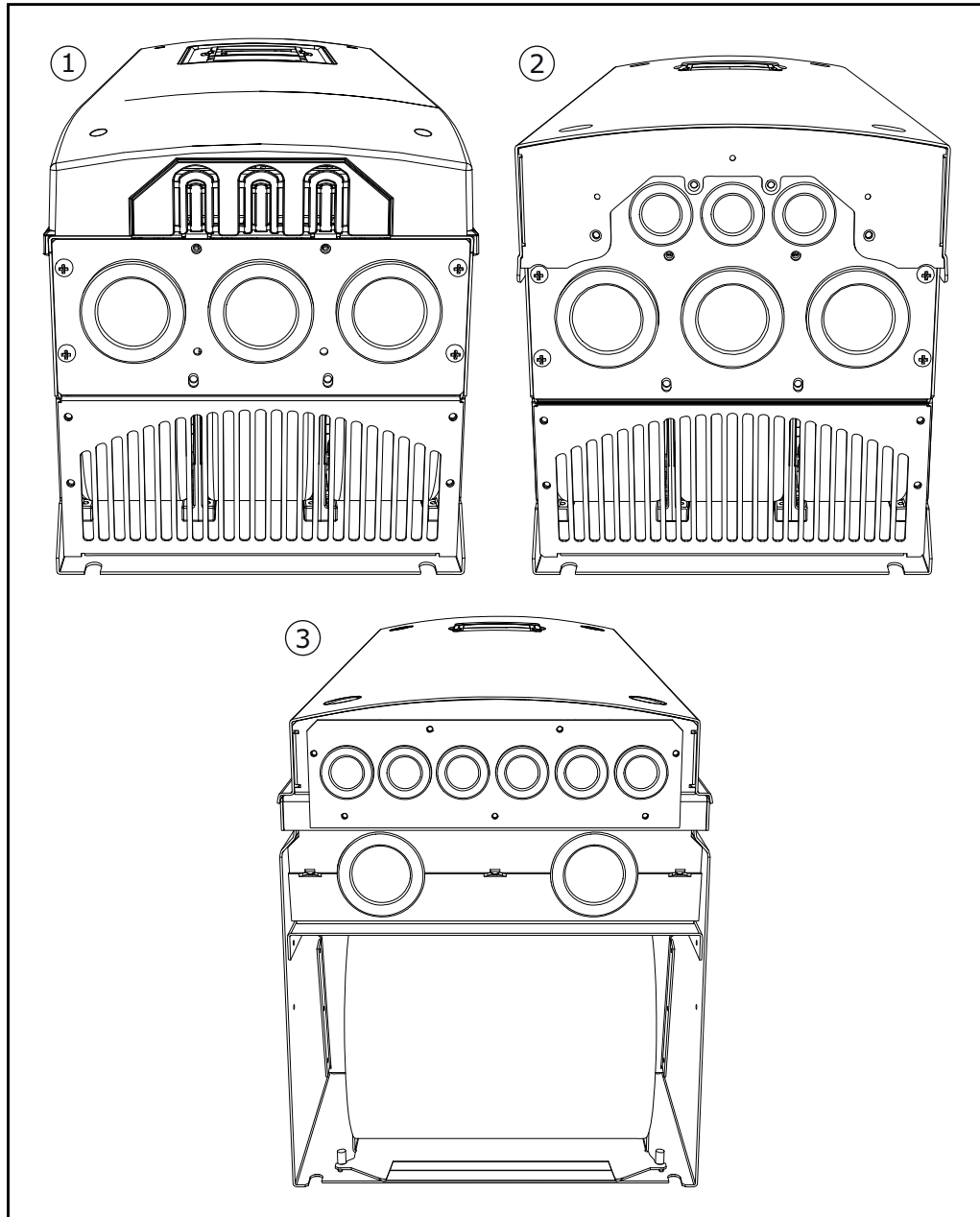

Figure 9.

**4**

**5** Close the cover of the AC drive.

# VACON®

[www.danfoss.com](http://www.danfoss.com)

Vacon Ltd  
Member of the Danfoss Group  
Runsorintie 7  
65380 Vaasa  
Finland

Document ID:



DPD01422C

Rev. C