

VACON[®] NX
AC DRIVES

**MOUNTING OF CABLE ACCESSORIES
FR4-FR8 AND MF4-MF6**

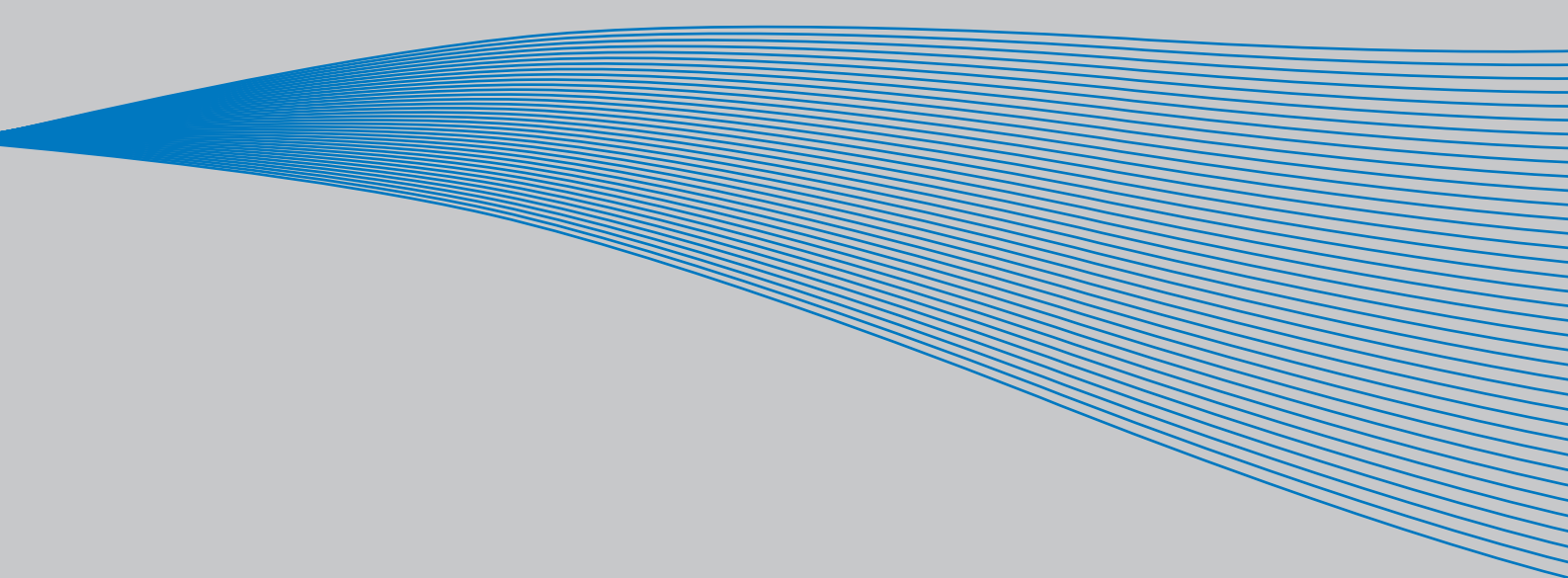

VACON[®]
DRIVEN BY DRIVES

TABLE OF CONTENTS

Document ID: DPD01422

Document revision: A

Release date: 12.08.2014

1. FR4-FR6 and MF4-MF6 cable accessories	2
1.1 Accessories bag contents	2
1.2 Mounting the accessories	3
2. FR7 and FR8 cable accessories	5
2.1 Accessories bag contents	5
2.2 Mounting the accessories	6

1. FR4-FR6 AND MF4-MF6 CABLE ACCESSORIES

Enclosed to your VACON® NX or NXL AC drive you have received a plastic bag containing components that are needed for the installation of the mains and motor cables in the AC drive.

1.1 ACCESSORIES BAG CONTENTS

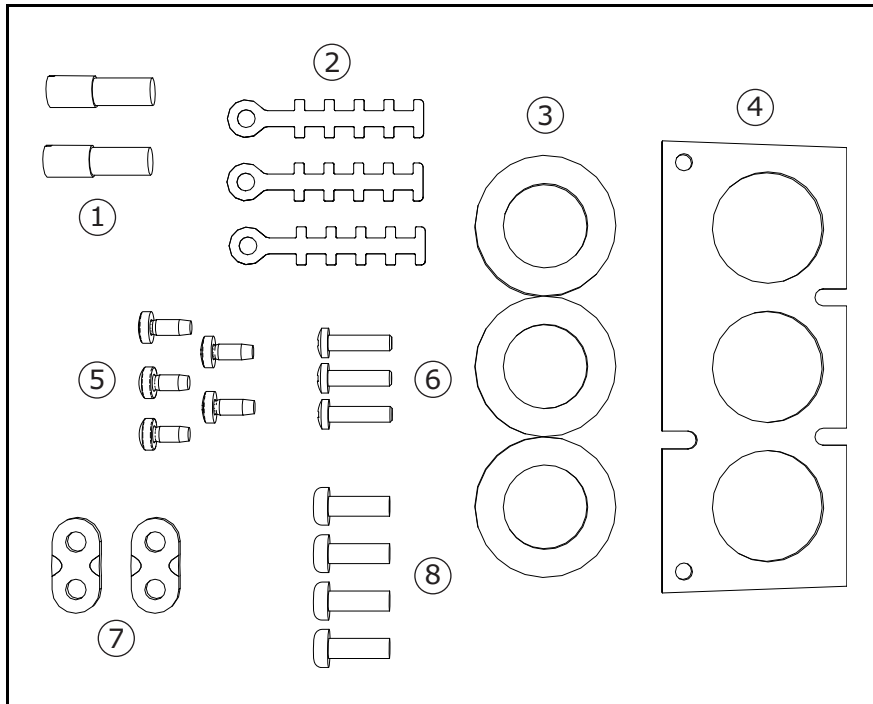

Figure 1. Cable accessories for FR4-FR6 and MF4-MF6

Components:

1. Grounding terminals (FR4, FR5/MF4, MF5), 2 pcs
2. Cable clamps, 3 pcs
3. Rubber grommets (sizes vary from class to class), 3 pcs
4. Cable entry flange
5. Screws, M4x10, 5 pcs
6. Screws, M4x16, 3 pcs
7. Grounding cable clamps (FR6, MF6), 2 pcs
8. Grounding screws M5x16 (FR6, MF6), 4 pcs

NOTE! The cable accessories installation kit for AC drives of protection class IP54 includes all components except 4 and 5.

1.2 MOUNTING THE ACCESSORIES

1	Make sure that the plastic bag you have received contains all necessary components.
2	<p>Open the cover of the AC drive.</p> <div data-bbox="692 392 1051 896" data-label="Image"> </div> <p style="text-align: center;"><i>Figure 2.</i></p>
3	<p>Remove the cable cover. Observe the places for:</p> <ol style="list-style-type: none"> 1. the grounding terminals (FR4/FR5; MF4/MF6). 2. the grounding cable clamps (FR6/MF6). <div data-bbox="359 1140 1386 1545" data-label="Image"> </div> <p style="text-align: center;"><i>Figure 3.</i></p>

4

Re-install the cable cover. Mount the cable clamps with the three M4x16 screws as shown in the picture. Note that the location of the grounding bar in FR6/MF6 is different from what is shown in the picture.

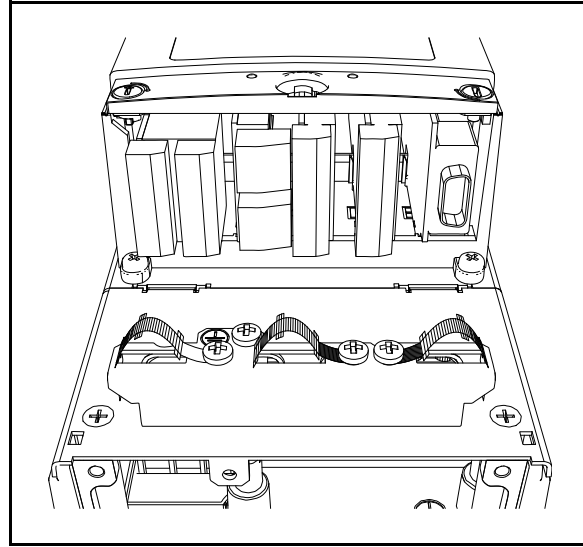

Figure 4.

5

Place the rubber grommets in the openings as shown in the picture.

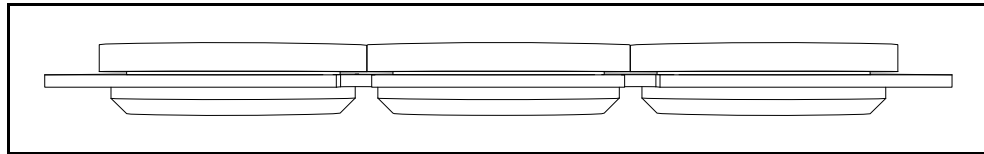

Figure 5.

6

Fix the cable entry flange to the frame of the AC drive with the five M4x10 screws. Close the cover of the AC drive.

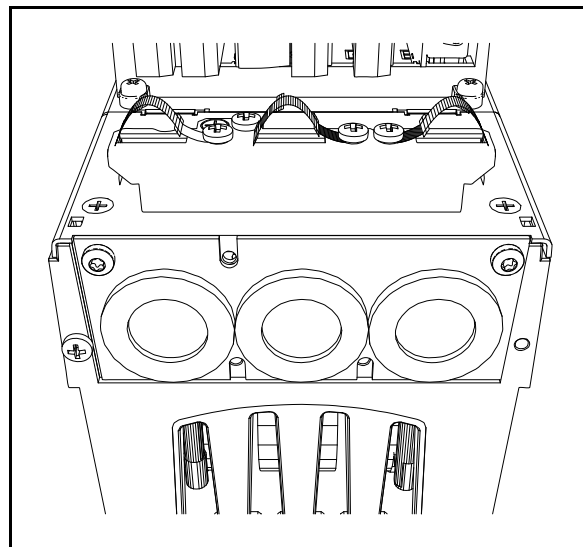

Figure 6.

2. FR7 AND FR8 CABLE ACCESSORIES

Enclosed to your VACON® NX AC drive you have received a plastic bag containing components that are needed for the installation of the mains and motor cables in the AC drive.

2.1 ACCESSORIES BAG CONTENTS

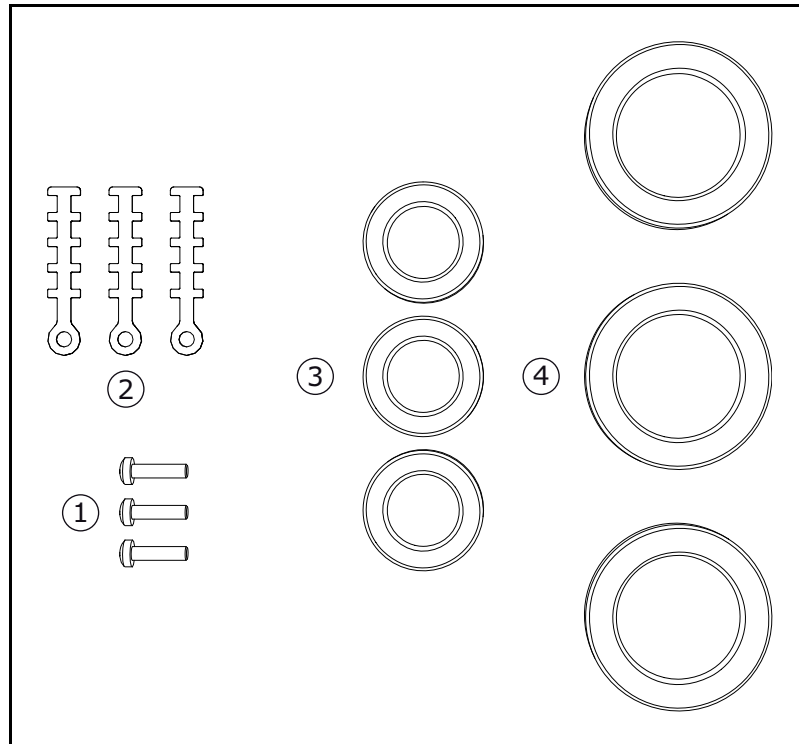

Figure 7. Cable accessories for FR7 and FR8

Components:

1. Screws, M4x16, 3 pcs
2. Cable clamps, 3 pcs
3. Rubber grommets GD21 (FR7 IP54), 3 pcs / (FR8), 6 pcs
4. Rubber grommets GDM36 (FR7), 3 pcs

2.2 MOUNTING THE ACCESSORIES

1	Make sure that the plastic bag you have received contains all necessary components.
2	Open the cover of the AC drive.
3	<p>Mount the cable clamps on the grounding level with M4x16 screws as shown in the figure:</p> <ol style="list-style-type: none"> 1. FR7 standard, 2. FR7 profibus, 3. FR8 standard, 4. FR8 profibus. <div style="display: flex; justify-content: space-around; align-items: center;"> <div style="text-align: center;">  <p>1</p> </div> <div style="text-align: center;">  <p>2</p> </div> </div> <div style="display: flex; justify-content: space-around; align-items: center; margin-top: 20px;"> <div style="text-align: center;">  <p>3</p> </div> <div style="text-align: center;">  <p>4</p> </div> </div>

Figure 8.

Place the rubber grommets in the openings as shown in the figure:

1. FR7 IP21,
2. FR7 IP54,
3. FR8.

See also Figure 5 on page 4 for how to place the grommets correctly.

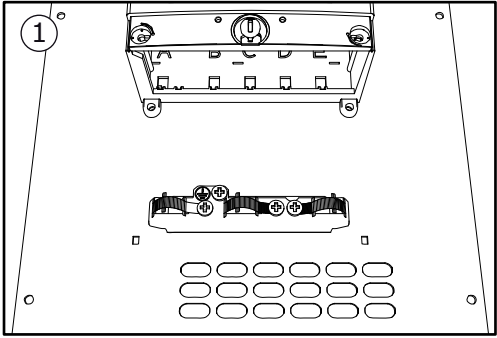
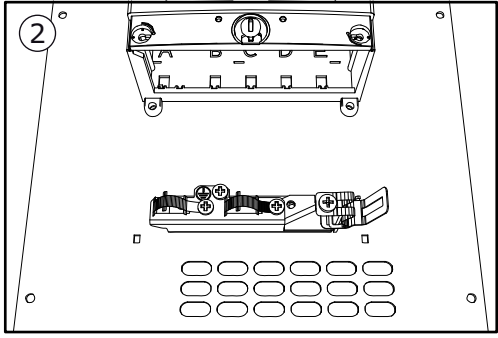
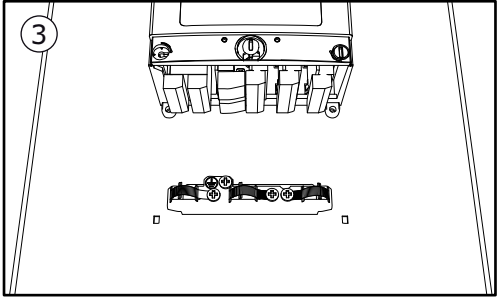
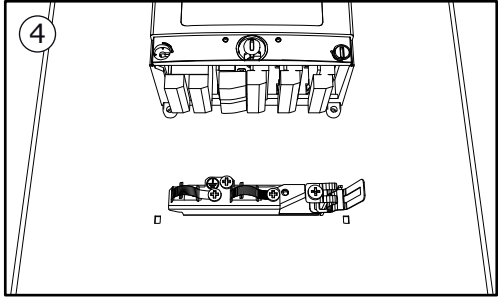
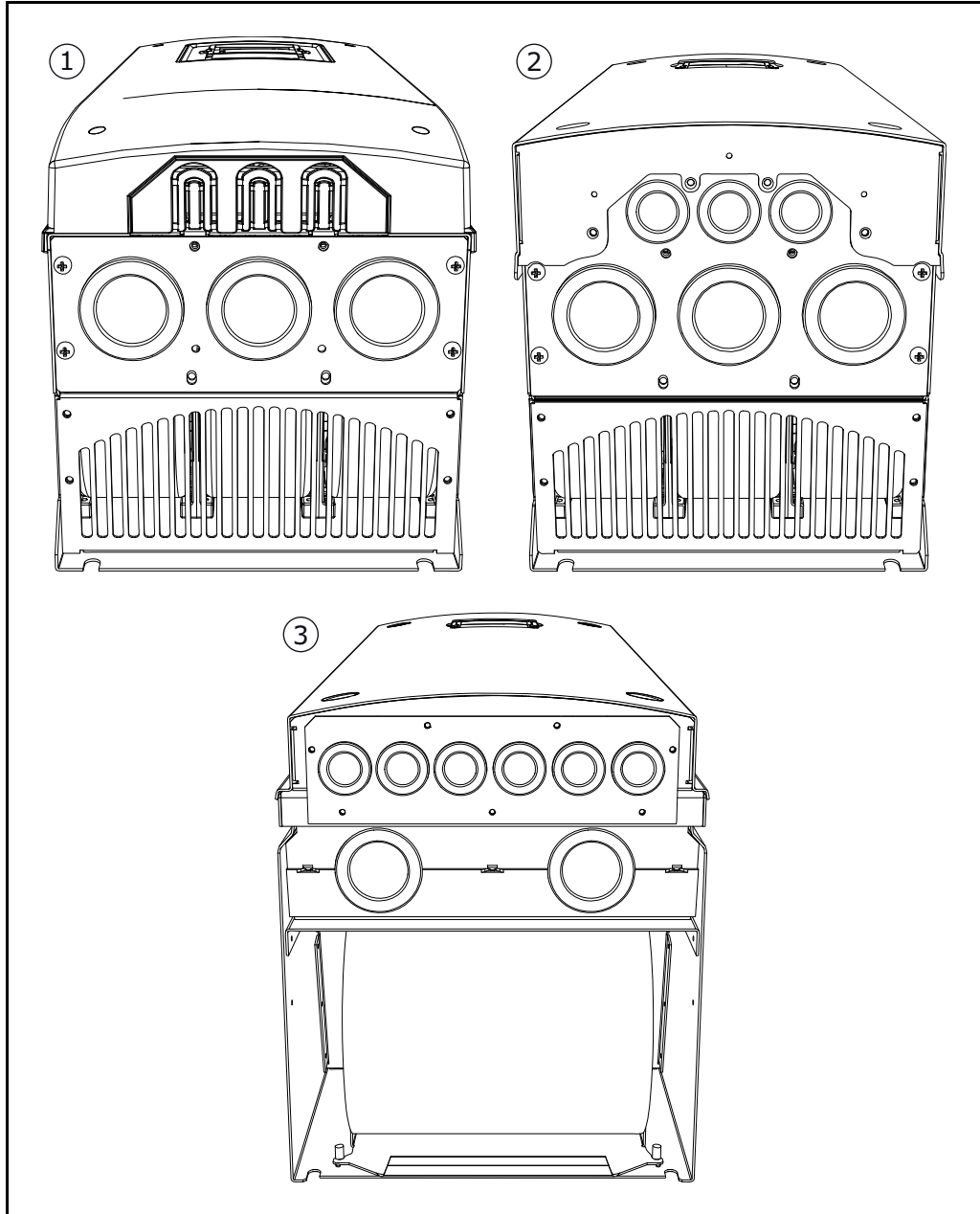

Figure 9.

4

5 Close the cover of the AC drive.

VACON[®]

DRIVEN BY DRIVES

Find your nearest Vacon office
on the Internet at:

www.vacon.com

Manual authoring:
documentation@vacon.com

Vacon Plc.
Runsorintie 7
65380 Vaasa
Finland

Subject to change without prior notice
© 2014 Vacon Plc.

Document ID:



D P D 0 1 4 2 2

Rev. A