

X7

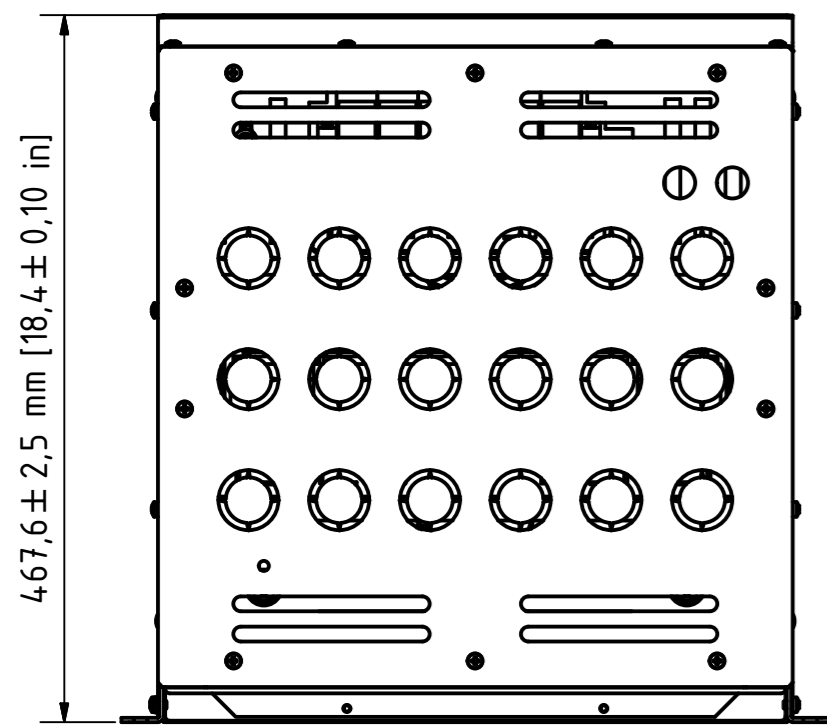

467,6 ± 2,5 mm [18,4 ± 0,10 in]

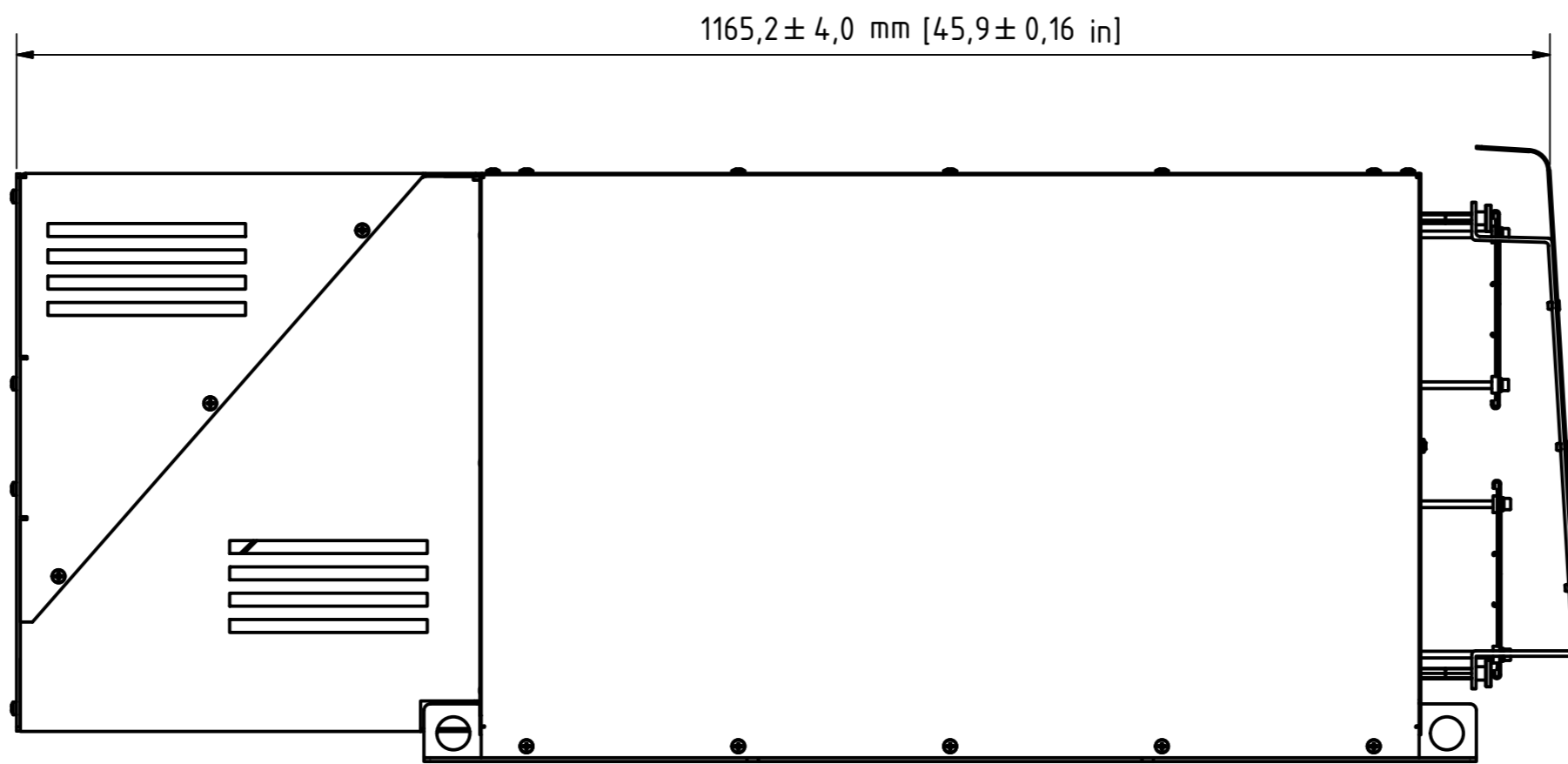

1165,2 ± 4,0 mm [45,9 ± 0,16 in]

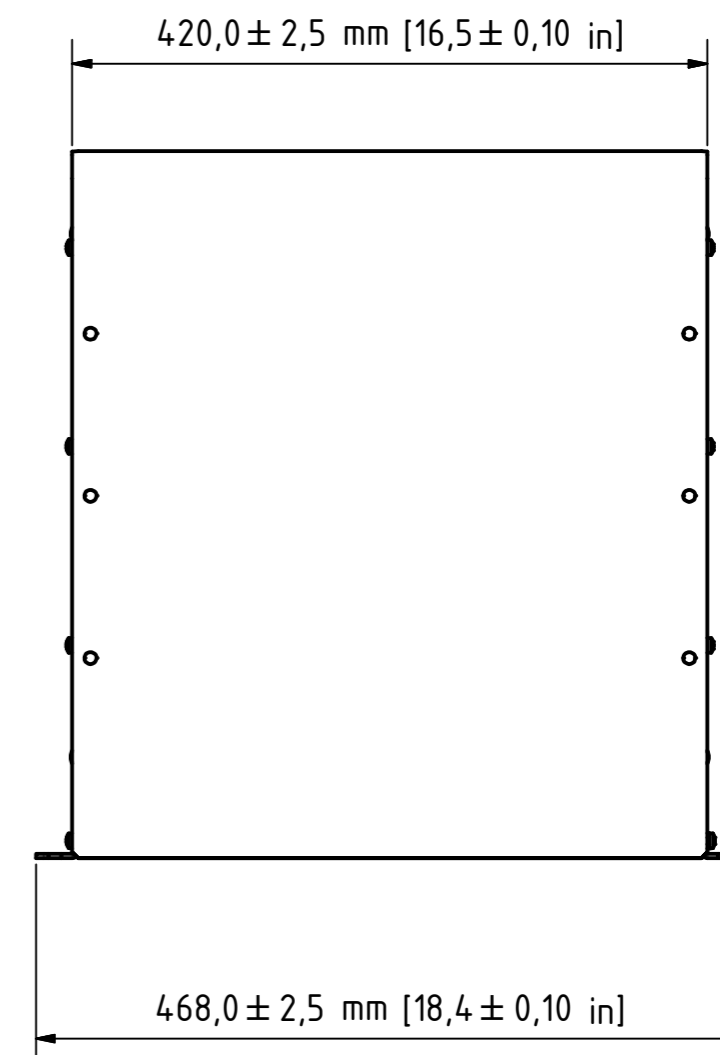

420,0 ± 2,5 mm [16,5 ± 0,10 in]

468,0 ± 2,5 mm [18,4 ± 0,10 in]

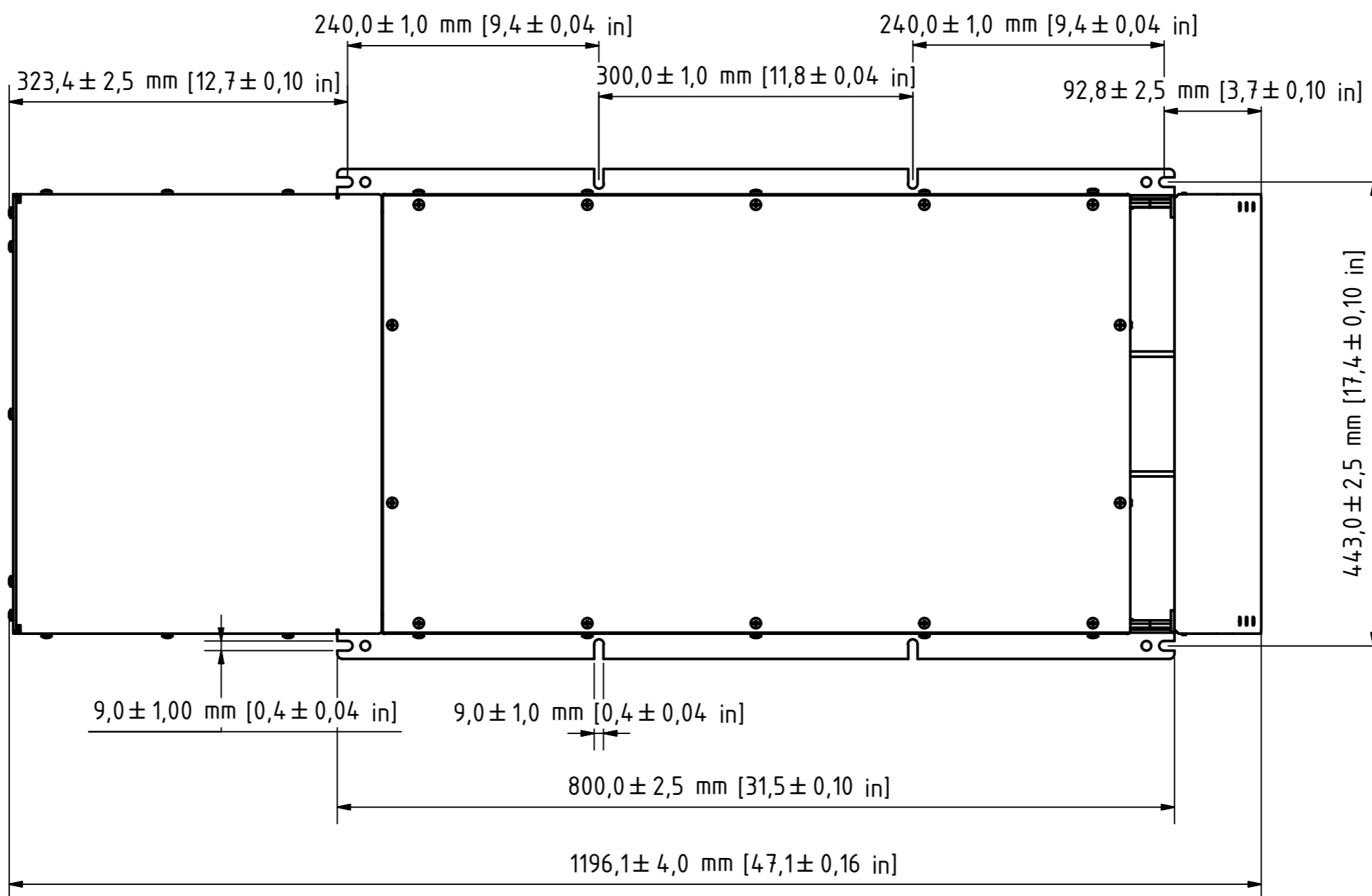

240,0 ± 1,0 mm [9,4 ± 0,04 in]

240,0 ± 1,0 mm [9,4 ± 0,04 in]

323,4 ± 2,5 mm [12,7 ± 0,10 in]

300,0 ± 1,0 mm [11,8 ± 0,04 in]

92,8 ± 2,5 mm [3,7 ± 0,10 in]

443,0 ± 2,5 mm [17,4 ± 0,10 in]

9,0 ± 1,00 mm [0,4 ± 0,04 in]

9,0 ± 1,0 mm [0,4 ± 0,04 in]

800,0 ± 2,5 mm [31,5 ± 0,10 in]

1196,1 ± 4,0 mm [47,1 ± 0,16 in]

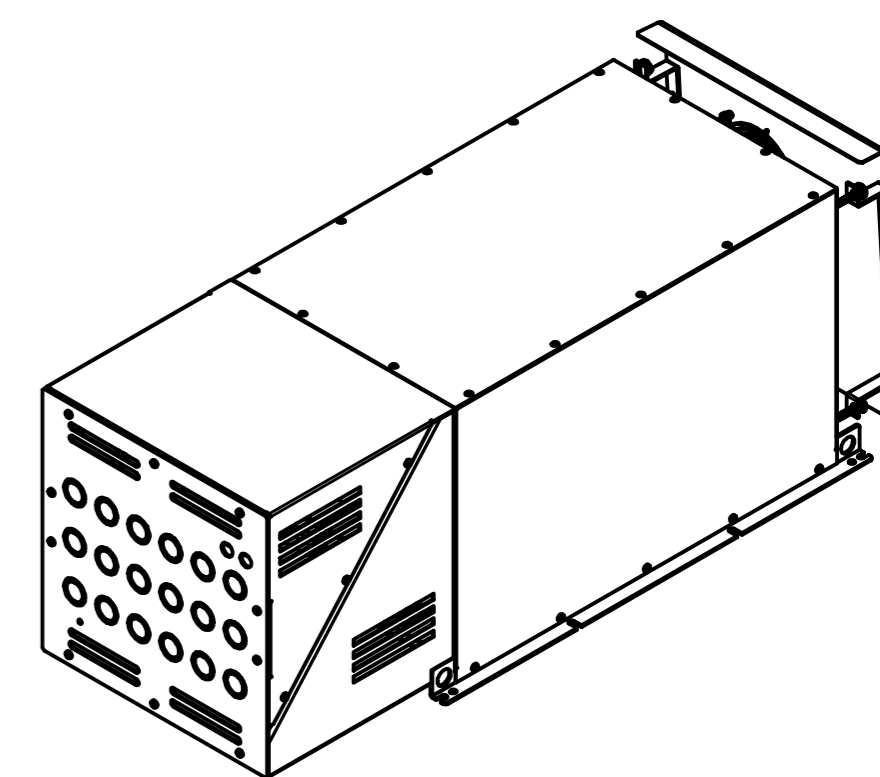

| | | | | | |
|---------------|---------------|------|------|---|--|
| DATE | | Name | | Designation | |
| Drawn | 14.02.2014 | FR | | AHF drawing X7 IP21 with external fan | |
| Reviewed | 28.08.2014 | Mk | | | |
| Standard | DIN 2768-1 V | | | | |
| Scale drawing | 1:1 | | | | |
| Print scale | Approx. 1:5 | | | Drawing Number | |
| | | | | X7 IP21 ef1 | |
| | | | | 1 | |
| | | | | A2 | |
| Status | Modifications | DATE | Name | P:\18_P82\102_Entwicklung\03_30 CAD_Baufreizechnungen\03_Brecherei\03_Überschwingungfilter\Gehäuse\X7 | |